



Guide Ball Bushing/Linear Bushing

THK General Catalog

Guide Ball Bushing/Linear Bushing

THK General Catalog

A Product Descriptions

Features and Types	A4-4
Features of the Guide Ball Bushing	A4-4
• Structure and Features	A4-4
• Examples of Changing the Linear Bushing to the Guide Ball Bushing ..	A4-6
Types of the Guide Ball Bushing	A4-7
• Types and Features	A4-7
Point of Selection	A4-8
Flowchart for Selecting a Guide Ball Bushing ..	A4-8
• Steps for Selecting a Guide Ball Bushing ..	A4-8
Rated Load and Nominal Life	A4-9
Table of Equivalent Factors	A4-12
Precautions To Be Taken if an Eccentric Load Is Applied ..	A4-12
Accuracy Standards	A4-13
Dimensional Drawing, Dimensional Table	
Model LG	A4-14
Point of Design	A4-16
Assembling the Guide Ball Bushing	A4-16
Options	A4-19
Lubrication	A4-19
Dust prevention	A4-19
Model No.	A4-20
• Model Number Coding	A4-20
Precautions on Use	A4-21
Features and Types	A4-23
Features of the Linear Bushing	A4-23
• Structure and Features	A4-23
Types of the Linear Ball Bushing	A4-25
• Types and Features	A4-25
Classification Table	A4-32
Point of Selection	A4-34
Flowchart for Selecting a Linear Bushing ..	A4-34
• Steps for Selecting a Linear Bushing	A4-34
Rated Load and Nominal Life	A4-35
Table of Equivalent Factors	A4-38
Precautions To Be Taken if an Eccentric Load Is Applied ..	A4-38
Accuracy Standards	A4-39
Dimensional Drawing, Dimensional Table	
Model LM	A4-40
Model LM-GA (Metal Retainer Type)	A4-42
Model LM-MG (Stainless Steel Type)	A4-44

Model LME	A4-46
Model LM-L	A4-48
Model LMF	A4-50
Model LMF-M (Stainless Steel Type)	A4-52
Model LMK	A4-54
Model LMK-M (Stainless Steel Type)	A4-56
Model LMF-L	A4-58
Model LMF-ML (Stainless Steel Type) ..	A4-60
Model LMK-L	A4-62
Model LMK-ML (Stainless Steel Type) ..	A4-64
Model LMH	A4-66
Model LMH-L	A4-68
Models SC6 to 30	A4-70
Models SC35 to 50	A4-72
Model SL	A4-74
Model SH	A4-76
Model SH-L	A4-78
Model SK	A4-80
• Dedicated Shafts for Model LM	A4-81
• Standard LM Shafts	A4-82
• Specially Machined Types	A4-83
• Table of Rows of Balls and Masses for Clearance-adjustable Types and Open Types of the Linear Bushing	A4-83
Point of Design	A4-84
Assembling the Linear Bushing	A4-84
Options	A4-91
Lubrication	A4-91
Material and Surface Treatment	A4-91
Dust prevention	A4-92
Felt Seal Model FLM	A4-92
Model No.	A4-93
• Model Number Coding	A4-93
• Notes on Ordering	A4-94
Precautions on Use	A4-95

B Support Book (Separate)

Features and Types	B4-4
Features of the Guide Ball Bushing	B4-4
• Structure and Features	B4-4
• Examples of Changing the Linear Bushing to the Guide Ball Bushing ..	B4-6
Types of the Guide Ball Bushing	B4-7
• Types and Features	B4-7
Point of Selection	B4-8
Flowchart for Selecting a Guide Ball Bushing ..	B4-8
• Steps for Selecting a Guide Ball Bushing ..	B4-8
Rated Load and Nominal Life	B4-9
Precautions To Be Taken if an Eccentric Load Is Applied ..	B4-12
Mounting Procedure and Maintenance ..	B4-13
Assembling the Guide Ball Bushing	B4-13
Options	B4-16
Dust prevention	B4-16
Model No.	B4-17
• Model Number Coding	B4-17
Precautions on Use	B4-18
Features and Types	B4-20
Features of the Linear Bushing	B4-20
• Structure and Features	B4-20
Types of the Linear Ball Bushing	B4-22
• Types and Features	B4-22
Classification Table	B4-28
Point of Selection	B4-30
Flowchart for Selecting a Linear Bushing ..	B4-30
• Steps for Selecting a Linear Bushing	B4-30
Rated Load and Nominal Life	B4-31
Precautions To Be Taken if an Eccentric Load Is Applied ..	B4-34
Mounting Procedure and Maintenance ..	B4-35
Assembling the Linear Bushing	B4-35
Lubrication	B4-41
Options	B4-42
Material and Surface Treatment	B4-42
Dust prevention	B4-43
Felt Seal Model FLM	B4-43
Model No.	B4-44
• Model Number Coding	B4-44
• Notes on Ordering	B4-45

Precautions on Use	B4-46
---------------------------------	-------

Features of the Guide Ball Bushing

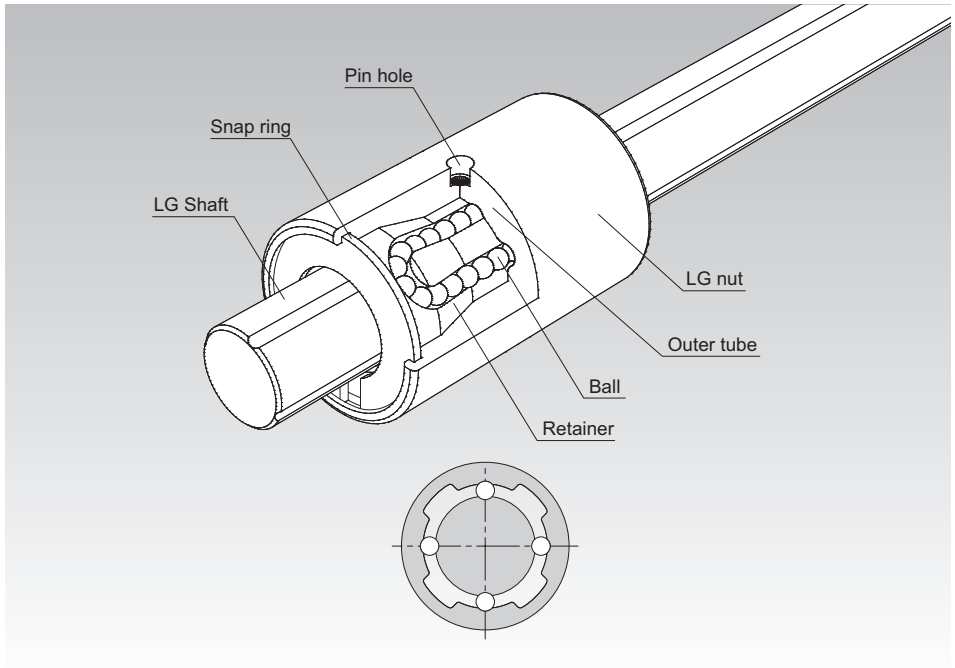

Fig.1 Structure of the Guide Ball Bushing model LG

Structure and Features

Since model LG has 4 rows of circular arc grooves (raceways), it does not need a mechanism to prevent the outer tube from rotating. In addition, its load rating is much larger than Linear Bushing model LM with the same dimensions. Therefore, replacing the Linear Bushing with the Guide Ball Bushing will reduce the size and cost of the guide unit and extend the service life.

[Higher Load Rating than the Linear Bushing]

Since model LG ensures an R contact through the use of circular arc grooves for ball contact, it achieves a load rating more than twice that of point-contact Linear Bushing model LM with the same size.

[A Rotation Stopper is Unnecessary Because of Raceways]

Since model LG has circular arc grooves, it does not need a rotation stopper required for Linear Bushing model LM, and allows the machine design to be compact.

[Interchangeable in Dimensions with Linear Bushing Model LM]

Since the outer tube of model LG has the same outer diameter and length as that of Linear Bushing model, LM, it is possible to replace Linear Bushing model LM with Guide Ball Bushing model LG as assemblies.

[Various Combinations of Nut and Shaft are Available (Any Combination is Allowed)]

As with the Linear Bushing, any combination of the LG nut and the LG shaft of model LG is allowed.

Examples of Changing the Linear Bushing to the Guide Ball Bushing

[Advantage of using the Guide Ball Bushing 1: Longer service life]

Since model LG has a rated load more than 2.4 times the Linear Bushing with the same dimensions, replacing the Linear Bushing with model LG will increase the service life by more than 13.8 times.

Table1 Comparison of the service life between Guide Ball Bushing mode LG and Linear Bushing model LM

Model No.	Basic dynamic load rating: C [N]	Load rating ratio	Service life ratio
LG4S	335	3.8 times	54.8 times
LM4	88.2		
LG6S	494	2.4 times	13.8 times
LM6	206		
LG8S	796	3.0 times	27.0 times
LM8	265		

[Advantage of using the Guide Ball Bushing 2: Smaller machine size]

Since the Linear Bushing is not suitable for applications where a load in the rotational direction is applied, it is necessary to use two or more Linear Bushing units in parallel or have a rotation stopper mechanism even under conditions where a torque is not applied. In contrast, the Guide Ball Bushing, which has a structure containing four rows of circular arc grooves, is operable with a single shaft and therefore contributes to downsizing the machine, unless an excessive load is applied.

Achieves a load carrying capacity approximately three times the Linear Bushing in a half space

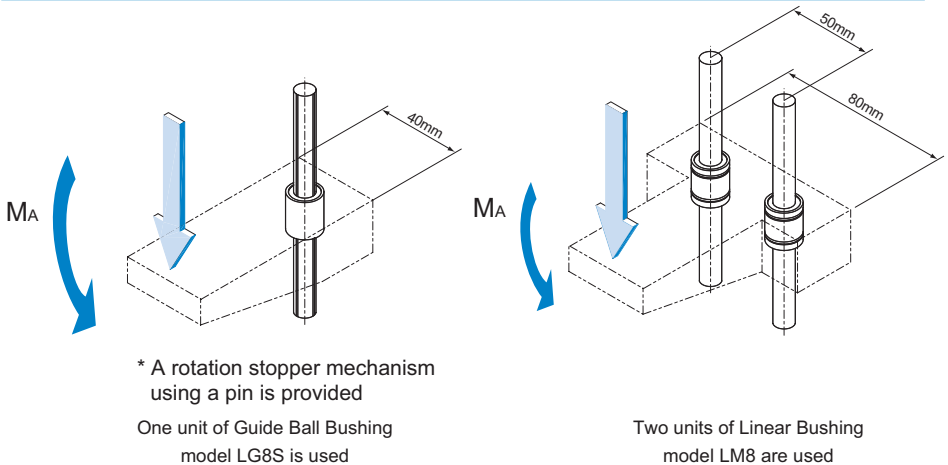

Table2 Comparison of the permissible moment between Guide Ball Bushing mode LG and Linear Bushing model LM

Model No.	Permissible moment: M_A [N·m]
One unit of LG8S is used	1.46
Two units of LM8 are used	0.45

Types of the Guide Ball Bushing

Types and Features

Model LG-S

In this type, the diameter and the length of the LG nut are the same as that of Linear Bushing model LM. This type is dimensionally interchangeable with model LM.

Specification Table⇒ **A4-14**

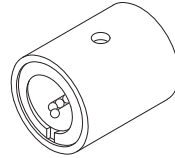

Model LG-L

Model LG-L is a long type in which the overall length of the LG nut is longer than that of model LG-S to increase the load carrying capacity.

Specification Table⇒ **A4-14**

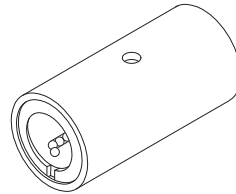

Flowchart for Selecting a Guide Ball Bushing

Steps for Selecting a Guide Ball Bushing

The following flowchart should be used as a guide for selecting a Guide Ball Bushing.

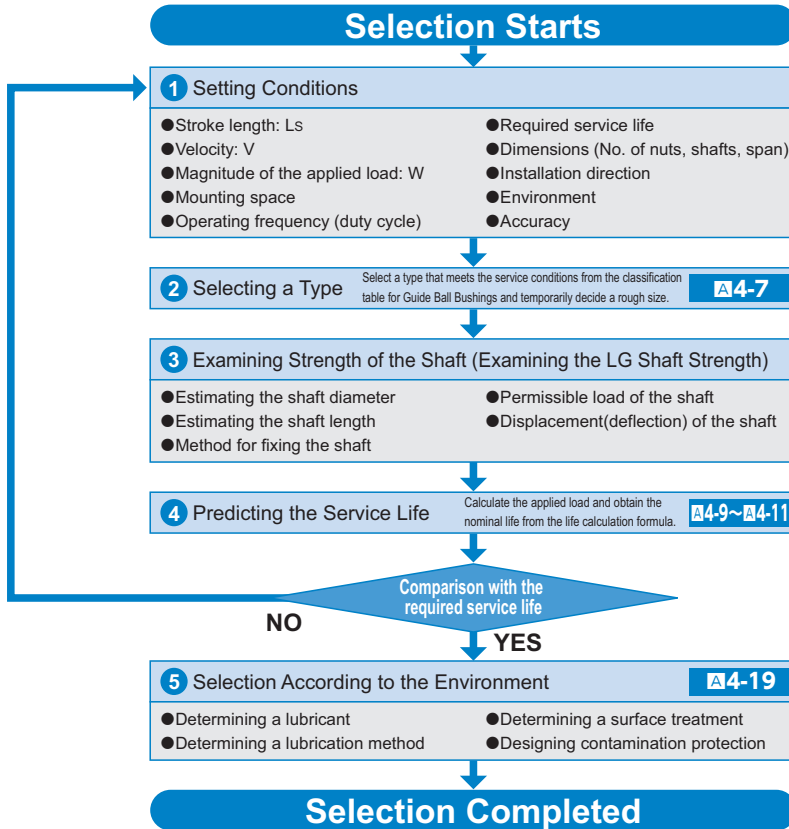

Rated Load and Nominal Life

[Load Rating]

The rated load of the Guide Ball Bushing varies according to the position of balls in relation to the load direction. The basic load ratings indicated in the specification tables each indicate the value when one row of balls receiving a load are directly under the load.

If the Guide Ball Bushing is mounted so that two rows of balls evenly receive the load in the load direction, the rated load changes as shown in Table1.

Table1 Rated load of the Guide Ball Bushing

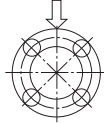
Rows of balls	Ball position	Load Rating
4 rows		$1.41 \times C$

Note: For specific values for "C" above, see the respective specification table.

[Calculating the Nominal Life]

The nominal life of the Guide Ball Bushing is obtained using the following equation.

$$L = \left(\frac{f_H \cdot f_T \cdot f_c}{f_w} \cdot \frac{C}{P_c} \right)^3 \times 50$$

L	: Nominal life	(km)
C	: Basic dynamic load rating	(N)
P _c	: Calculated load	(N)
f _T	: Temperature factor	
f _c	: Contact factor	(see Table2 on A4-11)
f _w	: Load factor	(see Table3 on A4-11)
f _H	: Hardness factor	(see Fig.1)

● When a Moment Load is Applied to a Single Nut or Two Nuts in Close Contact with Each Other

When a moment load is applied to a single nut or two nuts in close contact with each other, calculate the equivalent radial load at the time the moment is applied.

$$P_u = K \cdot M$$

P _u	: Equivalent radial load	(N)
	(with a moment applied)	
K	: Equivalent factors	
	(see Table4 to Table5 on A4-12)	
M	: Applied moment	(N-mm)

However, "P_u" is assumed to be within the basic static load rating (C₀).

● When a Moment Load and a Radial Load are Simultaneously Applied

When a moment and a radial load are applied simultaneously, calculate the service life based on the sum of the radial load and the equivalent radial load.

■ f_H: Hardness Factor

To maximize the load capacity of the Guide Ball Bushing, the hardness of the raceways needs to be between 58 to 64 HRC.

If the hardness is lower than this range, the basic dynamic load rating and the basic static load rating decrease. Therefore, it is necessary to multiply each rating by the respective hardness factor (f_H).

Normally, f_H = 1.0 since the Guide Ball Bushing has sufficient hardness.

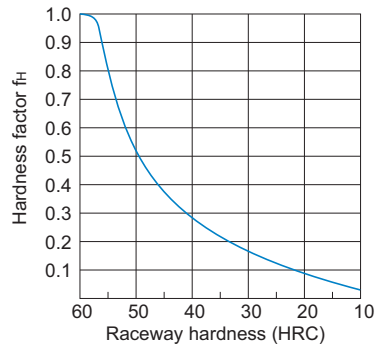

Fig.1 Hardness Factor (f_H)

■f_r: Temperature Factor

The temperature of the environment where the Guide Ball Bushing is used must be 80°C or below. Therefore, adopt a temperature factor $f_r = 1.0$.

The Guide Ball Bushing does not support high temperature. Therefore, if the environment temperature exceeds 80°C, it is necessary to use another product.

■f_c: Contact Factor

When multiple nuts are used in close contact with each other, their linear motion is affected by moments and mounting accuracy, making it difficult to achieve uniform load distribution. In such applications, multiply the basic load rating (C) and (C₀) by the corresponding contact factor in Table2.

Note) If uneven load distribution is expected in a large machine, take into account the respective contact factor indicated in Table2.

Table2 Contact Factor (f_c)

Number of nuts in close contact with each other	Contact factor f _c
2	0.81
3	0.72
4	0.66
5	0.61
Normal use	1

■f_w: Load Factor

In general, reciprocating machines tend to involve vibrations or impact during operation. It is difficult to accurately determine vibrations generated during high-speed operation and impact during frequent start and stop motion. Therefore, when loads applied on a Guide Ball Bushing cannot be measured, or when speed and impact have a significant influence, divide the basic load rating (C) or (C₀) by the corresponding load factor in Table3.

Table3 Load Factor (f_w)

Vibrations/impact	Speed(V)	f _w
Faint	Very low $V \leq 0.25\text{m/s}$	1 to 1.2
Weak	Slow $0.25 < V \leq 1\text{m/s}$	1.2 to 1.5
Medium	Medium $1 < V \leq 2\text{m/s}$	1.5 to 2
Strong	High $V > 2\text{m/s}$	2 to 3.5

[Calculating the Service Life Time]

When the nominal life (L) has been obtained, if the stroke length and the number of reciprocations per minute are constant, the service life time is obtained using the following equation.

$$L_h = \frac{L \times 10^3}{2 \times \ell_s \times n_1 \times 60}$$

L_h : Service life time (h)

ℓ_s : Stroke length (m)

n₁ : Number of reciprocations per minute (min⁻¹)

Table of Equivalent Factors

Table4 Equivalent Factors of Model LG-S

Model No.	Equivalent factor: K	
	Single nut	Double blocks
LG 4S	1.062	0.193
LG 6S	0.885	0.121
LG 8S	0.708	0.096

Table5 Equivalent Factors of Model LG-L

Model No.	Equivalent factor: K
	Single nut
LG 4L	0.733
LG 6L	0.465
LG 8L	0.442

Precautions To Be Taken if an Eccentric Load Is Applied

Model LG achieves a much higher load-carrying capacity in receiving the eccentric load (moment and torque) than Linear Bushing model LM because of 4 rows of raceways. However, under conditions where the eccentric load is larger, the product may result in poor operation or early failure. In such cases, we recommend using Ball Spline model LBS or LT, both of which have larger load-carrying capacities (see **A3-30** onward for model LBS, or **A3-54** onward for model LT).

Accuracy Standards

[Guide Ball Bushing]

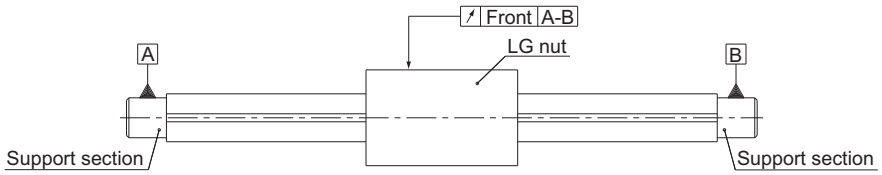

Table6 Run-out of the outer diameter of the nut relative to the support section of the shaft

Unit: μm

Overall shaft length (mm)		Run-out(max)*
-	200 or less	72
Above 200	250 or less	133

*: The value if the radial clearance is zero

Model LG

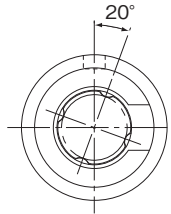

Model No.	Shaft Diameter D _o h7	Nut dimensions					
		Outer diameter		Length		Pin hole	
		D	Tolerance	L	Tolerance	b +0.05 0	t +0.08 -0.02
LG4S	4	8	0	12	0	1.2	0.8
LG4L		8	-0.009	19	-0.12	1.2	0.8
LG6S	6	12	0	19	0	1.5	1.2
LG6L		12		27		1.5	1.2
LG8S	8	15	-0.011	24	-0.2	2	1.5
LG8L		15		30		2	1.5

Note) The basic load ratings each indicate the value when one row of balls receiving a load are directly under the load.
 The permissible torques each represent a reference value when the radial clearance is maximum (+10 μ m).
 The permissible moments each indicate a reference value when the radial clearance is the maximum (+10 μ m) with one row of balls receiving a load being directly under the load.

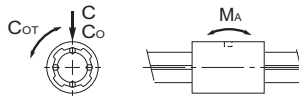

Model number coding

① LG shaft only

LG4 -100L

Model No.

Overall LG shaft length

② LG nut only

LG4S

Model No.

③ A set product consisting of an LG shaft and an LG nut

2 LG4S +100L

Model No.

Overall LG shaft length

Number of LG nuts on one shaft
(no symbol for one nut)

Note) Model LG guide ball bushing available as LG shaft ①, or the LG nut ② separate.

A set consisting of an ③ LG shaft + an LG nut is also available if so desired.

A special radial clearance, designated grease application (standard type is applied only with antirust oil) and surface treatment (THK AP-C treatment, THK AP-CF treatment, THK AP-HC treatment) are also available.

Contact THK for details.

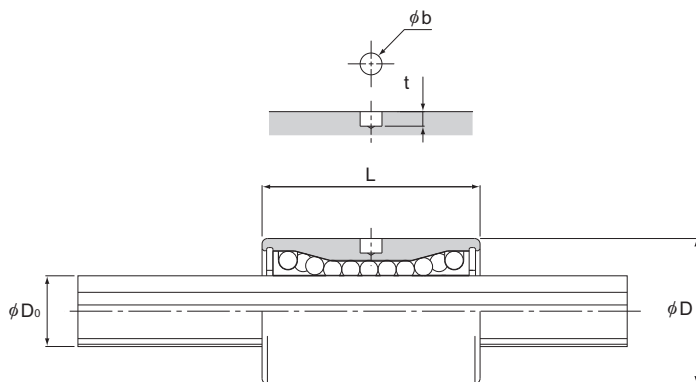

Unit: mm

	Basic load rating (radial)		Permissible torque C_{0T} N·m	Permissible moment M_A N·m	Mass g
	C N	C_0 N			
	335	473	0.066	0.33	2.5
	466	757	0.105	0.71	4.0
	494	681	0.241	0.74	10.5
	860	1499	0.530	1.71	14.0
	796	1065	0.838	1.46	16.5
	1203	1916	1.509	2.66	22.0

[Radial Clearance]

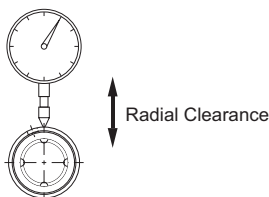

Measurement of a radial clearance

Radial Clearance Unit: μm

Normal clearance
0 to +10

[LG Shaft]

Material: SUJ2

Hardness: 56 to 64 HRC



LG shaft dimensions Unit: mm

Model No.	Shaft diameter D_0 h7	Standard length L				Maximum manufacturing length	Mass (g/m)
		100	150	200	250		
LG4	4	100	150	—	—	150	95
LG6	6	100	150	200	—	200	220
LG8	8	100	150	200	250	250	390

Assembling the Guide Ball Bushing

[Inner Diameter of the Housing]

Table1 shows recommended housing inner-diameter tolerance for the Guide Ball Bushing. When fitting the Guide Ball Bushing with the housing, loose fit is normally recommended. If the clearance needs to be smaller, provide transition fit.

Table1 Housing Inner-diameter Tolerance

General conditions	H6
If the accuracy does not need to be very high	H7

[Mounting the Nut]

Although the Guide Ball Bushing does not require a large amount of strength for securing it in the LG shaft direction, do not support the nut only with driving fitting. For the housing inner-diameter tolerance, see Table1.

- Mounting model LG using a pin

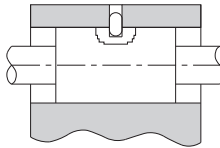

- Mounting model LG as with the conventional Linear Bushing

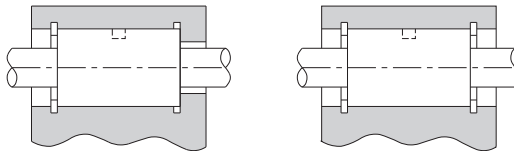

Snap Ring

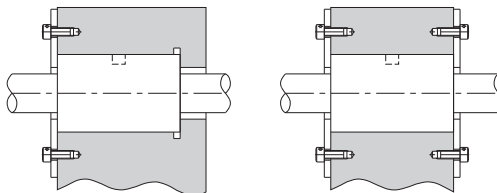

Stopper Plate

■Snap Ring for Installation

To secure the Guide Ball Bushing model LG, snap rings indicated in Table2 are available.

Table2 Types of Snap Rings

Model No.	Snap ring	
	For inner surface	
	Needle snap ring	C-shape snap ring
LG 4	8	—
LG 6	12	12
LG 8	15	15

■Set Screws Not Allowed

Securing the nut by pressing the outer surface with one set screw as shown in Fig.1 will cause the nut to be deformed.

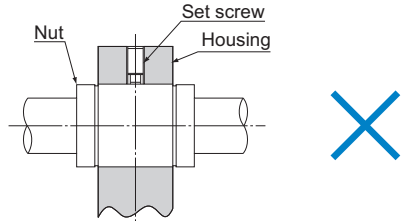

Fig.1

[Incorporating the Nut]

When incorporating the Guide Ball Bushing into a housing, use a jig and drive in the nut, or use a flatter plate and gently hit the nut, instead of directly hitting the side plate or the seal. (see Fig.2).

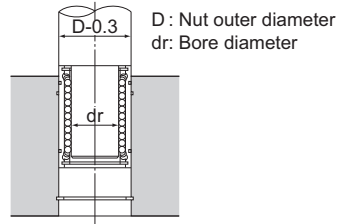

Fig.2

Unit: mm

Model No.	dr	Tolerance
LG 4S/LG 4L	3.6	-0.1 -0.3
LG 6S/LG 6L	5.6	
LG 8S/LG 8L	7.5	

[Inserting the LG Shaft]

When inserting the LG shaft into the Guide Ball Bushing, align the center of the shaft with that of the nut and gently insert the shaft straightforward into the nut. If the shaft is slanted while it is inserted, balls may fall off or the retainer may be deformed (see Fig.3).

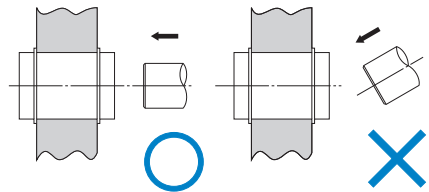

Fig.3

[When Under a Moment Load]

When using the Guide Ball Bushing, make sure that the load is evenly distributed on the whole ball raceway. In particular, if a moment load is applied, use two or more Guide Ball Bushing units on the same LG shaft and secure an adequately large distance between the units.

If using the Guide Ball Bushing under a moment load, also calculate the equivalent radial load and identify the correct model number. (See **A4-10**.)

Lubrication

The Guide Ball Bushing requires grease or oil as a lubricant for its operation.

[Grease Lubrication]

If integrating the product with the LG shaft, apply grease to rows of balls of the Guide Ball Bushing. Alternatively, apply grease to the LG shaft.

Afterward, replenish grease of the same type as necessary according to the service conditions. We recommend using high-quality lithium-soap group grease No. 2.

[Oil Lubrication]

Turbine oil, machine oil and spindle oil are commonly used as a lubricant.

When oiling the Guide Ball Bushing, drop oil on the LG shaft, or infuse it from the greasing hole on the housing as shown in Fig.1.

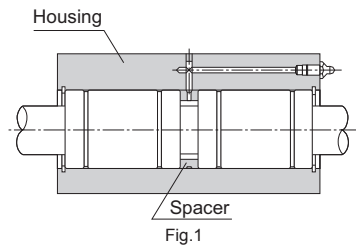

Dust prevention

Entrance of dust or other foreign material into the Guide Ball Bushing will cause abnormal wear or shorten the service life. When entrance of dust or other foreign material is a possibility, it is important to select effective seals and/or dust-control device that meets the service environment conditions. In addition, THK produces round bellows. Contact us for details.

Model Number Coding

Model number configurations differ depending on the model features. Refer to the corresponding sample model number configuration.

[Guide Ball Bushing]

Estimates and orders should be made for LG shafts alone or LG nuts alone in principle.

A set consisting of an LG shaft and an LH nut is also available if desired by the customer. Contact THK for details.

● Models LG-S and LG-L

- LG shaft only

LG4 -100L

Model No.
of LG shaft

Overall LG shaft length (in mm)

- LG nut only

LG4S

Model No. of LG nut

- Combination of
LG shaft and LG nut

2 LG4S +100L

Model No.
of LG nut

Overall LG shaft length (in mm)

Number of LG nuts on one shaft
(no symbol for one nut)

A special radial clearance, designated grease application (standard product is applied with antirust oil only), and surface treatment (THK AP-C treatment, THK AP-CF treatment, THK AP-HC treatment) are also available. Contact THK for details.

[Handling]

- (1) Disassembling components may cause dust to enter the system or degrade mounting accuracy of parts. Do not disassemble the product.
- (2) Dropping or hitting the Guide Ball Bushing may damage it. Giving an impact force to the product could also cause damage even if the product looks intact.

[Lubrication]

- (1) Thoroughly remove anti-rust oil and feed lubricant before using the product.
- (2) Do not mix lubricants of different physical properties.
- (3) In locations exposed to constant vibrations or in special environments such as clean rooms, vacuum and low/high temperature, normal lubricants may not be used. Contact THK for details.
- (4) When planning to use a special lubricant, contact THK before using it.

[Precautions on Use]

- (1) Entrance of foreign material may cause damage to the ball circulating component or functional loss. Prevent foreign material, such as dust or cutting chips, from entering the system.
- (2) Do not use the product at temperature of 80°C or higher. Contact THK if you desire to use the product at a temperature of 80°C or higher.
- (3) Please be careful when using the product in an environment with excessive coolant. The coolant may cause premature failure if it penetrates the Guide Ball Bushing. Contact THK for further details.
- (4) If foreign material adheres to the product, replenish the lubricant after cleaning the product.
- (5) When using the product in locations exposed to constant vibrations or in special environments such as clean rooms, vacuum and low/high temperature, contact THK in advance.

[Storage]

When storing the Guide Ball Bushing, enclose it in a package designated by THK and store it while avoiding high temperature, low temperature and high humidity.

[Assembling the LG Nut with the LG Shaft of the Guide Ball Bushing]

- (1) When assembling the LG nut with the LG shaft, align the position of the balls inside the nut with the position of the groove of the LG shaft, then insert the LG shaft into the LG nut straightforward and gradually. If the LG shaft is tilted when it is inserted, balls may bounce out or break the circulation part.
- (2) If the LG shaft is stuck in the middle of insertion, do not force it into the nut. Instead, pull it out first, re-check the ball position and the LG shaft groove position, and then insert it straightforward and gradually.

- (3) After assembling the LG nut with the LG shaft, check that the LG nut or the LG shaft smoothly moves. If the shaft was forced into the nut, function could be lost even if the product looks intact.

Features of the Linear Bushing

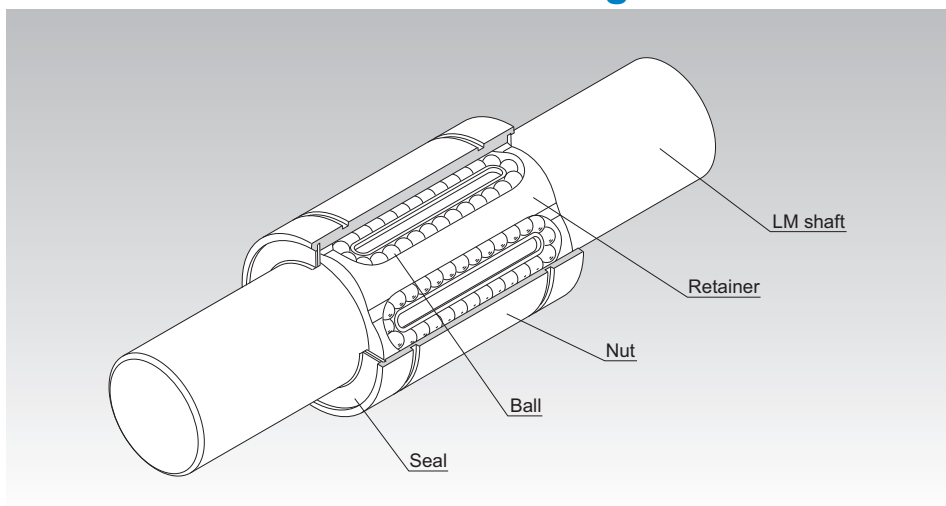

Fig.1 Structure of Linear Bushing Model LM···UU

Structure and Features

Linear Bushing model LM is a linear motion system used in combination with a cylindrical LM shaft to perform infinite straight motion. The balls in the loaded area of the nut are in point contact with the LM shaft. This allows straight motion with minimal friction resistance and achieves highly accurate and smooth motion despite the small permissible load.

The nut uses high-carbon chromium bearing steel and its outer and inner surfaces are ground after being heat-treated.

The Linear Bushing is used in a broad array of applications, such as slide units of precision equipment including OA equipment and peripherals, measuring instruments, automatic recorders and digital 3D measuring instruments, industrial machines including multi-spindle drilling machine, punching press, tool grinder, automatic gas cutting apparatus, printing machine, card selector and food packing machine.

[Interchangeability]

Since the dimensional tolerances of the Linear Bush's components are standardized, they are interchangeable. The LM shaft is machined through cylindrical grinding, which can easily be performed, and it allows highly accurate fitting clearance to be achieved.

[Highly Accurate Retainer Plate]

Since the retainer, which guides three to eight rows of balls, is integrally molded, it is capable of accurately guiding the balls in the traveling direction and achieving stable running accuracy. Small-diameter types use integrally molded retainers made of synthetic resin. It reduces noise generated during operation and allows for superb lubrication.

[Wide Array of Types]

A wide array of types are available, such as standard type, clearance-adjustable type, open type, long type and flanged linear bushing, allowing the user to select a type that meets the intended use.

Types of the Linear Ball Bushing

Types and Features

Standard Type

With the Linear Bushing nut having the most accurate cylindrical shape, this type is widely used.

There are two series of the Linear Bushing in dimensional group.

- Model LM
Metric units series used most widely in Japan
- Model LM-MG
Stainless steel version of type LM
- Model LME
Metric units series commonly used in Europe

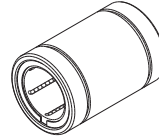

Standard Type

Open Type

The nut is partially cut open by one row of balls (50° to 80°). This enables the Linear Bushing to be used even in locations where the LM shaft is supported by a column or fulcrum. In addition, a clearance can easily be adjusted.

Models LM-OP/LME-OP

Model LM-MGA-OP

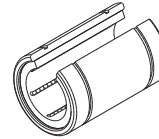

Open Type

Clearance-adjustable Type

This type has the same dimensions as the standard type, but the nut has a slit in the direction of the LM shaft. This allows the linear bushing to be installed in a housing whose inner diameter is adjustable, and enables the clearance between the LM shaft and the housing to easily be adjusted.

Models LM-AJ/LME-AJ

Model LM-MG-AJ

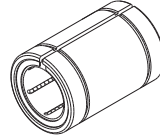

Clearance-adjustable Type

Long Type

Containing two units of the standard retainer plate, this type is optimal for locations where a moment load is present and reduces man-hours in installation.

Model LM-L······Standard type

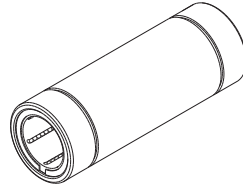

Long Type

Flanged Type (Round)

The nut of the standard type Linear Bushing is integrated with a flange. This enables the Linear Bushing to be directly mounted onto the housing with bolts, thus achieving easy installation.

Model LMF······Standard type

Model LMF-M······Made of stainless steel

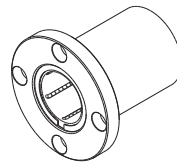

Flanged Type (Round)

Flanged Type (Square)

Like model LMF, this type also has a flange, but the flange is cut to a square shape. Since the height is lower than the circular flange type, compact design is allowed.

Model LMK··········Standard type

Model LMK-M··········Made of stainless steel

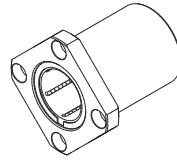

Flanged Type (Square)

Flanged Type (Round) - Long

The nut of the long type Linear Bushing is integrated with a flange. This enables the Linear Bushing to be directly mounted onto the housing with bolts, thus achieving easy installation. Containing two units of the standard retainer plate, this type is optimal for locations where a moment load is present.

Model LMF-L··········Standard type

Model LMF-ML··········Made of stainless steel

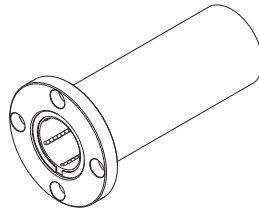

Flanged Type (Round) - Long

Flanged Type (Square) - Long

Like model LMF-L, this type also has a flange, but the flange is cut to a square shape. Since the height is lower than the circular flange type, compact design is allowed.

Model LMK-L··········Standard type

Model LMK-ML··········Made of stainless steel

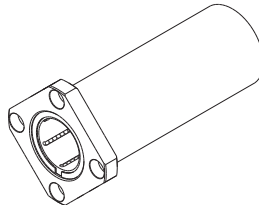

Flanged Type (Square) - Long

Flanged Type (Cut Flange)

The nut is integrated with a cut flange. Since the height is lower than model LMK, compact design is allowed. Since the rows of balls in the Linear Bushing are arranged so that two rows receive the load from the flat side, a long service life can be achieved.

Model LMH.....Standard type

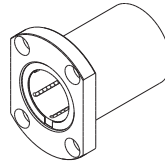

Flanged Type (Cut Flange)

Flanged Type (Cut Flange) - Long

The flange is a cut flange and lower than model LMK-L, allowing compact design. Containing two units of the standard retainer plate, this type is optimal for locations where a moment load is present. Since the rows of balls in the Linear Bushing are arranged so that two rows receive the load from the flat side, a long service life can be achieved.

Model LMH-L.....Standard type

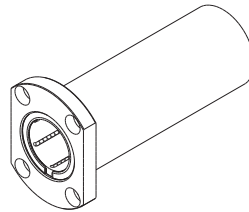

Flanged Type (Cut Flange) - Long

Linear Bushing Model SC

It is a case unit where the standard type of Linear Bushing is incorporated into a small, light-weight aluminum casing. This model can easily be mounted simply by securing it to the table with bolts.

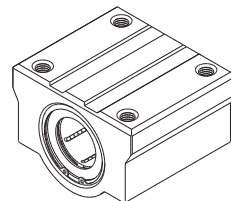

Linear Bushing Model SC

Linear Bushing (Long) Model SL

A long version of model SC, this model contains two units of the standard type Linear Bushing in an aluminum casing.

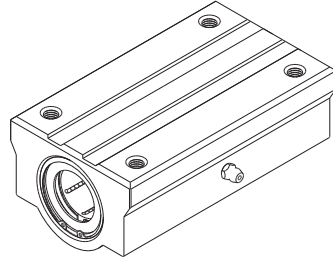

Linear Bushing (Long) Model SL

Linear Bushing Model SH

It is a case unit where the standard type of Linear Bushing is incorporated into a smaller and lighter aluminum casing than model SC. This model allows even more compact design than model SC. It also has flexibility in mounting orientation. Additionally, it is structured so that two rows of balls receive the load from the top of the casing, allowing a long service life to be achieved.

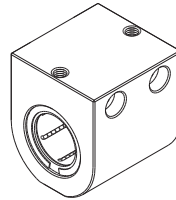

Linear Bushing Model SH

Linear Bushing (Long) Model SH-L

A long version of model SH, this model is a case unit that contains two units of the standard type Linear Bushing in an aluminum casing.

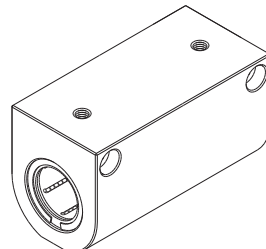

Linear Bushing (Long) Model SH-L

LM Shaft End Support Model SK

An aluminum-made light fulcrum for securing an LM shaft. The LM shaft mounting section has a slit, enabling the linear bushing to firmly secure an LM shaft using bolts.

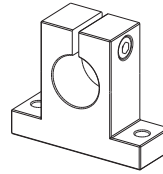

LM Shaft End Support Model SK

Standard LM Shafts

THK manufactures high quality, dedicated LM shafts for Linear Bushing model LM series.



Standard LM Shafts

Build-to-order LM Shafts

THK also manufactures hollow LM shafts and specially machined shafts at your request.



Build-to-order LM Shafts

Classification Table

Linear Bushing

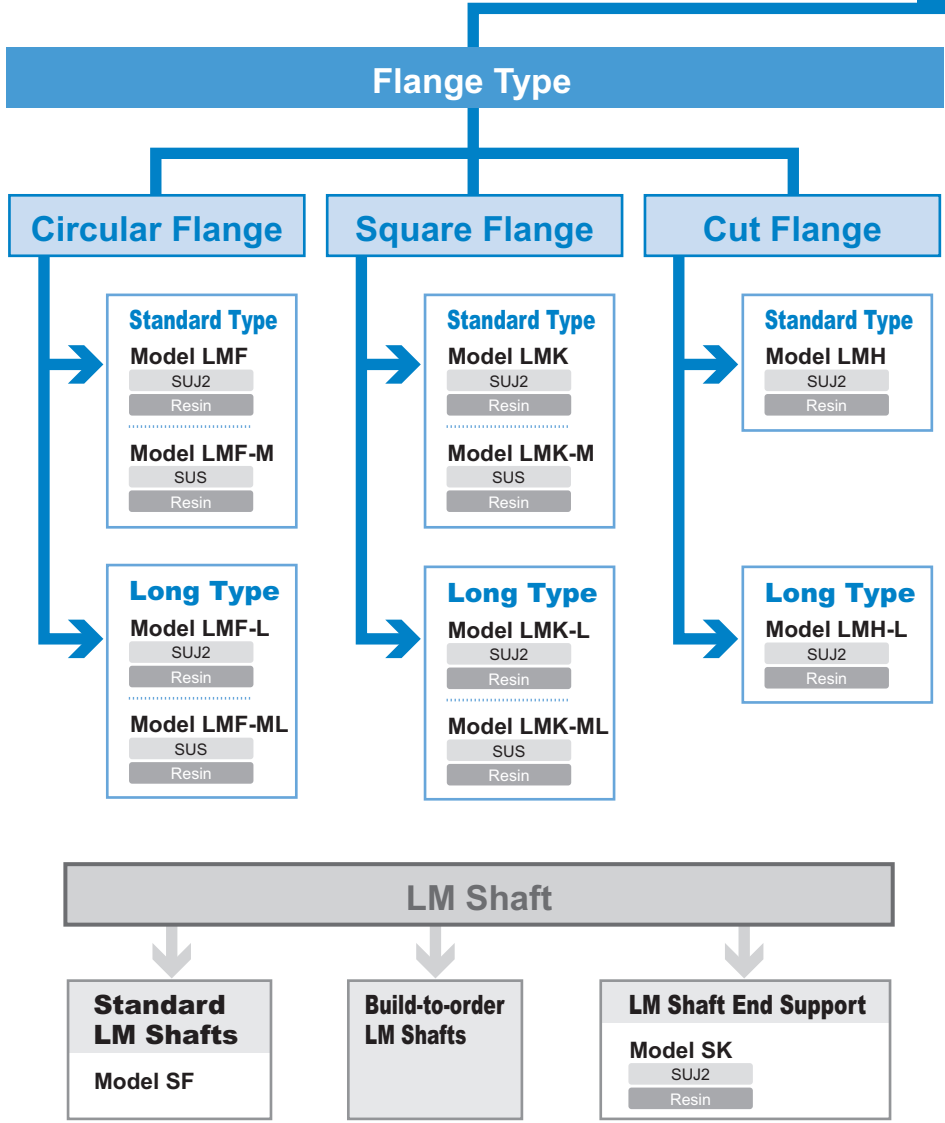

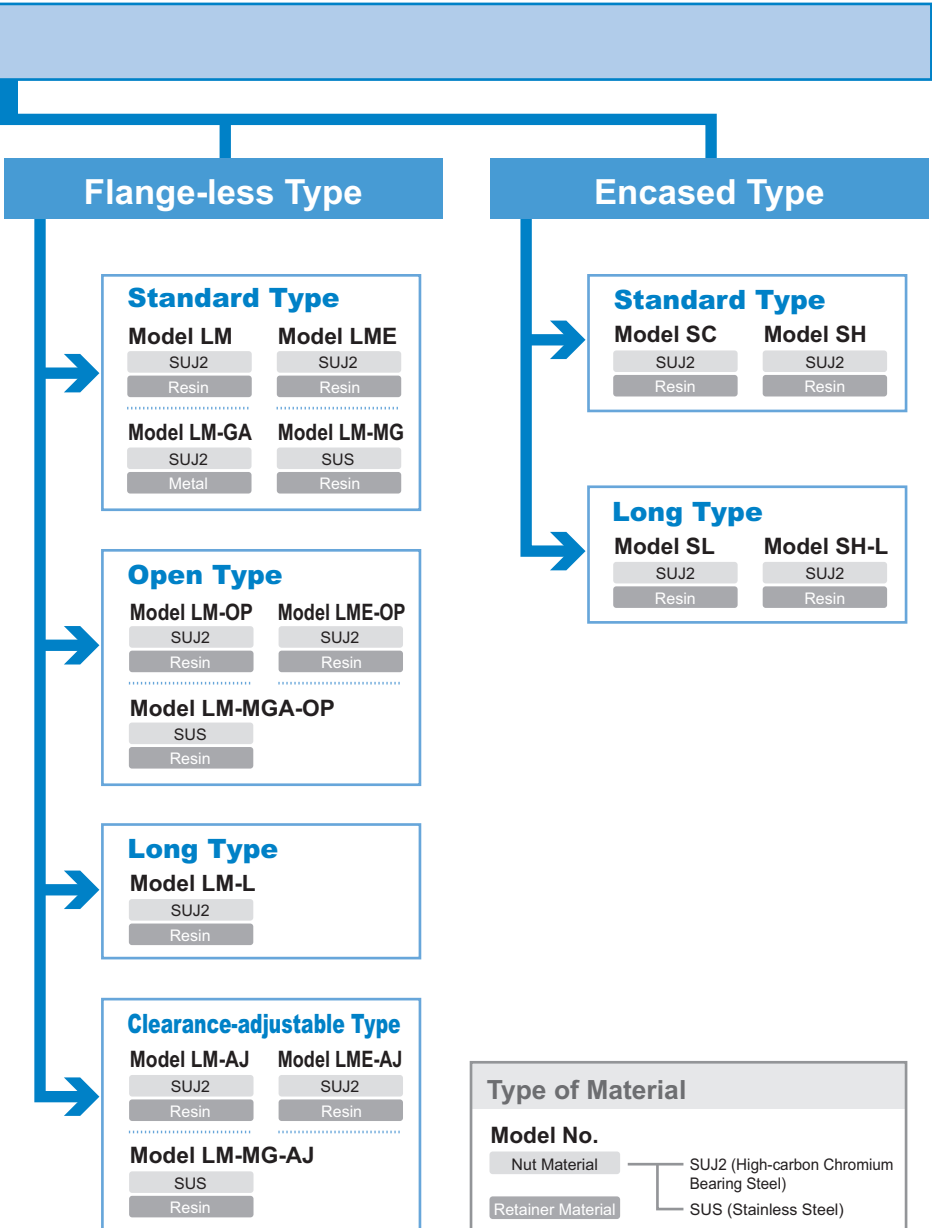

Flowchart for Selecting a Linear Bushing

Steps for Selecting a Linear Bushing

The following flowchart should be used as a guide for selecting a Linear Bushing.

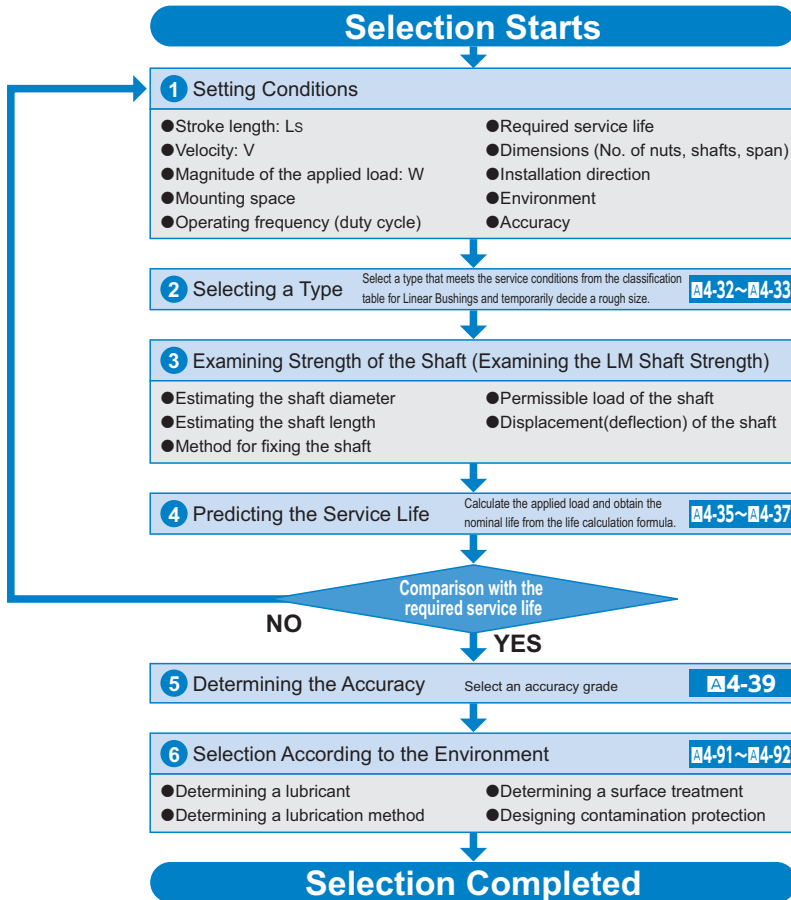

Rated Load and Nominal Life

[Load Rating]

The rated load of the Linear Bushing varies according to the position of balls in relation to the load direction. The basic load ratings indicated in the specification tables each indicate the value when one row of balls receiving a load are directly under the load.

If the Linear Bushing is mounted so that two rows of balls evenly receive the load in the load direction, the rated load changes as shown in Table1.

Table1 Rated load of the Linear Bushing

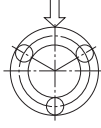
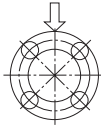
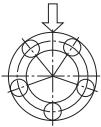
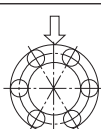
Rows of balls	Ball position	Load Rating
3 rows		$1 \times C$
4 rows		$1.41 \times C$
5 rows		$1.46 \times C$
6 rows		$1.28 \times C$

For specific values for "C" above, see the respective specification table.

[Calculating the Nominal Life]

The nominal life of the Linear Bushing is obtained using the following equation.

$$L = \left(\frac{f_H \cdot f_T \cdot f_C}{f_W} \cdot \frac{C}{P_C} \right)^3 \times 50$$

- L : Nominal life (km)
- C : Basic dynamic load rating (N)
- P_C : Calculated load (N)
- f_T : Temperature factor (see Fig.2 on **A4-37**)
- f_C : Contact factor (see Table2 on **A4-37**)
- f_W : Load factor (see Table3 on **A4-37**)
- f_H : Hardness factor (see Fig.1)

● When a Moment Load is Applied to a Single Nut or Two Nuts in Close Contact with Each Other

When a moment load is applied to a single nut or two nuts in close contact with each other, calculate the equivalent radial load at the time the moment is applied.

$$P_u = K \cdot M$$

- P_u : Equivalent radial load (N)
(with a moment applied)
 - K : Equivalent factors
(see Table4 to Table6 on **A4-38**)
 - M : Applied moment (N-mm)
- However, “P_u” is assumed to be within the basic static load rating (C₀).

● When a Moment Load and a Radial Load are Simultaneously Applied

When a moment and a radial load are applied simultaneously, calculate the service life based on the sum of the radial load and the equivalent radial load.

■f_H: Hardness Factor

To maximize the load capacity of the Linear Bushing, the hardness of the raceways needs to be between 58 to 64 HRC.

If the hardness is lower than this range, the basic dynamic load rating and the basic static load rating decrease. Therefore, it is necessary to multiply each rating by the respective hardness factor (f_H).

Normally, f_H = 1.0 since the Linear Bushing has sufficient hardness.

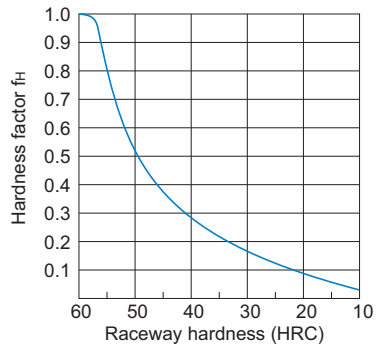

Fig.1 Hardness Factor (f_H)

■f_t: Temperature Factor

If the temperature of the environment surrounding the operating Linear Bushing exceeds 100°C, take into account the adverse effect of the high temperature and multiply the basic load ratings by the temperature factor indicated in Fig.2.

Also note that the Linear Bushing itself must be of high temperature type.

Note) If the environment temperature exceeds 80°C, use a Linear Bushing type equipped with metal retainer plates.

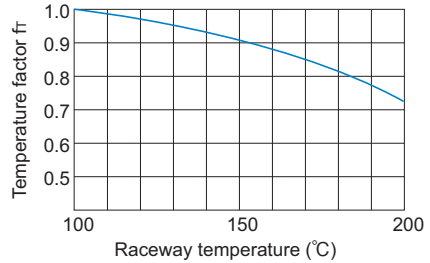

Fig.2 Temperature Factor (f_t)

■f_c: Contact Factor

When multiple nuts are used in close contact with each other, their linear motion is affected by moments and mounting accuracy, making it difficult to achieve uniform load distribution. In such applications, multiply the basic load rating (C) and (C₀) by the corresponding contact factor in Table2.

Note) If uneven load distribution is expected in a large machine, take into account the respective contact factor indicated in Table2.

Table2 Contact Factor (f_c)

Number of nuts in close contact with each other	Contact factor f _c
2	0.81
3	0.72
4	0.66
5	0.61
Normal use	1

■f_w: Load Factor

In general, reciprocating machines tend to involve vibrations or impact during operation. It is difficult to accurately determine vibrations generated during high-speed operation and impact during frequent start and stop motion. Therefore, when loads applied on a Linear Bushing cannot be measured, or when speed and impact have a significant influence, divide the basic load rating (C) or (C₀) by the corresponding load factor in Table3.

Table3 Load Factor (f_w)

Vibrations/ impact	Speed(V)	f _w
Faint	Very low V ≤ 0.25m/s	1 to 1.2
Weak	Slow 0.25 < V ≤ 1m/s	1.2 to 1.5
Medium	Medium 1 < V ≤ 2m/s	1.5 to 2
Strong	High V > 2m/s	2 to 3.5

[Calculating the Service Life Time]

When the nominal life (L) has been obtained, if the stroke length and the number of reciprocations per minute are constant, the service life time is obtained using the following equation.

$$L_h = \frac{L \times 10^3}{2 \times l_s \times n_1 \times 60}$$

- L_h : Service life time (h)
- l_s : Stroke length (m)
- n₁ : Number of reciprocations per minute (min⁻¹)

Table of Equivalent Factors

Table4 Equivalent Factors of Model LM

Model No.	Equivalent factor: K	
	Single nut	Double blocks
LM 3	1.566	0.26
LM 4	1.566	0.21
LM 5	1.253	0.178
LM 6	0.553	0.162
LM 8S	0.708	0.166
LM 8	0.442	0.128
LM 10	0.389	0.101
LM 12	0.389	0.097
LM 13	0.343	0.093
LM 16	0.279	0.084
LM 20	0.257	0.071
LM 25	0.163	0.054
LM 30	0.153	0.049
LM 35	0.143	0.045
LM 38	0.127	0.042
LM 40	0.117	0.04
LM 50	0.096	0.032
LM 60	0.093	0.028
LM 80	0.077	0.022
LM 100	0.065	0.017
LM 120	0.051	0.015

Note) Equivalent factors for models LMF, LMK, LMH and SC are the same as that for model LM.

Table5 Equivalent Factors of Model LM-L

Model No.	Equivalent factor: K
	Single nut
LM 3L	0.654
LM 4L	0.578
LM 5L	0.446
LM 6L	0.402
LM 8L	0.302
LM 10L	0.236
LM 12L	0.226
LM 13L	0.214
LM 16L	0.192
LM 20L	0.164
LM 25L	0.12
LM 30L	0.106
LM 35L	0.1
LM 40L	0.086
LM 50L	0.068
LM 60L	0.062

Note) Equivalent factors for models LMF-L, LMK-L and LMH-L are the same as that for model LM-L.

Table6 Equivalent Factors of Model LME

Model No.	Equivalent factor: K	
	Single nut	Double blocks
LME 5	0.669	0.123
LME 8	0.514	0.116
LME 12	0.389	0.09
LME 16	0.343	0.081
LME 20	0.291	0.063
LME 25	0.209	0.052
LME 30	0.167	0.045
LME 40	0.127	0.039
LME 50	0.105	0.031
LME 60	0.093	0.024
LME 80	0.077	0.018

Precautions To Be Taken if an Eccentric Load Is Applied

Since Linear Bushing is not suitable for application of an eccentric load, we recommend using Guide Ball Bushing or Ball Spline.

Accuracy Standards

[Linear Bushing]

The accuracy of the Linear Bushing in inscribed bore diameter, outer diameter, width and eccentricity is described in the corresponding specification table. The accuracy of mode LM in inscribed bore diameter and eccentricity is classified into high accuracy grade (no symbol) and precision grade (P). (Accuracy symbol is expressed at the end of the model number.)

For the clearance-adjustable type (-AJ) and open type (-OP), the inscribed bore diameter tolerance, the outer diameter tolerance, and the eccentricity indicate the values before the division of the nut.

Model LM

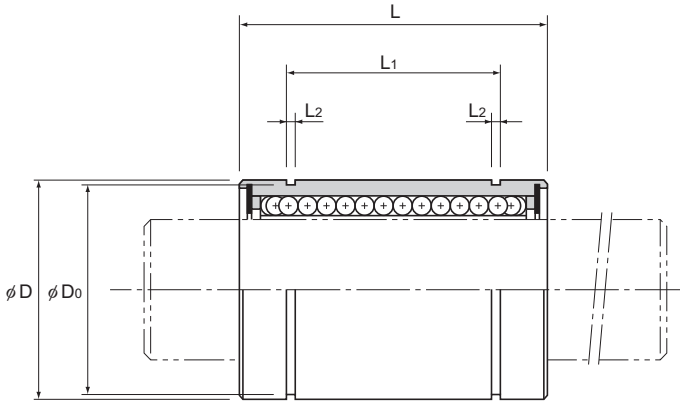

Model No.			Ball rows	Main						
Standard type	Clearance-adjustable type	Open type		Inscribed bore diameter		Outer diameter		Length		
				dr	Tolerance		D	Tolerance	L	Tolerance
				Precision	High	Precision/high				
LM 3	—	—	4	3	0	0	7	0	10	0
LM 4	—	—	4	4	-0.005	-0.008	8	-0.009	12	
LM 5	—	—	4	5			10		15	
LM 6	LM 6-AJ	—	4	6	0	0	12	0	19	0
LM 8S	LM 8S-AJ	—	4	8			15		17	
LM 8	LM 8-AJ	—	4	8			15		24	
LM 10	LM 10-AJ	—	4	10			19		29	
LM 12	LM 12-AJ	LM 12-OP	4	12			21		30	
LM 13	LM 13-AJ	LM 13-OP	4	13	23	32	-0.2			
LM 16	LM 16-AJ	LM 16-OP	5	16	28	37				
LM 20	LM 20-AJ	LM 20-OP	5	20	32	42				
LM 25	LM 25-AJ	LM 25-OP	6	25	0	0	40	0	59	0
LM 30	LM 30-AJ	LM 30-OP	6	30	-0.007	-0.010	45	-0.016	64	
LM 35	LM 35-AJ	LM 35-OP	6	35			52		70	
LM 40	LM 40-AJ	LM 40-OP	6	40	0	0	60	0	80	
LM 50	LM 50-AJ	LM 50-OP	6	50	-0.008	-0.012	80	-0.019	100	
LM 60	LM 60-AJ	LM 60-OP	6	60	0	0	90	0	110	-0.3
					-0.009	-0.015		-0.022		

Note) Since this model contains a synthetic resin retainer, do not use it at temperature exceeding 80°C.
 If the ambient temperature exceeds 80°C, use the type equipped with a metal retainer (model LM-GA).
 If requiring a type equipped with a seal, indicate it when placing an order.
 (Example) LM13 UU

Seal attached on both ends of the nut

For the clearance-adjustable type (-AJ) and open type (-OP), the inscribed bore diameter tolerance, the outer diameter tolerance, and the eccentricity indicate the values before the division of the nut.

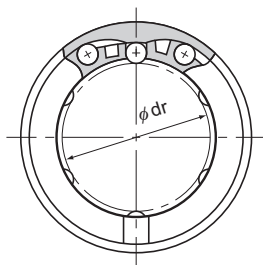

Model LM

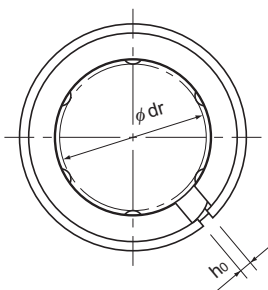

Model LM-AJ

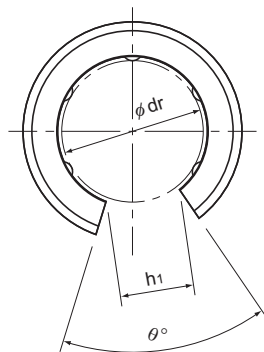

Model LM-OP

Unit: mm

dimensions								Eccentricity (max) μm		Radial clearance tolerance μm	Basic load rating		Mass g
L_1	Tolerance	L_2	D_o	h_o	h_1	θ°	Precision	High	C N		C_o N		
—	—	—	—	—	—	—	4	8	-2	88.2	108	1.4	
—	—	—	—	—	—	—	4	8	-3	88.2	127	1.9	
10.2	0 -0.2	1.1	9.6	—	—	—	4	8	-3	167	206	4	
13.5		1.1	11.5	1	—	—	8	12	-5	206	265	8	
11.5		1.1	14.3	1	—	—	8	12	-5	176	225	11	
17.5		1.1	14.3	1	—	—	8	12	-5	265	402	16	
22		1.3	18	1	—	—	8	12	-5	373	549	30	
23		1.3	20	1.5	8	80	8	12	-5	412	598	31.5	
23		1.3	22	1.5	9	80	8	12	-7	510	775	43	
26.5		1.6	27	1.5	11	60	8	12	-7	775	1180	69	
30.5		1.6	30.5	1.5	11	60	10	15	-9	863	1370	87	
41		1.85	38	2	12	50	10	15	-9	980	1570	220	
44.5	0 -0.3	1.85	43	2.5	15	50	10	15	-9	1570	2750	250	
49.5		2.1	49	2.5	17	50	12	20	-13	1670	3140	390	
60.5		2.1	57	3	20	50	12	20	-13	2160	4020	585	
74		2.6	76.5	3	25	50	12	20	-13	3820	7940	1580	
85		3.15	86.5	3	30	50	17	25	-16	4710	10000	2000	

Note) When using the Linear Bushing on a single shaft, use two or more units (instead of one unit) on the same shaft to avoid a moment load, and secure a large distance between the units.
If oil holes are required, specify the model number with the OH symbol added to the end.

Model LM-GA (Metal Retainer Type)

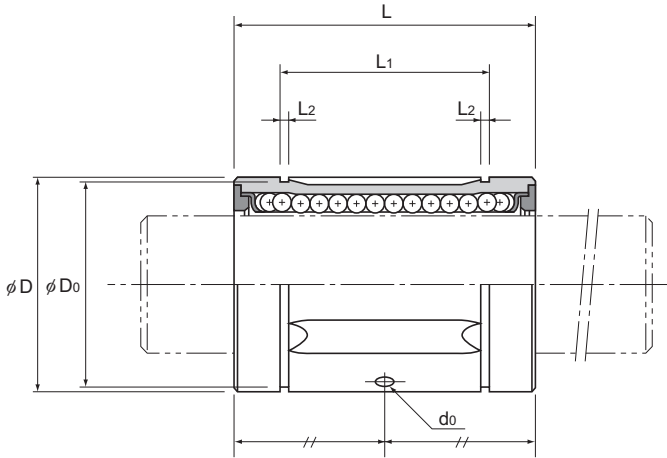

Model No.			Ball rows	Main									
Standard type	Clearance-adjustable type	Open type		Inscribed bore diameter		Outer diameter		Length					
				dr	Tolerance		D	Tolerance Precision/high	L	Tolerance			
LM 6GA	—	—	3	6	0	-0.006	0	-0.009	12	0	-0.011	19	0
LM 8SGA	—	—	3	8					15			17	
LM 8GA	—	—	3	8					15			24	
LM 10GA	—	—	4	10					19	29	-0.2		
LM 12GA	LM 12GA-AJ	LM 12GA-OP	4	12					21	30			
LM 13GA	LM 13GA-AJ	LM 13GA-OP	4	13					23	32			
LM 16GA	LM 16GA-AJ	LM 16GA-OP	4	16	28	37							
LM 20GA	LM 20GA-AJ	LM 20GA-OP	5	20	32	42	0						
LM 25GA	LM 25GA-AJ	LM 25GA-OP	5	25	40	59							
LM 30GA	LM 30GA-AJ	LM 30GA-OP	6	30	45	64							
LM 35GA	LM 35GA-AJ	LM 35GA-OP	6	35	52	70		0					
LM 38GA	LM 38GA-AJ	LM 38GA-OP	6	38	57	76							
LM 40GA	LM 40GA-AJ	LM 40GA-OP	6	40	60	80							
LM 50GA	LM 50GA-AJ	LM 50GA-OP	6	50	80	100							
LM 60GA	LM 60GA-AJ	LM 60GA-OP	6	60	90	110	0						
LM 80GA	LM 80GA-AJ	LM 80GA-OP	6	80	120	140							
LM 100GA	LM 100GA-AJ	LM 100GA-OP	6	100	150	175		-0.4					
LM 120A	LM 120A-AJ	LM 120A-OP	8	120	180	200							

Note) If requiring a type equipped with a seal, indicate it when placing an order. (seal heat resistance: 80°C.)

(Example) LM50GA UU

Seal attached on both ends of the nut

For the clearance-adjustable type (-AJ) and open type (-OP), the inscribed bore diameter tolerance, the outer diameter tolerance, and the eccentricity indicate the values before the division of the nut.

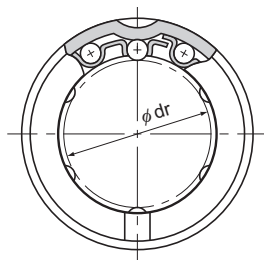

Model LM-GA

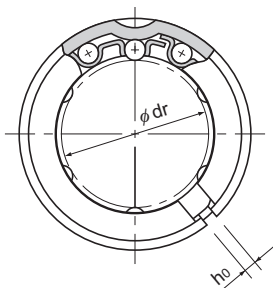

Model LM-GA-AJ

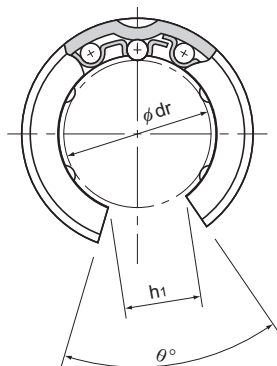

Model LM-GA-OP

Unit: mm

dimensions								Greasing hole d _o	Eccentricity (max) μm		Radial clearance tolerance μm	Basic load rating		Mass g
L ₁	Tolerance	L ₂	D ₀	h ₀	h ₁	θ°	Precision		High	C N		C ₀ N		
13.5	0 -0.2	1.1	11.5	—	—	—	—	8	12	-5	206	265	8	
11.5		1.1	14.3	—	—	—	—	8	12	-5	176	225	11	
17.5		1.1	14.3	—	—	—	—	8	12	-5	265	402	16	
22		1.3	18	—	—	—	—	2	8	12	-5	373	549	30
23		1.3	20	1.5	7.5	80	2	8	12	-5	412	598	31.5	
23		1.3	22	1.5	9	80	2	8	12	-7	510	775	43	
26.5		1.6	27	1.5	11	60	2.3	8	12	-7	775	1180	69	
30.5		1.6	30.5	2	11	60	2.3	10	15	-9	863	1370	87	
41	0 -0.3	1.85	38	2	13	60	3	10	15	-9	980	1570	220	
44.5		1.85	43	2.5	15	50	3	10	15	-9	1570	2750	250	
49.5		2.1	49	2.5	17	50	3	12	20	-13	1670	3140	390	
58.5		2.1	54.5	3	18	50	3	12	20	-13	2160	4020	565	
60.5		2.1	57	3	20	50	3	12	20	-13	2160	4020	585	
74		2.6	76.5	3	25	50	4	12	20	-13	3820	7940	1580	
85		3.15	86.5	3	30	50	4	17	25	-16	4710	10000	2000	
105.5		0 -0.4	4.15	116	3	40	50	4	17	25	-16	7350	16000	4520
125.5	4.15		145	3	50	50	4	20	30	-20	14100	34800	8600	
158.6	4.15		175	4	85	80	5	20	30	-25	16400	40000	15000	

Note) When using the Linear Bushing on a single shaft, use two or more bushings on the same shaft to minimize a moment load, and secure a large distance between the units.
Model LM-GA has oil holes as a standard feature.

Model LM-MG (Stainless Steel Type)

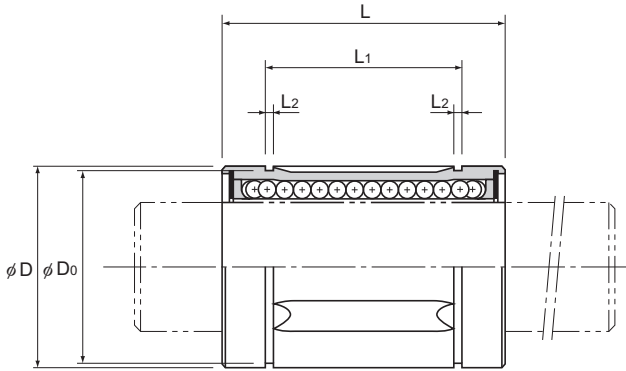

Model No.			Ball rows	Main						
Standard type	Clearance-adjustable type	Open type		Inscribed bore diameter		Outer diameter		Length		
				dr	Tolerance		D	Tolerance	L	Tolerance
				Precision	High	Precision/high	Precision/high			
LM 3M	—	—	4	3	0 -0.005	0 -0.008	7	0 -0.009	10	0 -0.12
LM 4M	—	—	4	4			8		12	
LM 5M	—	—	4	5			10		15	
* LM 6MG	LM 6MG-AJ	—	4	6	0 -0.006	0 -0.009	12	0 -0.011	19	0 -0.2
* LM 8SMG	LM 8SMG-AJ	—	4	8			15		17	
* LM 8MG	* LM 8MG-AJ	—	4	8			15		24	
* LM 10MG	* LM 10MG-AJ	—	4	10			19		29	
* LM 12MG	* LM 12MG-AJ	—	4	12			21		30	
* LM 13MG	* LM 13MG-AJ	* LM13MGA-OP	4	13			23		32	
* LM 16MG	* LM 16MG-AJ	* LM16MGA-OP	4	16	28	37				
* LM 20MG	* LM 20MG-AJ	* LM20MGA-OP	5	20	0 -0.007	0 -0.010	32	0 -0.016	42	0 -0.3
* LM 25MG	* LM 25MG-AJ	* LM25MGA-OP	5	25			40		59	
* LM 30MG	* LM 30MG-AJ	* LM30MGA-OP	6	30			45		64	
* LM 35MG	* LM 35MG-AJ	* LM35MGA-OP	6	35			52		70	
* LM 40MG	* LM 40MG-AJ	* LM40MGA-OP	6	40	-0.008	-0.012	60	-0.019	80	

Note) Since this model contains a synthetic resin retainer, do not use it at temperature exceeding 80°C.
 If the ambient temperature exceeds 80°C, use the type equipped with a metal retainer and indicate "A" at the end of the model number.
 (For those marked with * in the table, metal retainers are available. Only metal retainer is available for open type.)
 (Metal retainer types of models LM6MG, 8SMG and 8MG each have 3 rows of balls.)

(Example) LM30MG A
 High temperature symbol

If requiring a type equipped with a seal, indicate it when placing an order. (seal heat resistance: 80°C.)

(Example) LM30MG UU
 Seal attached on both ends of the nut

For the clearance-adjustable type (-AJ) and open type (-OP), the inscribed bore diameter tolerance, the outer diameter tolerance, and the eccentricity indicate the values before the division of the nut.

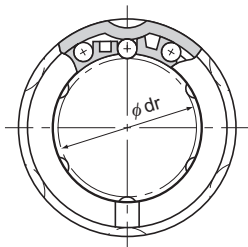

Model LM-MG

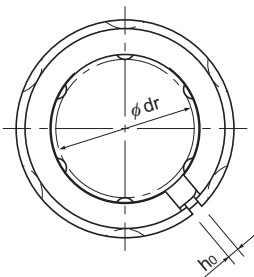

Model LM-MG-AJ

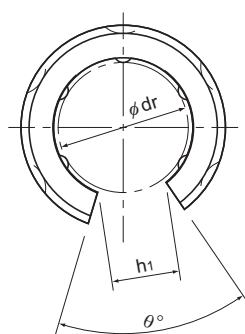

Model LM-MG-OP

Unit: mm

dimensions								Eccentricity (max) μm		Radial clearance tolerance μm	Basic load rating		
L ₁	Tolerance	L ₂	D ₀	h ₀	h ₁	θ°	Precision	High	C N		C ₀ N	Mass g	
—	—	—	—	—	—	—	4	8	-2	88.2	108	1.4	
—	—	—	—	—	—	—	4	8	-3	88.2	127	1.9	
10.2	-0.2	1.1	9.6	—	—	—	4	8	-3	167	206	4	
13.5		1.1	11.5	1	—	—	8	12	-5	206	265	8	
11.5		1.1	14.3	1	—	—	8	12	-5	176	225	11	
17.5		1.1	14.3	1	—	—	8	12	-5	265	402	16	
22		1.3	18	1	—	—	8	12	-5	373	549	30	
23		1.3	20	1.5	—	—	8	12	-5	412	598	31.5	
23		1.3	22	1.5	9	80	8	12	-7	510	775	43	
26.5		1.6	27	1.5	11	80	8	12	-7	775	1180	69	
30.5		1.6	30.5	1.5	11	60	10	15	-9	863	1370	87	
41		-0.3	1.85	38	2	12	50	10	15	-9	980	1570	220
44.5	1.85		43	2.5	15	50	10	15	-9	1570	2750	250	
49.5	2.1		49	2.5	17	50	12	20	-13	1670	3140	390	
60.5	2.1		57	3	20	50	12	20	-13	2160	4020	585	

Note) Since the nut and the balls use stainless steel, these models are highly resistant to corrosion and environment.

If oil holes are required, specify the model number with the OH symbol added to the end.

When using the Linear Bushing on a single shaft, use two or more bushings on the same shaft to minimize a moment load, and secure a large distance between the units.

Model LME

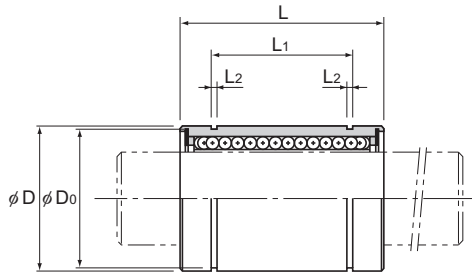

Model No.			Ball rows	Main					
Standard type	Clearance-adjustable type	Open type		Inscribed bore diameter		Outer diameter		Length	
				dr	Tolerance	D	Tolerance	L	Tolerance
LME 5	LME 5-AJ	—	4	5	+0.008 0	12	0	22	0 -0.2
LME 8	LME 8-AJ	—	4	8		16	-0.008	25	
LME 12	LME 12-AJ	LME 12-OP	4	12	22	0	32		
LME 16	LME 16-AJ	LME 16-OP	5	16	+0.009	26	-0.009	36	
LME 20	LME 20-AJ	LME 20-OP	5	20	-0.001	32	0 -0.011	45	0 -0.3
LME 25	LME 25-AJ	LME 25-OP	6	25	+0.011	40		0	
LME 30	LME 30-AJ	LME 30-OP	6	30	-0.001	47	-0.011	68	
LME 40	LME 40-AJ	LME 40-OP	6	40	62	0	80		
LME 50	LME 50-AJ	LME 50-OP	6	50	+0.013 -0.002	75	-0.013	100	0 -0.4
LME 60	LME 60-AJ	LME 60-OP	6	60	90	0	125		
LME 80	LME 80-AJ	LME 80-OP	6	80	+0.016 -0.004	120	-0.015	165	

Note) Since Linear Bushing models LME50 or smaller models are incorporated with a synthetic resin retainer, do not use them at temperature exceeding 80°C.

If the ambient temperature exceeds 80°C, use the type equipped with a metal retainer and indicate "A" at the end of the model number.

(Example) LME20G A

High temperature symbol

If requiring a type equipped with a seal, indicate it when placing an order. (seal heat resistance: 80°C.)

(Example) LME16 UU

Seal attached on both ends of the nut

For the clearance-adjustable type (-AJ) and open type (-OP), the inscribed bore diameter tolerance, the outer diameter tolerance, and the eccentricity indicate the values before the division of the nut.

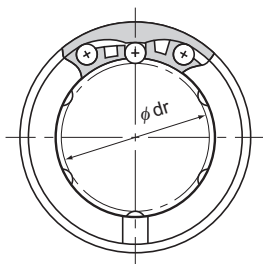

Model LME

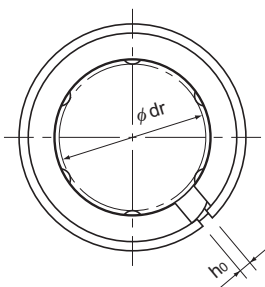

Model LME-AJ

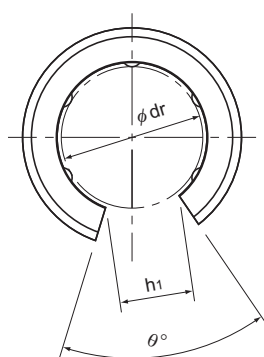

Model LME-OP

Unit: mm

dimensions								Eccentricity (max) μm	Radial clearance tolerance μm	Basic load rating		Mass g
L_1	Tolerance	L_2	D_0	h_0	h_1	θ°	C N			C_0 N		
14.5	0 -0.2	1.1	11.5	1	—	—	12	-5	206	265	11	
16.5		1.1	15.2	1	—	—	12	-5	265	402	20	
22.9		1.3	21	1.5	7.5	78	12	-7	510	775	41	
24.9		1.3	24.9	1.5	10	78	12	-7	775	1180	57	
31.5		1.6	30.3	2	10	60	15	-9	863	1370	91	
44.1	0 -0.3	1.85	37.5	2	12.5	60	15	-9	980	1570	215	
52.1		1.85	44.5	2	12.5	50	15	-9	1570	2750	325	
60.6		2.15	59	3	16.8	50	17	-13	2160	4020	705	
77.6		2.65	72	3	21	50	17	-13	3820	7940	1130	
101.7	0 -0.4	3.15	86.5	3	27.2	54	20	-16	4710	10000	2220	
133.7		4.15	116	3	36.3	54	20	-16	7350	16000	5140	

Note) If a metal retainer is used, the Linear Bushing has the shape as shown below.

When using the Linear Bushing on a single shaft, use two or more units (instead of one unit) on the same shaft to avoid a moment load, and secure a large distance between the units.

If oil holes are required, specify the model number with the OH symbol added to the end.



Model LME-GA

Model LM-L

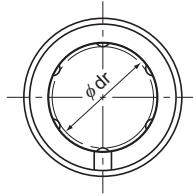

Model LM-L

Model No. Standard type	Ball rows	Main					
		Inscribed bore diameter		Outer diameter		Length	
		dr	Tolerance	D	Tolerance	L	Tolerance
LM 3L	4	3	0 -0.010	7	0 -0.013	19	0 -0.3
LM 4L	4	4		8		23	
LM 5L	4	5		10		29	
LM 6L	4	6		12		35	
LM 8L	4	8		15	45		
LM 10L	4	10		19	55		
LM 12L	4	12		21	0 -0.016	57	
LM 13L	4	13		23	61		
LM 16L	5	16		28	70		
LM 20L	5	20		32	80		
LM 25L	6	25	0 -0.012	40	0 -0.019	112	0 -0.4
LM 30L	6	30	45	123			
LM 35L	6	35	52	135			
LM 40L	6	40	0 -0.015	60	0 -0.022	154	
LM 50L	6	50	80	192			
LM 60L	6	60	0 -0.020	90	0 -0.025	211	

Note) Since this model contains a synthetic resin retainer, do not use it at temperature exceeding 80°C.
If requiring a type equipped with a seal, indicate it when placing an order.

(Example) LM13L UU

└── Seal attached on both ends of the nut

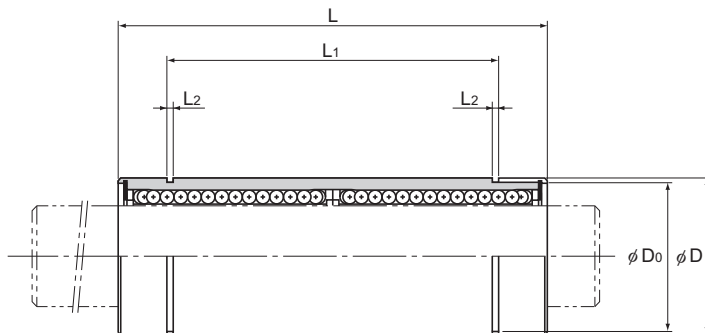

Unit: mm

dimensions					Eccentricity (max) μm	Radial clearance tolerance μm	Basic load rating		Mass g
L ₁	Tolerance	L ₂	D ₀	C N			C ₀ N		
—	—	—	—	10	-2	139	216	3	
—		—	—	10	-3	139	254	4	
20	0 -0.3	1.1	9.6	10	-3	263	412	8	
27		1.1	11.5	15	-5	324	529	16	
35		1.1	14.3	15	-5	431	784	31	
44		1.3	18	15	-5	588	1100	62	
46		1.3	20	15	-5	657	1200	80	
46		1.3	22	15	-7	814	1570	90	
53		1.6	27	15	-7	1230	2350	145	
61		1.6	30.5	20	-9	1400	2750	180	
82		0 -0.4	1.85	38	20	-9	1560	3140	440
89			1.85	43	20	-9	2490	5490	580
99	2.1		49	25	-13	2650	6270	795	
121	2.1		57	25	-13	3430	8040	1170	
148	2.6		76.5	25	-13	6080	15900	3100	
170	3.15		86.5	25	-16	7650	20000	3500	

Note) A stainless steel type is also available. Contact THK for details.

If oil holes are required, specify the model number with the OH symbol added to the end.

Model LMF

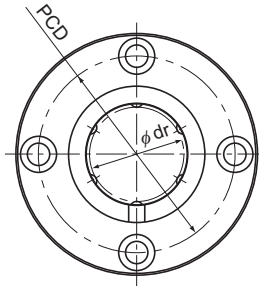

Model LMF

Model No.	Ball rows	Main dimensions							
		Inscribed bore diameter		Outer diameter		Length		Flange diameter	
		dr	Tolerance	D	Tolerance	L	Tolerance	D _i	Tolerance
LMF 6	4	6	0 -0.009	12	0 -0.011	19	0 -0.2	28	0 -0.2
LMF 8S	4	8		15		17		32	
LMF 8	4	8		15	24	32			
LMF 10	4	10		19	29	39			
LMF 12	4	12	21	0 -0.013	30	42	0 -0.2		
LMF 13	4	13	23	32	43				
LMF 16	5	16	28	37	48	0 -0.10	54		
LMF 20	5	20	32	42	54				
LMF 25	6	25	40	0 -0.016	59	62	0 -0.3	0 -0.3	
LMF 30	6	30	45	64	74				
LMF 35	6	35	52	0 -0.019	70	82			
LMF 40	6	40	60	80	96				
LMF 50	6	50	80	100	116	0 -0.3	0 -0.3		
LMF 60	6	60	90	0 -0.022	110			134	

Note) Since this model contains a synthetic resin retainer, do not use it at temperature exceeding 80°C.
If requiring a type equipped with a seal, indicate it when placing an order.

(Example) LMF25 UU

└── Seal attached on both ends of the nut

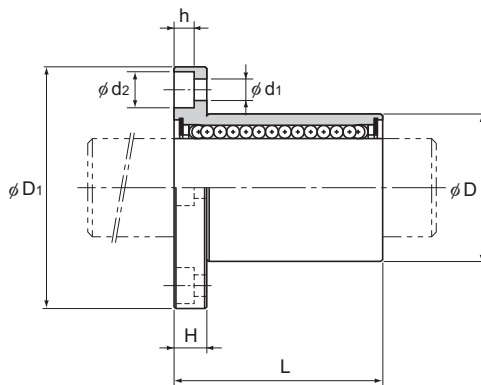

Unit: mm

	H	PCD	Mounting hole d ₁ × d ₂ × h	Flange perpendicularity	Eccentricity (max)	Radial clearance tolerance	Basic load rating		Mass g
				μm	μm	μm	C N	C ₀ N	
	5	20	3.4 × 6.5 × 3.3	12	12	-5	206	265	26.5
	5	24	3.4 × 6.5 × 3.3	12	12	-5	176	225	34
	5	24	3.4 × 6.5 × 3.3	12	12	-5	265	402	40
	6	29	4.5 × 8 × 4.4	12	12	-5	373	549	78
	6	32	4.5 × 8 × 4.4	12	12	-5	412	598	76
	6	33	4.5 × 8 × 4.4	12	12	-7	510	775	94
	6	38	4.5 × 8 × 4.4	12	12	-7	775	1180	134
	8	43	5.5 × 9.2 × 5.4	15	15	-9	863	1370	180
	8	51	5.5 × 9.2 × 5.4	15	15	-9	980	1570	340
	10	60	6.6 × 11 × 6.5	15	15	-9	1570	2750	460
	10	67	6.6 × 11 × 6.5	20	20	-13	1670	3140	795
	13	78	9 × 14 × 8.6	20	20	-13	2160	4020	1054
	13	98	9 × 14 × 8.6	20	20	-13	3820	7940	2200
	18	112	11 × 17.5 × 10.8	25	25	-13	4710	10000	2960

Model LMF-M (Stainless Steel Type)

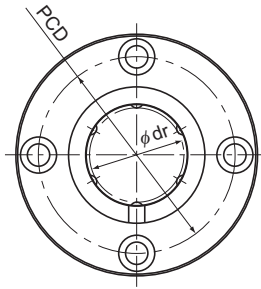

Model LMF-M

Model No.	Ball rows	Main dimensions							
		Inscribed bore diameter		Outer diameter		Length		Flange diameter	
		dr	Tolerance	D	Tolerance	L	Tolerance	D _i	Tolerance
LMF 6M	4	6	0 -0.009	12	0 -0.011	19	0 -0.2	28	0 -0.2
LMF 8SM	4	8		15		17		32	
LMF 8M	4	8		15	24	32			
LMF 10M	4	10		19	29	39			
LMF 12M	4	12	21	0 -0.013	30	42			
LMF 13M	4	13	23	32	43				
LMF 16M	5	16	28	37	48				
LMF 20M	5	20	32	0 -0.016	42	54			
LMF 25M	6	25	40	59	0 -0.3	62			
LMF 30M	6	30	45	64	74				

Note) Since this model contains a synthetic resin retainer, do not use it at temperature exceeding 80°C.
If requiring a type equipped with a seal, indicate it when placing an order.

(Example) LMF20M UU

└── Seal attached on both ends of the nut

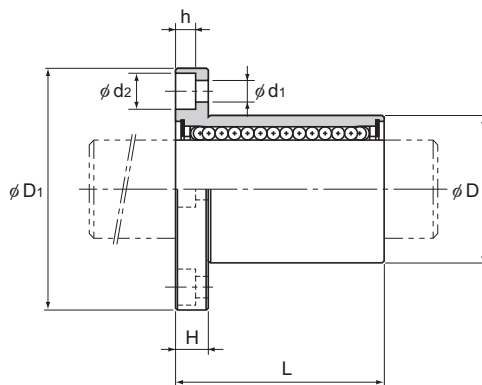

Unit: mm

	H	PCD	Mounting hole d ₁ × d ₂ × h	Flange perpendicularity	Eccentricity (max)	Radial clearance tolerance	Basic load rating		Mass g
				μm	μm	μm	C N	C ₀ N	
	5	20	3.4 × 6.5 × 3.3	12	12	-5	206	265	26.5
	5	24	3.4 × 6.5 × 3.3	12	12	-5	176	225	34
	5	24	3.4 × 6.5 × 3.3	12	12	-5	265	402	40
	6	29	4.5 × 8 × 4.4	12	12	-5	373	549	78
	6	32	4.5 × 8 × 4.4	12	12	-5	412	598	76
	6	33	4.5 × 8 × 4.4	12	12	-7	510	775	94
	6	38	4.5 × 8 × 4.4	12	12	-7	775	1180	134
	8	43	5.5 × 9.2 × 5.4	15	15	-9	863	1370	180
	8	51	5.5 × 9.2 × 5.4	15	15	-9	980	1570	340
	10	60	6.6 × 11 × 6.5	15	15	-9	1570	2750	460

Note) Since the nut and the balls use stainless steel, these models are highly resistant to corrosion and environment.

Model LMK

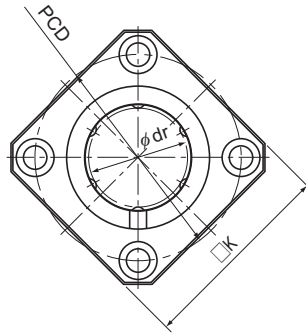

Model LMK

Model No.	Ball rows	Main dimensions							
		Inscribed bore diameter		Outer diameter		Length		Flange diameter	
		dr	Tolerance	D	Tolerance	L	Tolerance	D _i	Tolerance
LMK 6	4	6	0 -0.009	12	0 -0.011	19	0 -0.2	28	0 -0.2
LMK 8S	4	8		15		17		32	
LMK 8	4	8		15	24	32			
LMK 10	4	10		19	29	39			
LMK 12	4	12	21	0 -0.013	30	42			
LMK 13	4	13	23	32	43				
LMK 16	5	16	28	37	48				
LMK 20	5	20	32	42	54				
LMK 25	6	25	0 -0.010	40	0 -0.016	59	62		
LMK 30	6	30	45	64	74				
LMK 35	6	35	0 -0.012	52	0 -0.019	70	82		
LMK 40	6	40	60	80	96				
LMK 50	6	50	80	100	116				
LMK 60	6	60	0 -0.015	90	0 -0.022	110	134	0 -0.3	

Note) Since this model contains a synthetic resin retainer, do not use it at temperature exceeding 80°C.
If requiring a type equipped with a seal, indicate it when placing an order.

(Example) LMK13 UU

└── Seal attached on both ends of the nut

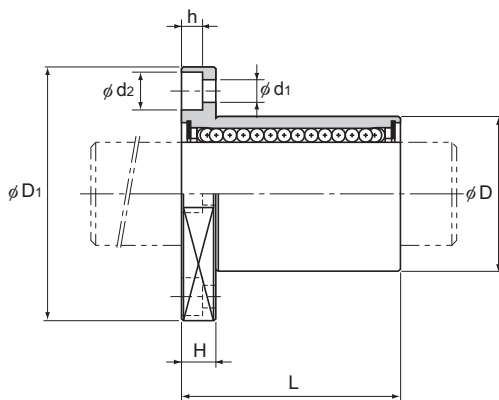

Unit: mm

	K	H	PCD	Mounting hole $d_1 \times d_2 \times h$	Flange perpendicularity	Eccentricity (max)	Radial clearance tolerance	Basic load rating		Mass g
					μm	μm	μm	C N	C_0 N	
	22	5	20	3.4×6.5×3.3	12	12	-5	206	265	18.5
	25	5	24	3.4×6.5×3.3	12	12	-5	176	225	23
	25	5	24	3.4×6.5×3.3	12	12	-5	265	402	29
	30	6	29	4.5×8×4.4	12	12	-5	373	549	61
	32	6	32	4.5×8×4.4	12	12	-5	412	598	56
	34	6	33	4.5×8×4.4	12	12	-7	510	775	75
	37	6	38	4.5×8×4.4	12	12	-7	775	1180	104
	42	8	43	5.5×9.2×5.4	15	15	-9	863	1370	145
	50	8	51	5.5×9.2×5.4	15	15	-9	980	1570	300
	58	10	60	6.6×11×6.5	15	15	-9	1570	2750	375
	64	10	67	6.6×11×6.5	20	20	-13	1670	3140	692
	75	13	78	9×14×8.6	20	20	-13	2160	4020	864
	92	13	98	9×14×8.6	20	20	-13	3820	7940	2020
	106	18	112	11×17.5×10.8	25	25	-13	4710	10000	2520

Model LMK-M (Stainless Steel Type)

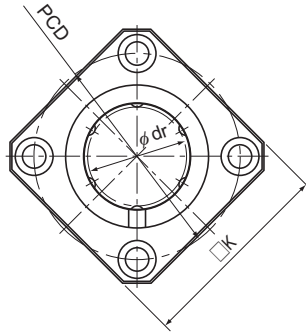

Model LMK-M

Model No.	Ball rows	Main dimensions							
		Inscribed bore diameter		Outer diameter		Length		Flange diameter	
		dr	Tolerance	D	Tolerance	L	Tolerance	D _f	Tolerance
LMK 6M	4	6	0 -0.009	12	0 -0.011	19	0 -0.2	28	0 -0.2
LMK 8SM	4	8		15		17		32	
LMK 8M	4	8		15	24	32			
LMK 10M	4	10		19	29	39			
LMK 12M	4	12	21	0 -0.013	30	42			
LMK 13M	4	13	23	32	43				
LMK 16M	5	16	28	37	48				
LMK 20M	5	20	32	0 -0.016	42	54			
LMK 25M	6	25	40	59	0 -0.3	62			
LMK 30M	6	30	45	64	74				

Note) Since this model contains a synthetic resin retainer, do not use it at temperature exceeding 80°C.
If requiring a type equipped with a seal, indicate it when placing an order.

(Example) LMK25M UU

└── Seal attached on both ends of the nut

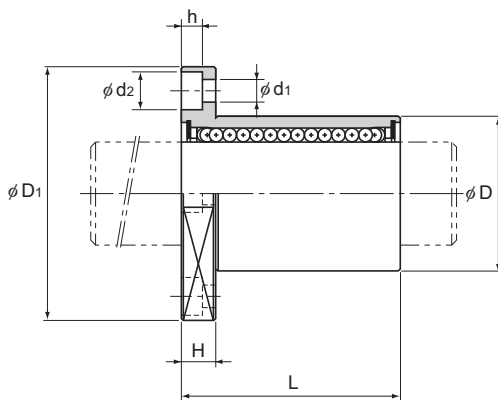

Unit: mm

	K	H	PCD	Mounting hole $d_1 \times d_2 \times h$	Flange perpendicularity	Eccentricity (max)	Radial clearance tolerance	Basic load rating		Mass g
					μm	μm	μm	C N	C_0 N	
	22	5	20	$3.4 \times 6.5 \times 3.3$	12	12	-5	206	265	18.5
	25	5	24	$3.4 \times 6.5 \times 3.3$	12	12	-5	176	225	23
	25	5	24	$3.4 \times 6.5 \times 3.3$	12	12	-5	265	402	29
	30	6	29	$4.5 \times 8 \times 4.4$	12	12	-5	373	549	61
	32	6	32	$4.5 \times 8 \times 4.4$	12	12	-5	412	598	56
	34	6	33	$4.5 \times 8 \times 4.4$	12	12	-7	510	775	75
	37	6	38	$4.5 \times 8 \times 4.4$	12	12	-7	775	1180	104
	42	8	43	$5.5 \times 9.2 \times 5.4$	15	15	-9	863	1370	145
	50	8	51	$5.5 \times 9.2 \times 5.4$	15	15	-9	980	1570	300
	58	10	60	$6.6 \times 11 \times 6.5$	15	15	-9	1570	2750	375

Note) Since the nut and the balls use stainless steel, these models are highly resistant to corrosion and environment.

Model LMF-L

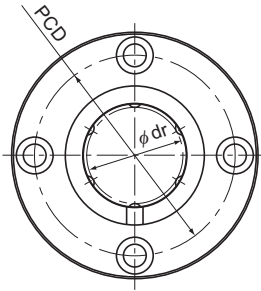

Model LMF-L

Model No. Standard type	Ball rows	Main dimensions							
		Inscribed bore diameter		Outer diameter		Length		Flange diameter	
		dr	Tolerance	D	Tolerance	L	Tolerance	D ₁	Tolerance
LMF 6L	4	6	0 -0.010	12	0	35	0 -0.3	28	0 -0.2
LMF 8L	4	8		15	-0.013	45		32	
LMF 10L	4	10		19	0 -0.016	55		39	
LMF 12L	4	12		21		57		42	
LMF 13L	4	13		23		61		43	
LMF 16L	5	16		28	0 -0.012	70		0 -0.4	
LMF 20L	5	20	32	80		54			
LMF 25L	6	25	40	-0.019		112	62		
LMF 30L	6	30	45	123		74			
LMF 35L	6	35	52	0 -0.022		135	82		
LMF 40L	6	40	60			154	96		
LMF 50L	6	50	80		192	116			
LMF 60L	6	60	0 -0.020	90	0 -0.025	211	134	0 -0.3	

Note) Since this model contains a synthetic resin retainer, do not use it at temperature exceeding 80°C.
If requiring a type equipped with a seal, indicate it when placing an order.

(Example) LMF35L UU

└─── Seal attached on both ends of the nut

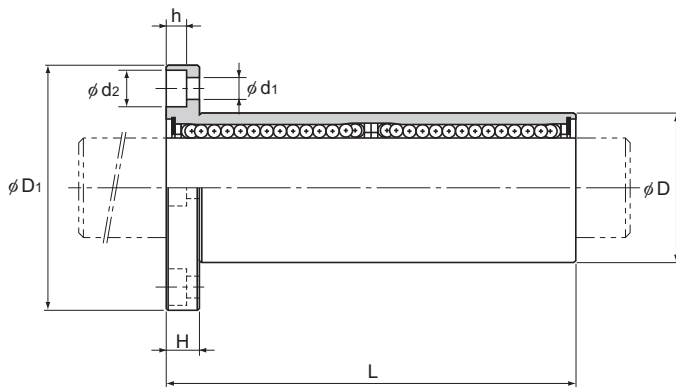

Unit: mm

	H	PCD	Mounting hole d ₁ × d ₂ × h	Flange perpendicularity	Eccentricity (max)	Radial clearance tolerance	Basic load rating		Mass g
				μm	μm	μm	C N	C ₀ N	
	5	20	3.4 × 6.5 × 3.3	15	15	-5	324	529	32
	5	24	3.4 × 6.5 × 3.3	15	15	-5	431	784	53
	6	29	4.5 × 8 × 4.4	15	15	-5	588	1100	105
	6	32	4.5 × 8 × 4.4	15	15	-5	657	1200	100
	6	33	4.5 × 8 × 4.4	15	15	-7	814	1570	130
	6	38	4.5 × 8 × 4.4	15	15	-7	1230	2350	187
	8	43	5.5 × 9.2 × 5.4	20	20	-9	1400	2750	260
	8	51	5.5 × 9.2 × 5.4	20	20	-9	1560	3140	515
	10	60	6.6 × 11 × 6.5	20	20	-9	2490	5490	655
	10	67	6.6 × 11 × 6.5	25	25	-13	2650	6270	970
	13	78	9 × 14 × 8.6	25	25	-13	3430	8040	1560
	13	98	9 × 14 × 8.6	25	25	-13	6080	15900	3500
	18	112	11 × 17.5 × 10.8	25	25	-13	7650	20000	4500

Model LMF-ML (Stainless Steel Type)

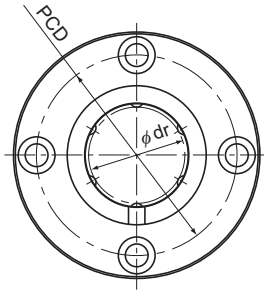

Model LMF-ML

Model No.	Ball rows	Main dimensions							
		Inscribed bore diameter		Outer diameter		Length		Flange diameter	
		dr	Tolerance	D	Tolerance	L	Tolerance	D ₁	Tolerance
LMF 6ML	4	6	0 -0.010	12	0	35	0 -0.3	28	0 -0.2
LMF 8ML	4	8		15	-0.013	45		32	
LMF 10ML	4	10		19	0 -0.016	55		39	
LMF 12ML	4	12		21		57		42	
LMF 13ML	4	13	23	0 -0.019	61	43			
LMF 16ML	5	16	28		70	48			
LMF 20ML	5	20	32	0 -0.012	80	54			
LMF 25ML	6	25	40		112	0	62		
LMF 30ML	6	30	45		123	-0.4	74		

Note) Since this model contains a synthetic resin retainer, do not use it at temperature exceeding 80°C.
If requiring a type equipped with a seal, indicate it when placing an order.

(Example) LMF13ML UU

└── Seal attached on both ends of the nut

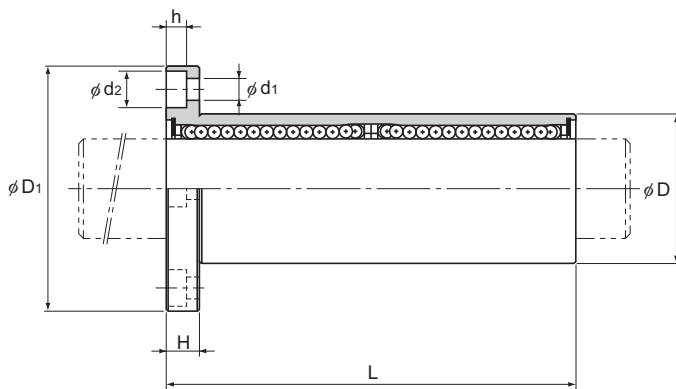

Unit: mm

	H	PCD	Mounting hole d ₁ × d ₂ × h	Flange perpendicularity	Eccentricity (max)	Radial clearance tolerance	Basic load rating		Mass g
				μm	μm	μm	C N	C ₀ N	
	5	20	3.4 × 6.5 × 3.3	15	15	-5	324	529	32
	5	24	3.4 × 6.5 × 3.3	15	15	-5	431	784	53
	6	29	4.5 × 8 × 4.4	15	15	-5	588	1100	105
	6	32	4.5 × 8 × 4.4	15	15	-5	657	1200	100
	6	33	4.5 × 8 × 4.4	15	15	-7	814	1570	130
	6	38	4.5 × 8 × 4.4	15	15	-7	1230	2350	187
	8	43	5.5 × 9.2 × 5.4	20	20	-9	1400	2750	260
	8	51	5.5 × 9.2 × 5.4	20	20	-9	1560	3140	515
	10	60	6.6 × 11 × 6.5	20	20	-9	2490	5490	655

Note) Since the nut and the balls use stainless steel, these models are highly resistant to corrosion and environment.

Model LMK-L

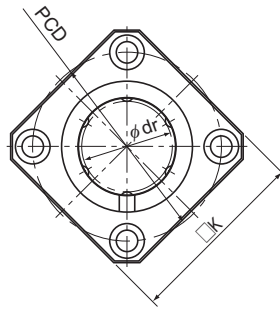

Model LMK-L

Model No. Standard type	Ball rows	Main dimensions							
		Inscribed bore diameter		Outer diameter		Length		Flange diameter	
		dr	Tolerance	D	Tolerance	L	Tolerance	D ₁	Tolerance
LMK 6L	4	6	0 -0.010	12	0	35	0 -0.3	28	0 -0.2
LMK 8L	4	8		15	-0.013	45		32	
LMK 10L	4	10		19	0 -0.016	55		39	
LMK 12L	4	12		21		57		42	
LMK 13L	4	13	23	0 -0.012	61	0 -0.4	43	0 -0.2	
LMK 16L	5	16	28		70		48		
LMK 20L	5	20	32	0	80	0 -0.019	54	0 -0.2	
LMK 25L	6	25	40	-0.019	112		62		
LMK 30L	6	30	45	0 -0.015	123	0 -0.4	74	0 -0.3	
LMK 35L	6	35	52		135		82		
LMK 40L	6	40	60	0	154	0 -0.022	96	0 -0.3	
LMK 50L	6	50	80	192	116				
LMK 60L	6	60	0 -0.020	90	0 -0.025	211	134		

Note) Since this model contains a synthetic resin retainer, do not use it at temperature exceeding 80°C.
If requiring a type equipped with a seal, indicate it when placing an order.

(Example) LMK50L UU

└─── Seal attached on both ends of the nut

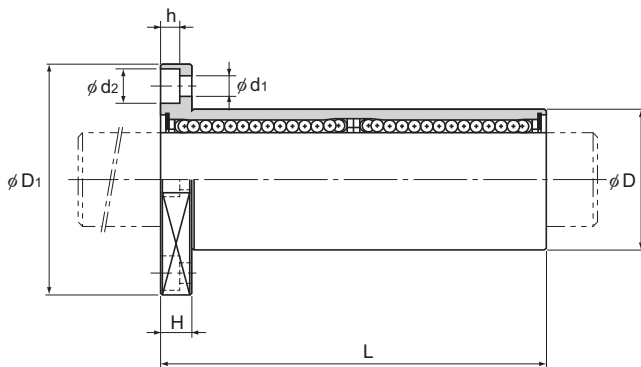

Unit: mm

	K	H	PCD	Mounting hole $d_1 \times d_2 \times h$	Flange perpendicularity	Eccentricity (max)	Radial clearance tolerance	Basic load rating		Mass
					μm	μm	μm	C N	C_0 N	g
	22	5	20	$3.4 \times 6.5 \times 3.3$	15	15	-5	324	529	26
	25	5	24	$3.4 \times 6.5 \times 3.3$	15	15	-5	431	784	46
	30	6	29	$4.5 \times 8 \times 4.4$	15	15	-5	588	1100	88
	32	6	32	$4.5 \times 8 \times 4.4$	15	15	-5	657	1200	82
	34	6	33	$4.5 \times 8 \times 4.4$	15	15	-7	814	1570	108
	37	6	38	$4.5 \times 8 \times 4.4$	15	15	-7	1230	2350	160
	42	8	43	$5.5 \times 9.2 \times 5.4$	20	20	-9	1400	2750	230
	50	8	51	$5.5 \times 9.2 \times 5.4$	20	20	-9	1560	3140	475
	58	10	60	$6.6 \times 11 \times 6.5$	20	20	-9	2490	5490	575
	64	10	67	$6.6 \times 11 \times 6.5$	25	25	-13	2650	6270	870
	75	13	78	$9 \times 14 \times 8.6$	25	25	-13	3430	8040	1380
	92	13	98	$9 \times 14 \times 8.6$	25	25	-13	6080	15900	3300
	106	18	112	$11 \times 17.5 \times 10.8$	25	25	-13	7650	20000	4060

Model LMK-ML (Stainless Steel Type)

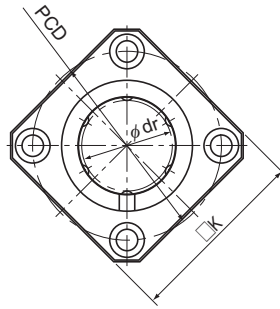

Model LMK-ML

Model No.	Ball rows	Main dimensions							
		Inscribed bore diameter		Outer diameter		Length		Flange diameter	
		dr	Tolerance	D	Tolerance	L	Tolerance	D ₁	Tolerance
LMK 6ML	4	6	0 -0.010	12	0	35	0 -0.3	28	0 -0.2
LMK 8ML	4	8		15	-0.013	45		32	
LMK 10ML	4	10		19	0 -0.016	55		39	
LMK 12ML	4	12		21		57		42	
LMK 13ML	4	13		23		61		43	
LMK 16ML	5	16	28	70	48				
LMK 20ML	5	20	32	0	80	54			
LMK 25ML	6	25	40	0 -0.019	112	0	62		
LMK 30ML	6	30	45		123	-0.4	74		

Note) Since this model contains a synthetic resin retainer, do not use it at temperature exceeding 80°C.
If requiring a type equipped with a seal, indicate it when placing an order.

(Example) LMK8ML UU

└ Seal attached on both ends of the nut

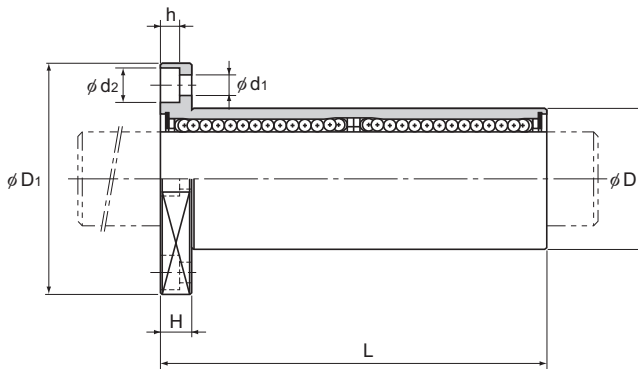

Unit: mm

	K	H	PCD	Mounting hole d ₁ × d ₂ × h	Flange perpendicularity	Eccentricity (max)	Radial clearance tolerance	Basic load rating		Mass g
					μm	μm	μm	C N	C ₀ N	
	22	5	20	3.4 × 6.5 × 3.3	15	15	-5	324	529	26
	25	5	24	3.4 × 6.5 × 3.3	15	15	-5	431	784	46
	30	6	29	4.5 × 8 × 4.4	15	15	-5	588	1100	88
	32	6	32	4.5 × 8 × 4.4	15	15	-5	657	1200	82
	34	6	33	4.5 × 8 × 4.4	15	15	-7	814	1570	108
	37	6	38	4.5 × 8 × 4.4	15	15	-7	1230	2350	160
	42	8	43	5.5 × 9.2 × 5.4	20	20	-9	1400	2750	230
	50	8	51	5.5 × 9.2 × 5.4	20	20	-9	1560	3140	475
	58	10	60	6.6 × 11 × 6.5	20	20	-9	2490	5490	575

Note) Since the nut and the balls use stainless steel, these models are highly resistant to corrosion and environment.

Model LMH

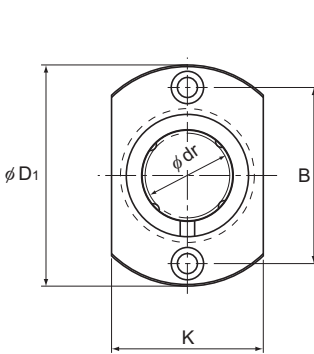

Models LMH6 to 13

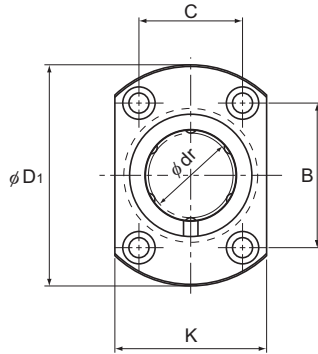

Models LMH16 to 30

Model No.	Ball rows	Main dimensions							
		Inscribed bore diameter		Outer diameter		Length		Flange diameter	
		dr	Tolerance	D	Tolerance	L	Tolerance	D ₁	Tolerance
LMH 6	4	6	0 -0.009	12	0	19	0 -0.2	28	0 -0.2
LMH 8	4	8		15	-0.011	24		32	
LMH 10	4	10		19	0	29		39	
LMH 12	4	12		21	0	30		42	
LMH 13	4	13	23	-0.013	32	43			
LMH 16	5	16	28	0	37	48			
LMH 20	5	20	32	0	42	54			
LMH 25	6	25	40	-0.016	59	0	62		
LMH 30	6	30	45	-0.016	64	-0.3	74		

Note) Since this model contains a synthetic resin retainer, do not use it at temperature exceeding 80°C.
If requiring a type equipped with a seal, indicate it when placing an order.

(Example) LMH16 UU

└─── Seal attached on both ends of the nut

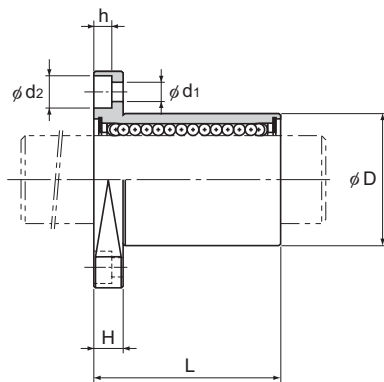

Unit: mm

	K	H	B	C	Mounting hole d ₁ × d ₂ × h	Flange perpendicularity	Eccentricity (max)	Radial clearance tolerance	Basic load rating		Mass g
						μm	μm	μm	C N	C ₀ N	
	18	5	20	—	3.4 × 6.5 × 3.3	12	12	-5	206	265	18
	21	5	24	—	3.4 × 6.5 × 3.3	12	12	-5	265	402	28
	25	6	29	—	4.5 × 8 × 4.4	12	12	-5	373	549	50
	27	6	32	—	4.5 × 8 × 4.4	12	12	-5	412	598	55
	29	6	33	—	4.5 × 8 × 4.4	12	12	-7	510	775	70
	34	6	31	22	4.5 × 8 × 4.4	12	12	-7	775	1180	95
	38	8	36	24	5.5 × 9.2 × 5.4	15	15	-9	863	1370	150
	46	8	40	32	5.5 × 9.2 × 5.4	15	15	-9	980	1570	275
	51	10	49	35	6.6 × 11 × 6.5	15	15	-9	1570	2750	350

Model LMH-L

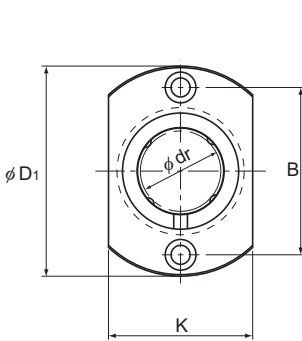

Models LMH6L to 13L

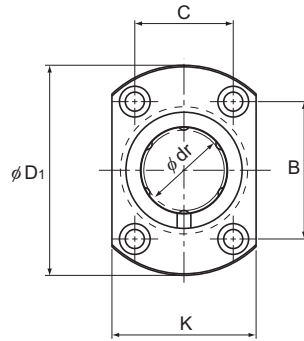

Models LMH16L to 30L

Model No.	Ball rows	Main dimensions							
		Inscribed bore diameter		Outer diameter		Length		Flange diameter	
Standard type		dr	Tolerance	D	Tolerance	L	Tolerance	D ₁	Tolerance
LMH 6L	4	6	0 -0.010	12	0	35	0 -0.3	28	0 -0.2
LMH 8L	4	8		15	-0.013	45		32	
LMH 10L	4	10		19	0 -0.016	55		39	
LMH 12L	4	12		21		57		42	
LMH 13L	4	13		23		61		43	
LMH 16L	5	16	28	70	48				
LMH 20L	5	20	0 -0.012	32	0	80	54		
LMH 25L	6	25	0 -0.019	40	0 -0.019	112	0	62	
LMH 30L	6	30		45		123	-0.4	74	

Note) Since this model contains a synthetic resin retainer, do not use it at temperature exceeding 80°C.
If requiring a type equipped with a seal, indicate it when placing an order.

(Example) LMH20L UU

└─── Seal attached on both ends of the nut

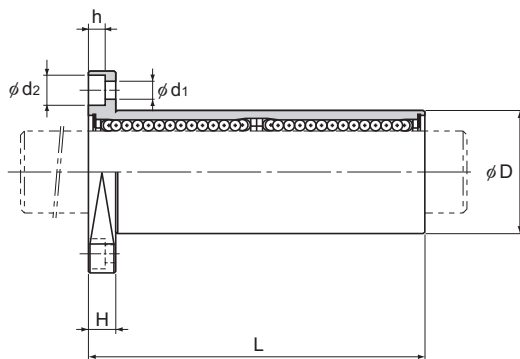

Unit: mm

	K	H	B	C	Mounting hole $d_1 \times d_2 \times h$	Flange perpendicularity	Eccentricity (max)	Radial clearance tolerance	Basic load rating		Mass g
						μm	μm	μm	C N	C_0 N	
	18	5	20	—	$3.4 \times 6.5 \times 3.3$	15	15	-5	324	529	28
	21	5	24	—	$3.4 \times 6.5 \times 3.3$	15	15	-5	431	784	40
	25	6	29	—	$4.5 \times 8 \times 4.4$	15	15	-5	588	1100	75
	27	6	32	—	$4.5 \times 8 \times 4.4$	15	15	-5	657	1200	82
	29	6	33	—	$4.5 \times 8 \times 4.4$	15	15	-7	814	1570	107
	34	6	31	22	$4.5 \times 8 \times 4.4$	15	15	-7	1230	2350	143
	38	8	36	24	$5.5 \times 9.2 \times 5.4$	20	20	-9	1400	2750	225
	46	8	40	32	$5.5 \times 9.2 \times 5.4$	20	20	-9	1560	3140	450
	51	10	49	35	$6.6 \times 11 \times 6.5$	20	20	-9	2490	5490	575

Models SC6 to 30

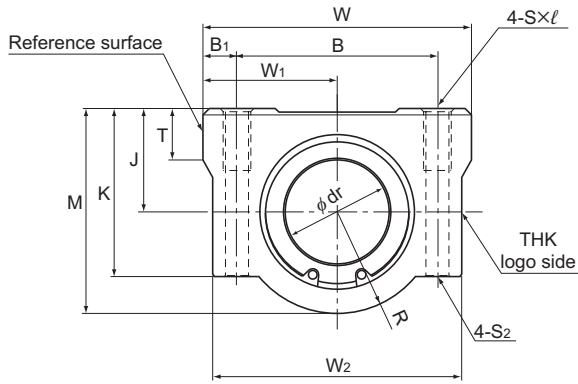

Models SC6 to 30

Model No.	Outer dimensions			LM casing dimensions						
	Height M	Width W	Length L	Mounting hole position			Tap S × l	Through bolt model No, S ₂	Center height J ±0.02	W ₁ ±0.02
				B	B ₁	C				
SC 6UU	18	30	25	20	5	15	M4 × 8	M3	9	15
SC 8UU	22	34	30	24	5	18	M4 × 8	M3	11	17
SC 10UU	26	40	35	28	6	21	M5 × 12	M4	13	20
SC 12UU	29	42	36	30.5	5.75	26	M5 × 12	M4	15	21
SC 13UU	30	44	39	33	5.5	26	M5 × 12	M4	15	22
SC 16UU	38.5	50	44	36	7	34	M5 × 12	M4	19	25
SC 20UU	42	54	50	40	7	40	M6 × 12	M5	21	27
SC 25UU	51.5	76	67	54	11	50	M8 × 18	M6	26	38
SC 30UU	59.5	78	72	58	10	58	M8 × 18	M6	30	39

Note) Since this model contains a synthetic resin retainer, do not use it at temperature exceeding 80°C.
A stainless steel Linear Bushing model LM-MG, which is highly corrosion resistant, can also be incorporated at your request.

Example of Model Number for Use in Combination with
Linear Bushing Units

Linear Bushing to be combined	Example of model No.	
Both end attached with seal	SC 13UU	Standard stock
Without seal	SC 13	Build to order
Made of stainless steel; both end attached with seal	SC 13MUU	Build to order

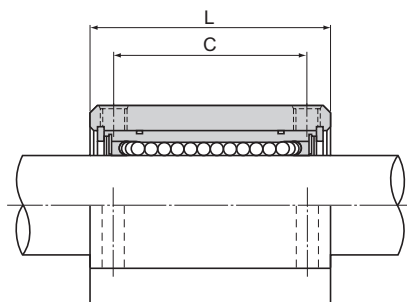

Unit: mm

							Model No. of Linear Bushing to be combined	Basic load rating		Unit
					Inscribed bore diameter			C	C ₀	Mass g
K	W ₂	T	R	dr	Tolerance	N		N		
15	28	6	9	6	0 -0.009	LM6UU	206	265	34	
18	32	6	11	8		LM8UU	265	402	52	
22	37	8	13	10		LM10UU	373	549	92	
25	39	8	14	12		LM12UU	412	598	102	
26	41	8	15	13		LM13UU	510	775	123	
35	46	9	19.5	16		LM16UU	775	1180	189	
36	52	11	21	20	0 -0.010	LM20UU	863	1370	237	
41	68	12	25.5	25		LM25UU	980	1570	555	
49	72	15	29.5	30		LM30UU	1570	2750	685	

Models SC35 to 50

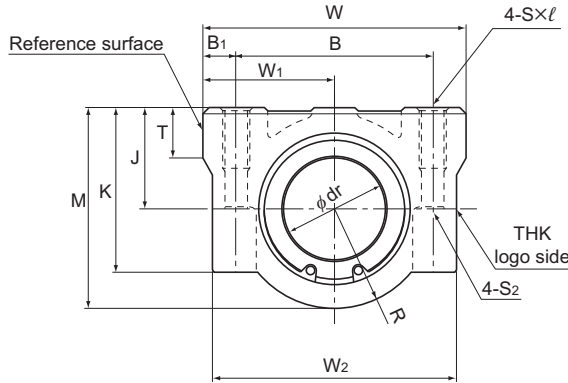

Models SC35 to 50

Model No.	Outer dimensions			LM casing dimensions							
	Height M	Width W	Length L	Mounting hole position			Tap S × ℓ	Through bolt model No., S ₂	Center height J ±0.02	W ₁ ±0.02	K
				B	B ₁	C					
SC 35UU	68	90	80	70	10	60	M8 × 18	M6	34	45	54
SC 40UU	78	102	90	80	11	60	M10 × 25	M8	40	51	62
SC 50UU	102	122	110	100	11	80	M10 × 25	M8	52	61	80

Note) Since this model contains a synthetic resin retainer, do not use it at temperature exceeding 80°C.

A stainless steel Linear Bushing model LM-MG, which is highly corrosion resistant, can also be incorporated at your request. (Model SC50 does not include a stainless type.)

Example of Model Number for Use in Combination with Linear Bushing Units

Linear Bushing to be combined	Example of model No.	
Both end attached with seal	SC 40UU	Standard stock
Without seal	SC 40	Build to order
Made of stainless steel; both end attached with seal	SC 40MUU	Build to order

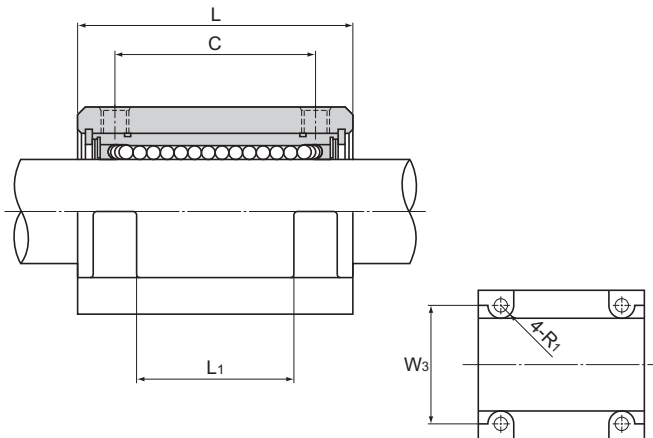

Unit: mm

	W ₂	W ₃	L ₁	T	R	R ₁	Inscribed bore diameter		Model No. of Linear Bushing to be combined	Basic load rating		Unit
							dr	Tolerance		C	C ₀	Mass
	85	60	42	18	34	5	35	0 -0.012	LM35UU	1670	3140	1100
	96	80	44	20	38	8	40		LM40UU	2160	4020	1600
	116	100	64	25	50	8	50		LM50UU	3820	7940	3350

Model SL

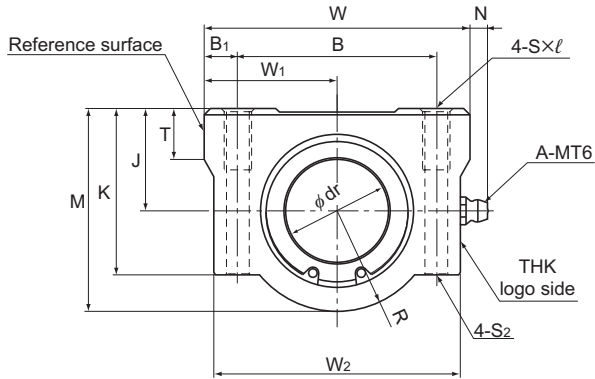

Model SL

Model No.	Outer dimensions			LM casing dimensions						
	Height	Width	Length	Mounting hole position			Tap	Through bolt	Center height	W ₁ ±0.02
	M	W	L	B	B ₁	C	S × ℓ	model No. S ₂	J ±0.02	
SL 6UU	18	30	48	20	5	36	M4 × 8	M3	9	15
SL 8UU	22	34	58	24	5	42	M4 × 8	M3	11	17
SL 10UU	26	40	68	28	6	46	M5 × 12	M4	13	20
SL 12UU	29	42	70	30.5	5.75	50	M5 × 12	M4	15	21
SL 13UU	30	44	75	33	5.5	50	M5 × 12	M4	15	22
SL 16UU	38.5	50	85	36	7	60	M5 × 12	M4	19	25
SL 20UU	42	54	96	40	7	70	M6 × 12	M5	21	27
SL 25UU	51.5	76	130	54	11	100	M8 × 18	M6	26	38
SL 30UU	59.5	78	140	58	10	110	M8 × 18	M6	30	39

Note) Since this model contains a synthetic resin retainer, do not use it at temperature exceeding 80°C.
A stainless steel Linear Bushing model LM-MG, which is highly corrosion resistant, can also be incorporated at your request.

Example of Model Number for Use in Combination with
Linear Bushing Units

Linear Bushing to be combined	Example of model No.	
Both end attached with seal	SL 13UU	Standard stock
Without seal	SL 13	Build to order
Made of stainless steel; both end attached with seal	SL 13MUU	Build to order

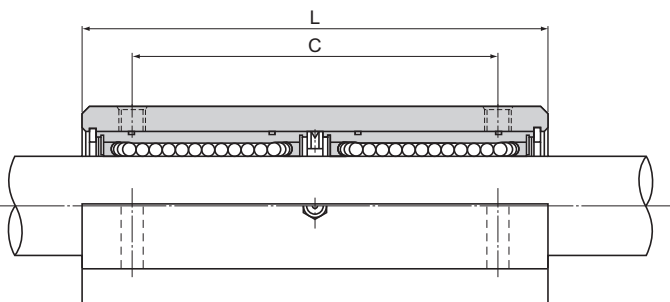

Unit: mm

	K	W ₂	T	R	N	Inscribed bore diameter		Model No. of Linear Bushing to be combined	Basic load rating		Unit
						dr	Tolerance		C	C ₀	Mass
	15	28	6	9	7	6	0 -0.009	LM6U	324	529	68
	18	32	6	11	7	8		LM8U	431	784	105
	22	37	8	13	7	10		LM10U	588	1100	185
	25	39	8	14	6.5	12		LM12U	657	1200	205
	26	41	8	15	6.5	13		LM13U	814	1570	242
	35	46	9	19.5	6	16		LM16U	1230	2350	403
	36	52	11	21	7	20	0 -0.010	LM20U	1400	2750	520
	41	68	12	25.5	4	25		LM25U	1560	3140	1120
	49	72	15	29.5	5	30		LM30U	2490	5490	1440

Model SH

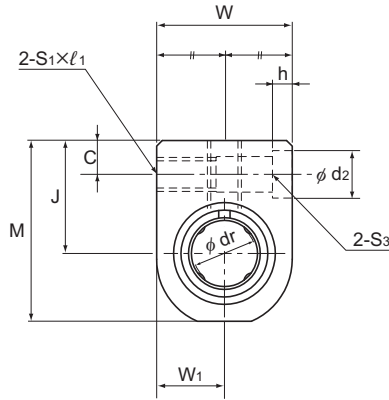

Model SH

Model No.	Outer dimensions			LM casing dimensions					
	Height M	Width W	Length L	Mounting hole position			Tap		Through bolt model No, S ₃
				B	B ₁	C	S ₁ × l ₁	S ₂ × l	
SH 3UU	14	10	13	—	8	3	M3 × 6	M3 × 5.5	M2
SH 4UU	16	12	15	—	10	3	M3 × 6	M3 × 6	M2
SH 5UU	18	14	17	—	12	3	M3 × 6	M3 × 6	M2
SH 6UU	22	16	24	18	9	5	M4 × 8	M4 × 8	M3
SH 8UU	26	20	27	20	10	5	M4 × 8	M5 × 8.5	M3
SH 10UU	32	26	35	27	15	6	M5 × 10	M6 × 9.5	M4
SH 12UU	34	28	35	27	15	6	M5 × 10	M6 × 9.5	M4
SH 13UU	36	30	36	28	16	6	M5 × 10	M6 × 9.5	M4
SH 16UU	42	36	40	32	18	6	M5 × 10	M6 × 10	M4
SH 20UU	49	42	44	36	22	7	M6 × 12	M6 × 12	M5

Note) Since this model contains a synthetic resin retainer, do not use it at temperature exceeding 80°C.

A stainless steel Linear Bushing model LM-MG, which is highly corrosion resistant, can also be incorporated at your request.

Example of Model Number for Use in Combination with Linear Bushing Units

Linear Bushing to be combined	Example of model No.	
Both end attached with seal	SH 13UU	Standard stock
Without seal	SH 13	Build to order
Made of stainless steel; both end attached with seal	SH 13MUU	Build to order

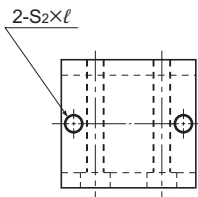
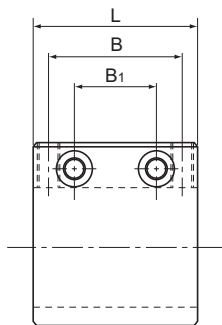

Top surface of models SH6 to SH20

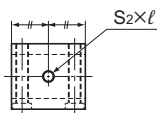

Top surface of models SH3 to SH5

Unit: mm

	Center height J ±0.02	W ₁ ±0.02	d ₂	h	Inscribed bore diameter		Model No. of Linear Bushing to be combined	Basic load rating		Unit	
					dr	Tolerance		C	C ₀	Mass g	
								N	N		
	9	5	4.2	1.5	3	0 -0.008	LM3UU	88.2	108	4.5	
	10	6	4.2	1.5	4		LM4UU	88.2	127	7	
	11	7	4.2	1.5	5		LM5UU	167	206	11	
	14	8	6.5	3.3	6	0 -0.009	LM6UU	206	265	21.6	
	16	10	6.5	3.3	8		LM8UU	265	402	32	
	19	13	8	4.4	10		LM10UU	373	549	65	
	20	14	8	4.4	12		LM12UU	412	598	81	
	21	15	8	4.4	13		LM13UU	510	775	90	
	24	18	8	4.4	16		LM16UU	775	1180	150	
	28	21	9.5	5.4	20		0 -0.010	LM20UU	863	1370	215

Model SH-L

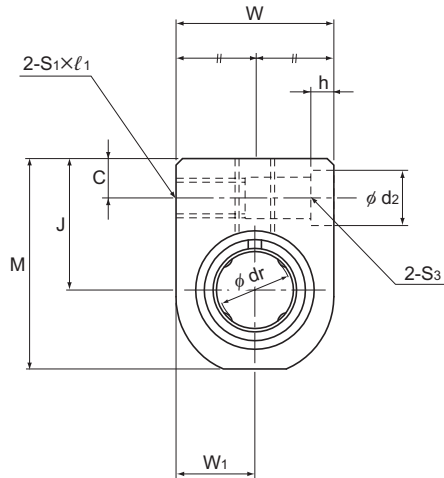

Model SH-L

Model No.	Outer dimensions			LM casing dimensions					
	Height	Width	Length	Mounting hole position			Tap		Through bolt model No, S ₃
	M	W	L	B	B ₁	C	S ₁ × ℓ ₁	S ₂ × ℓ	
SH 3LUU	14	10	23	10	18	3	M3 × 6	M3 × 5.5	M2
SH 4LUU	16	12	27	14	22	3	M3 × 6	M3 × 6	M2
SH 5LUU	18	14	32	18	26	3	M3 × 6	M3 × 6	M2
SH 6LUU	22	16	40	20	30	5	M4 × 8	M4 × 8	M3
SH 8LUU	26	20	52	30	42	5	M4 × 8	M5 × 8.5	M3
SH 10LUU	32	26	60	36	50	6	M5 × 10	M6 × 9.5	M4
SH 12LUU	34	28	62	36	50	6	M5 × 10	M6 × 9.5	M4
SH 13LUU	36	30	66	40	54	6	M5 × 10	M6 × 9.5	M4
SH 16LUU	42	36	76	52	66	6	M5 × 10	M6 × 10	M4
SH 20LUU	49	42	86	58	72	7	M6 × 12	M6 × 12	M5

Note) Since this model contains a synthetic resin retainer, do not use it at temperature exceeding 80°C.

A stainless steel Linear Bushing model LM-MG, which is highly corrosion resistant, can also be incorporated at your request.

Example of Model Number for Use in Combination with Linear Bushing Units

Linear Bushing to be combined	Example of model No.	
Both end attached with seal	SH 13LUU	Standard stock
Without seal	SH 13L	Build to order
Made of stainless steel; both end attached with seal	SH 13MLUU	Build to order

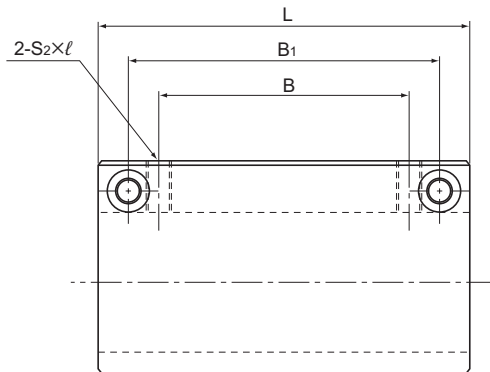

Unit: mm

	Center height J ±0.02	W _i ±0.02	d ₂	h	Inscribed bore diameter		Model No. of Linear Bushing to be combined	Basic load rating		Unit
					dr	Tolerance		C	C ₀	Mass
	9	5	4.2	1.5	3	0 -0.008	LM3U	139	216	8.5
	10	6	4.2	1.5	4		LM4U	139	254	13
	11	7	4.2	1.5	5		LM5U	263	412	22
	14	8	6.5	3.3	6	0 -0.009	LM6U	324	529	35
	16	10	6.5	3.3	8		LM8U	431	784	65
	19	13	8	4.4	10		LM10U	588	1100	125
	20	14	8	4.4	12		LM12U	657	1200	155
	21	15	8	4.4	13		LM13U	814	1570	190
	24	18	8	4.4	16		LM16U	1230	2350	295
	28	21	9.5	5.4	20	0 -0.010	LM20U	1400	2750	425

Model SK

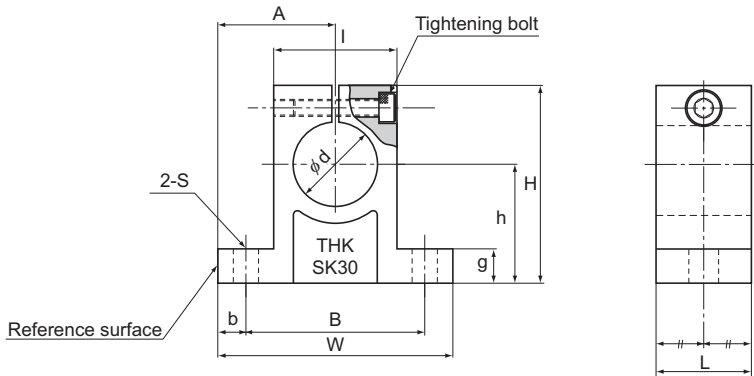

Unit: mm

Model No.	Main dimensions													Mass g
	H	W	L	B	S	Mounting bolt model No.	h ± 0.02	A ± 0.05	b	g	l	Shaft diameter d	Tightening bolt model No.	
SK 10	32.8	42	14	32	5.5	M5	20	21	5	6	18	10	M4	24
SK 12	37.5	42	14	32	5.5	M5	23	21	5	6	20	12	M4	30
SK 13	37.5	42	14	32	5.5	M5	23	21	5	6	20	13	M4	30
SK 16	44	48	16	38	5.5	M5	27	24	5	8	25	16	M4	40
SK 20	51	60	20	45	6.6	M6	31	30	7.5	10	30	20	M5	70
SK 25	60	70	24	56	6.6	M6	35	35	7	12	38	25	M6	130
SK 30	70	84	28	64	9	M8	42	42	10	12	44	30	M6	180
SK 35	83	98	32	74	11	M10	50	49	12	15	50	35	M8	270
SK 40	96	114	36	90	11	M10	60	57	12	15	60	40	M8	420

Dedicated Shafts for Model LM

The LM shaft of the Linear Bushing needs to be manufactured with much consideration for hardness, surface roughness and dimensional accuracy of the shaft since balls roll directly on it. THK manufactures dedicated LM shafts for the Linear Bushing. See the specification table for standard LM shafts on **A4-82**.

Among other factors, the surface hardness of an LM shaft affects the service life of your Linear Bushing system most significantly. Therefore, take much care in selecting a material and a heat treatment method when assembling the system. In addition, as the surface hardness of the LM shaft greatly affects the service life as stated above, use care in selecting and/or handling a material and heat treatment.

[Material]

Generally, the following materials are used for surface hardening through induction-hardening.

- SUJ2 (JIS G 4805: high-carbon chromium bearing steel)
- SK3 to 6 (JIS G 4401: carbon tool steel)
- S55C (JIS G 4051: carbon steel for machine structural use)

For special applications, martensite stainless steel SUS440C, which is corrosion resistant, may also be used.

[Hardness]

We recommend surface hardness of 58 HRC (\approx 653 HV) or higher. The depth of the hardened layer is determined by the size of the Linear Bushing; we recommend approximately 2 mm for general use.

[Surface Roughness]

To achieve smooth motion, the surface should preferably be finished to 0.40a or less.

[Dimensions of Hollow LM Shafts]

If a hollow LM shaft is required for purposes such as weight reduction, use the desired material from Table1 for the dimensions of hollow LM shafts that THK keeps in stock.

Models marked with “*” are build-to-order items.

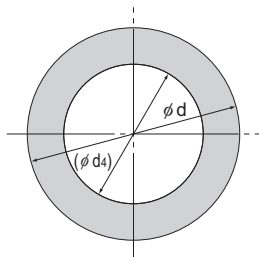

Table1 Dimensions of Hollow LM Shafts Unit: mm

Supported model numbers	LM shaft outer diameter d	Inner diameter (φda)	Mass (kg/m)	
			Solid shaft	Hollow shaft
LM 8	8	3	0.4	0.34
LM 10	10	4	0.62	0.52
LM 12	12	6	0.89	0.67
LM 13	13	7	1.05	0.75
LM 16	16	9	1.59	1.09
LM 20	20	10	2.47	1.86
LM 20	20	14	2.47	1.26
LM 25	25	15	3.86	2.47
LM 30	30	16	5.56	3.98
LM 35	35	20	7.57	5.1
* LM 38	38	22	8.92	5.93
LM 40	40	22	9.88	6.89
LM 50	50	25	15.5	11.6
LM 60	60	32	22.3	16.0
* LM 80	80	52.5	39.6	22.5
* LM 100	100	67.5	61.8	33.7

Standard LM Shafts

THK manufactures high quality, dedicated LM shafts for Linear Bushing model LM series.

Model number coding

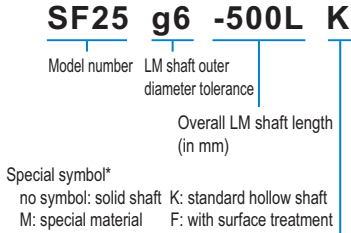

*If two or more symbols are given, they are shown in an alphabetical order.

- [Major materials]
THK5SP (THK standard material)
SUJ2 (high-carbon chromium bearing steel)
[Hardness]
HRC58 to 64
[Hardened layer depth]
0.8 to 2.5mm (varies with shaft diameter)
[Surface roughness]
0.20a to 0.40a
[Straightness of the LM shaft]
50 μ m/300 mm or less
- Precision-grade LM shafts with shaft diameter tolerance of g5 or h5 are also manufactured as standard.
- Corrosion resistance, martensite stainless steel LM shafts are also available.
- When asking an estimate or placing an order, refer to the model number coding shown on the left.



Model No.	Shaft diameter		Overall LM shaft length: L mm													Supported model numbers	
	d	Tolerance g μ m	100	200	300	400	500	600	700	800	1000	1200	1300	1500	2000		3000
SF 3	3	$-\frac{2}{8}$	⊙	⊙													LM 3
SF 4	4		⊙	⊙													LM 4
SF 5	5	-4	⊙	⊙	⊙												LM 5
SF 6	6	-12	⊙	⊙	⊙	⊙											LM 6
SF 8	8	-5	⊙	⊙	⊙	⊙	⊙										LM 8, 8S
SF 10	10	-14	⊙	⊙	⊙	⊙	⊙	⊙	⊙								LM 10
SF 12	12			⊙	⊙	⊙	⊙		⊙	⊙							LM 12
SF 13	13	-6	⊙	⊙	⊙	⊙	⊙	⊙	⊙	⊙							LM 13
SF 16	16	-17	⊙	⊙	⊙	⊙	⊙	⊙	⊙	⊙	⊙			⊙			LM 16
SF 20	20			⊙	⊙	⊙	⊙	⊙	⊙	⊙	⊙	⊙	⊙				LM 20
SF 25	25	-7		⊙	⊙	⊙	⊙	⊙	⊙	⊙	⊙	⊙	⊙				LM 25
SF 30	30	-20			⊙	⊙	⊙	⊙	⊙	⊙	⊙	⊙	⊙	⊙			LM 30
SF 35	35						⊙	⊙		⊙	⊙			⊙	⊙		LM 35
SF 38	38	-9						⊙			⊙	⊙			⊙		LM 38
SF 40	40	-25					⊙	⊙	⊙	⊙	⊙	⊙	⊙	⊙	⊙	⊙	LM 40
SF 50	50						⊙	⊙		⊙	⊙	⊙	⊙	⊙	⊙	⊙	LM 50
SF 60	60	-10								⊙	⊙				⊙	⊙	LM 60
SF 80	80	-29									⊙	⊙			⊙	⊙	LM 80
SF 100	100	$-\frac{12}{34}$									⊙	⊙			⊙	⊙	LM 100

Note) ⊙ indicates standard stock; ○ indicates semi-standard stock.

Specially Machined Types

THK also supports special machining processes such as tapping, milling, threading, through hole and end journals, as shown in the Fig.1, at your request.

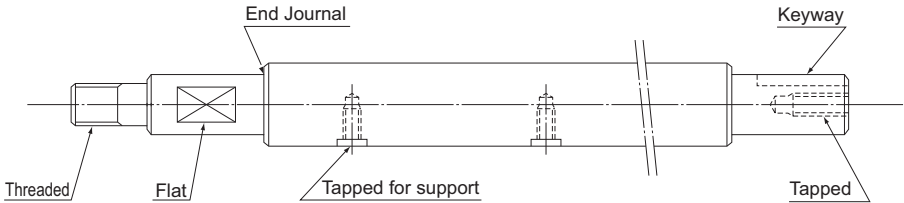

Fig.1

Table of Rows of Balls and Masses for Clearance-adjustable Types and Open Types of the Linear Bushing

Shaft diameter	Clearance-adjustable type			Open type		
	Model No.	Rows of balls	Mass g	Model No.	Rows of balls	Mass g
6	LM 6-AJ	4	7.8	—	—	—
8	LM 8S-AJ	4	10	—	—	—
	LM 8-AJ	4	14.7	—	—	—
10	LM 10-AJ	4	29	—	—	—
12	LM 12-AJ	4	31	LM 12-OP	3	25
13	LM 13-AJ	4	42	LM 13-OP	3	34
16	LM 16-AJ	5(4)	68	LM 16-OP	4(3)	52
20	LM 20-AJ	5	85	LM 20-OP	4	69
25	LM 25-AJ	6(5)	216	LM 25-OP	5(4)	188
30	LM 30-AJ	6	245	LM 30-OP	5	210
35	LM 35-AJ	6	384	LM 35-OP	5	350
38	LM 38-AJ	6	475	LM 38-OP	5	400
40	LM 40-AJ	6	579	LM 40-OP	5	500
50	LM 50-AJ	6	1560	LM 50-OP	5	1340
60	LM 60-AJ	6	1820	LM 60-OP	5	1650
80	LM 80-AJ	6	4320	LM 80-OP	5	3750
100	LM 100-AJ	6	8540	LM 100-OP	5	7200
120	LM 120-AJ	8	14900	LM 120-OP	6	11600

Note) The numbers of ball rows in the table apply to types using a resin retainer. Those of types using a metal retainer are indicated in parentheses.

Assembling the Linear Bushing

[Inner Diameter of the Housing]

Table1 shows recommended housing inner-diameter tolerance for the Linear Bushing. When fitting the Linear Bushing with the housing, loose fit is normally recommended. If the clearance needs to be smaller, provide transition fit.

Table1 Housing Inner-diameter Tolerance

Type		Housing	
Model No.	Accuracy	Loose fit	Transition fit
LM	High accuracy grade (no symbol)	H7	J7
	Precision Grade (P)	H6	J6
LME	—	H7	K6, J6
LMF	High accuracy grade (no symbol)	H7	J7
LMK			
LMH			
LM-L			
LMF-L			
LMK-L			
LMH-L			

[Clearance between the Nut and the LM Shaft]

When using the Linear Bushing in combination with an LM shaft, use normal clearance in ordinary use and small gap if the clearance is to be minimized.

Note1) If the clearance after installation is to be negative, it is preferable not to exceed the radial clearance tolerance indicated in the specification table.

Note2) The shaft tolerance for Linear Bushing models SC, SL SH and SH-L falls under high accuracy grade (no symbol).

Table2 Shaft Outer-diameter Tolerance

Type		LM Shaft	
Model No.	Accuracy	Normal clearance	Small gap
LM	High accuracy grade (no symbol)	f6, g6	h6
	Precision Grade (P)	f5, g5	h5
LME	—	h7	k6
LMF	High accuracy grade (no symbol)	f6, g6	h6
LMK			
LMH			
LM-L			
LMF-L			
LMK-L			
LMH-L			

[Mounting the Nut]

Although the Linear Bushing does not require a large amount of strength for securing it in the axial direction, do not rely only on a press fit to support the nut. For the housing inner-diameter tolerance, see Table1 on **A4-84**.

- **Installing the Standard Type**

Fig.1 and Fig.2 show examples of installing the standard type Linear Bushing.

When securing the Linear Bushing, use snap rings or stopper plates.

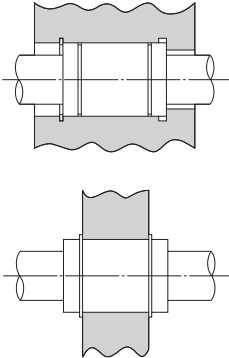

Fig.1 Snap Ring

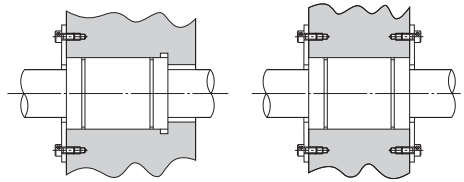

Fig.2 Stopper Plate

■Snap Ring for Installation

To secure Linear Bushing model LM, snap rings indicated in Table3 are available.

Note1) For models indicated with parentheses, use C-shape concentric snap rings.

Note2) The Table3 commonly applies to models LM, LM-GA, LM-MG and LM-L.

Table3 Types of Snap Rings

Model No.	Snap ring			
	For outer surface		For inner surface	
	Needle snap ring	C-shape snap ring	Needle snap ring	C-shape snap ring
LM 3	—	—	AR 7	—
LM 4	—	—	8	—
LM 5	WR 10	10	10	10
LM 6	12	12	12	12
LM 8	—	15	15	15
LM 8S	—	15	15	15
LM 10	19	19	19	19
LM 12	21	21	21	21
LM 13	23	22	23	—
LM 16	28	—	28	28
LM 20	32	—	32	32
LM 25	40	40	40	40
LM 30	45	45	45	45
LM 35	52	52	52	52
LM 38	—	56·58	57	—
LM 40	—	60	60	60
LM 50	—	80	80	80
LM 60	—	90	90	90
LM 80A	—	120	120	120
LM 100A	—	(150)	150	—
LM 120A	—	(180)	180	—

■Set Screws Not Allowed

Securing the nut by pressing the outer surface with one set screw as shown in Fig.3 will cause the nut to be deformed.

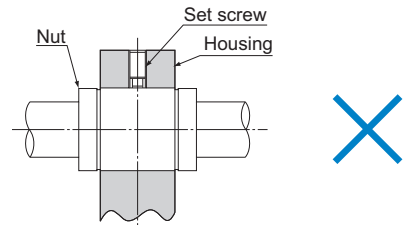
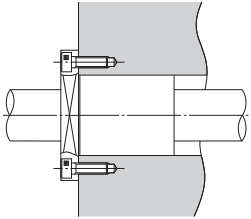

Fig.3

● Installing a Flanged Type

With models LMF, LMK and LMH, the nut is integrated with a flange. Therefore, the Linear Bushing can be mounted only via the flange.



Nut mounted via socket and spigot joint

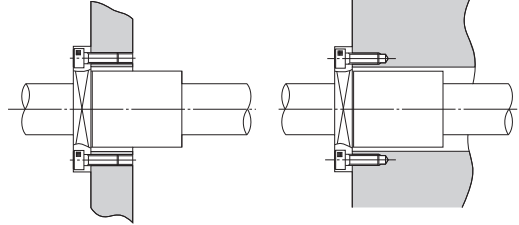

Mounted via a flange only

● Installing a Clearance-adjustable Type

To adjust the clearance of a clearance-adjustable type (-AJ), use a housing that allows adjustment of the nut outer diameter so as to facilitate the adjustment of the clearance between the Linear Bushing and the LM shaft. Positioning the slit of the Linear Bushing at an angle of 90° with the housing's slit will provide uniform deformation in the circumferential direction. (See Fig.4.)

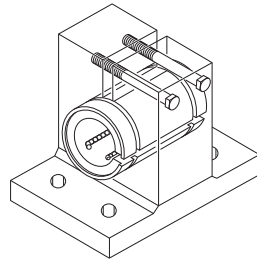

Fig.4

● Mounting an Open Type

For an open type (-OP), also use a housing that allows adjustment of the nut outer diameter as shown in Fig.5.

Open types are normally used with a light preload. Be sure not to give an excessive preload.

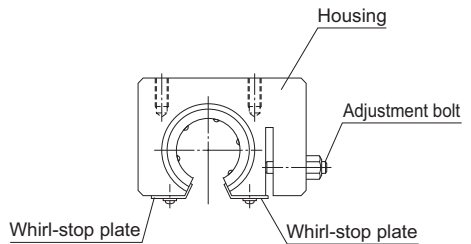
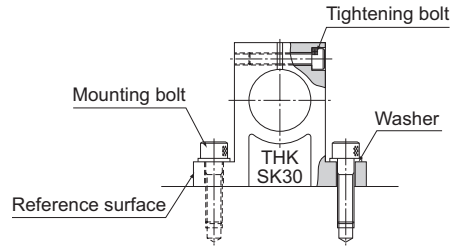

Fig.5

[Mounting the Shaft End Support]

Shaft end support model SK can easily be secured to the table using mounting bolts. Model SK enables the LM shaft to firmly be secured using tightening bolts.



[Installing an LM Case Unit]

● Attaching Model SC (SL)

Since models SC and SL can be attached from the top or bottom by simply tightening it using bolts, the installation time can be shortened. (See Fig.6.)

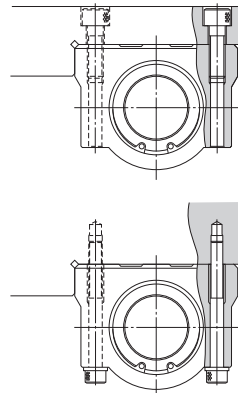

Fig.6

● Attaching Model SH (SH-L)

Since models SH and SH-L can be attached from the top or bottom by simply tightening it using bolts, the installation time can be shortened. (See Fig.7.)

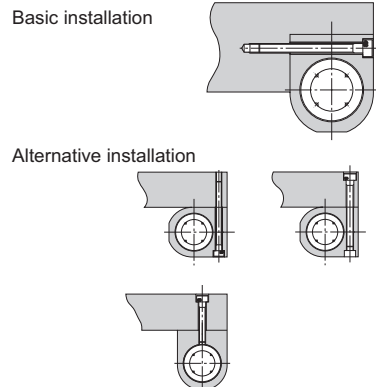

Fig.7

[Incorporating the Nut]

When incorporating the standard Linear Bushing into a housing, use a jig and drive in the nut, or use a flatter plate and gently hit the nut, instead of directly hitting the side plate or the seal. (See Fig.8.)

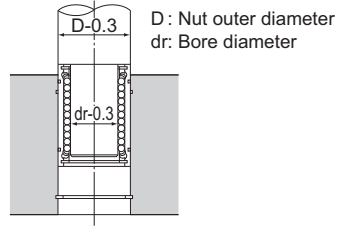

Fig.8

[Inserting the LM Shaft]

When inserting the LM shaft into the Linear Bushing, align the center of the shaft with that of the nut and gently insert the shaft straightforward into the nut. If the shaft is slanted while it is inserted, balls may fall off or the retainer may be deformed. (See Fig.9.)

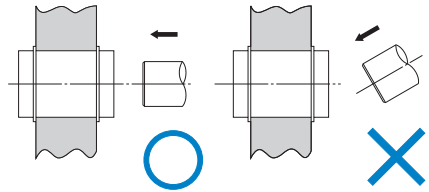

Fig.9

[When Under a Moment Load]

When using the Linear Bushing, make sure the load is evenly distributed on the whole ball raceway. In particular, if a moment load is applied, use two or more Linear Bushing units on the same LM shaft and secure an adequately large distance between the units.

If using the Linear Bushing under a moment load, also calculate the equivalent radial load and identify the correct model number. (See **A4-36**.)

[Rotational Use Not Allowed]

The Linear Bushing is not suitable for rotational use for a structural reason. (See Fig.10.)

Forcibly rotating it may cause an unexpected accident.

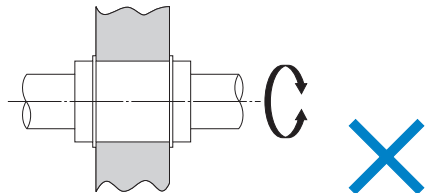

Fig.10

[Precautions on Installing an Open Three-ball-row Type Linear Bushing]

When installing an open three-ball-row type Linear Bushing, mount it while taking into account the load distribution as indicated in Fig.11.

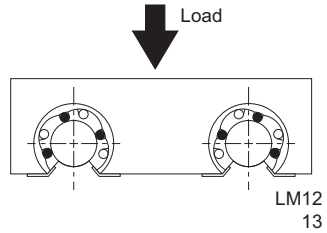

Fig.11

[Attaching Felt Seal Model FLM]

The felt seal can be press-fit into a housing finished to H7, but cannot be used as a stopper for preventing the Linear Bushing from coming off. Be sure to use the felt seal by attaching it as indicated in the Fig.12.

Also make sure to impregnate the felt with sufficient lubricant before attaching it.

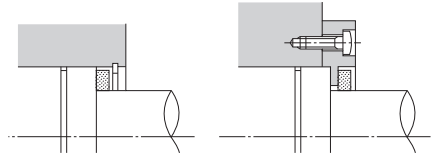

Fig.12

Lubrication

The Linear Bushing requires grease or oil as a lubricant for its operation.

[Grease Lubrication]

When installing a type attached with seals on both sides (...UU) to the LM shaft, apply grease to rows of balls in the Linear Bushing.

When installing standard types (without seal), perform the same as above or apply grease to the LM shaft.

Afterward, replenish grease of the same type as necessary according to the service conditions.

We recommend using high-quality lithium-soap group grease No. 2.

[Oil Lubrication]

Turbine oil, machine oil and spindle oil are commonly used as a lubricant.

When oiling the Linear Bushing, drop oil on the LM shaft, or infuse it from the greasing hole on the housing as shown in Fig.1.

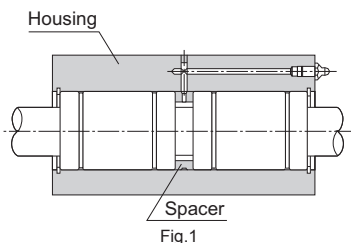

Material and Surface Treatment

For the Linear Bushing and the LM shaft, highly corrosion-resistant stainless steel types are available for some models.

Although the LM shaft can be surface treated, some types may not be suitable for the treatment. Contact THK for details.

Dust prevention

Entrance of dust or other foreign material into the Linear Bushing will cause abnormal wear or shorten the service life. When entrance of dust or other foreign material is a possibility, it is important to select effective seals and/or a dust-control device that meets the service environment conditions.

For the Linear Bushing, a special synthetic rubber seal that is highly resistant to wear and a felt seal (highly dust preventive with low seal resistance) are available as contamination protection accessories.

In addition, THK produces round bellows. Contact us for details.

Felt Seal Model FLM

Linear Bushing model LM series include types equipped with a special synthetic rubber seal (LM...UU, U). If desiring to have an additional contamination protection measure, or desiring to lower the seal resistance, use the felt seal model FLM. (See Table1)

[Dimensions of the Felt Seal]

Table1 Major Dimensions of FLM

Unit: mm

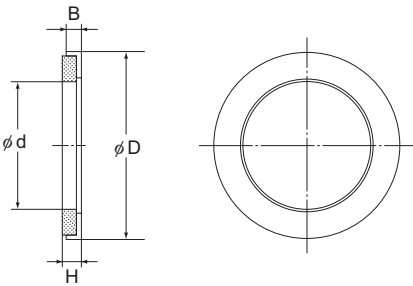

Supported model numbers	Main dimensions				Supported linear bushing model
	d	D	B	H	
FLM 6	6	12	2	2	LM 6
FLM 8	8	15	2	2	LM 8
FLM 10	10	19	3	3	LM 10
FLM 12	12	21	3	3	LM 12
FLM 13	13	23	3	3	LM 13
FLM 16	16	28	4	5	LM 16
FLM 20	20	32	4	5	LM 20
FLM 25	25	40	5	6	LM 25
FLM 30	30	45	5	6	LM 30
FLM 35	35	52	5	6	LM 35
FLM 38	38	57	5	6	LM 38
FLM 40	40	60	5	6	LM 40
FLM 50	50	80	10	11	LM 50
FLM 60	60	90	10	11	LM 60
FLM 80	80	120	10	11	LM 80
FLM 100	100	150	10	11	LM 100

Model Number Coding

Model number configurations differ depending on the model features. Refer to the corresponding sample model number configuration.

[Linear Bushing]

- Plastic resin cages Standard type

models LM, LM-L, LME, LMF, LMF-L, LMK, LMK-L, LMH, LMH-L, SC, SL, SH, SH-L

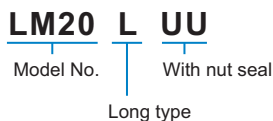

- Plastic resin cages Stainless steel type

models LM-M, LM-MG, LMF-M, LMF-ML, LMK-M, LMK-ML



- Metal cage type

models LM-GA, LM-MGA, LME-GA



[LM Shaft End Support]

● Model SK

SK20

Model No.

[LM Shaft]

● Model SF

SF25 g6 -500L K

Model No.	LM shaft outer diameter tolerance		Special symbol* no symbol: solid shaft K: standard hollow shaft M: special material F: with surface treatment
	Overall LM shaft length (in mm)		

*If two or more symbols are given, they are shown in an alphabetical order.

*For information shaft diameters, permissible shaft diameter error and standard stock lengths, see **A4-82**.

[Felt Seal]

● Model FLM

FLM 20

Model No.

Notes on Ordering

For high temperature applications, a double-ended nut seal (symbol: UU) can be fitted to linear bushes for metal cages (symbol: A). However, cages without seals are recommended since the seal is only heat resistant to a temperature of 80°C.

[Handling]

- (1) Disassembling components may cause dust to enter the system or degrade mounting accuracy of parts. Do not disassemble the product.
- (2) Dropping or hitting the Linear Bushing may damage it. Giving an impact force to the product could also cause damage even if the product looks intact.

[Lubrication]

- (1) Thoroughly remove anti-rust oil and feed lubricant before using the product.
- (2) Do not mix lubricants of different physical properties.
- (3) In locations exposed to constant vibrations or in special environments such as clean rooms, vacuum and low/high temperature, normal lubricants may not be used. Contact THK for details.
- (4) When planning to use a special lubricant, contact THK before using it.

[Precautions on Use]

- (1) Entrance of foreign material may cause damage to the ball circulating component or functional loss. Prevent foreign material, such as dust or cutting chips, from entering the system.
- (2) Do not use the product at temperature of 80°C or higher. Contact THK if you desire to use the product at a temperature of 80°C or higher.
- (3) Please be careful when using the product in an environment with excessive coolant. The coolant may cause premature failure if it penetrates the Linear Bushing. Contact THK for further details.
- (4) If foreign material adheres to the product, replenish the lubricant after cleaning the product.
- (5) When using the product in locations exposed to constant vibrations or in special environments such as clean rooms, vacuum and low/high temperature, contact THK in advance.

[Storage]

When storing the Linear Bushing, enclose it in a package designated by THK and store it while avoiding high temperature, low temperature and high humidity.



Guide Ball Bushing/Linear Bushing

THK General Catalog

Guide Ball Bushing/Linear Bushing

THK General Catalog

B Support Book

Features and Types	B 4-4	Precautions on Use	B 4-46
Features of the Guide Ball Bushing	B 4-4		
• Structure and Features	B 4-4		
• Examples of Changing the Linear Bushing to the Guide Ball Bushing ..	B 4-6		
Types of the Guide Ball Bushing	B 4-7		
• Types and Features	B 4-7		
Point of Selection	B 4-8		
Flowchart for Selecting a Guide Ball Bushing ..	B 4-8		
• Steps for Selecting a Guide Ball Bushing ..	B 4-8		
Rated Load and Nominal Life	B 4-9		
Precautions To Be Taken if an Eccentric Load Is Applied ..	B 4-12		
Mounting Procedure and Maintenance ..	B 4-13		
Assembling the Guide Ball Bushing	B 4-13		
Options	B 4-16		
Dust prevention	B 4-16		
Model No.	B 4-17		
• Model Number Coding	B 4-17		
Precautions on Use	B 4-18		
Features and Types	B 4-20		
Features of the Linear Bushing	B 4-20		
• Structure and Features	B 4-20		
Types of the Linear Ball Bushing	B 4-22		
• Types and Features	B 4-22		
Classification Table	B 4-28		
Point of Selection	B 4-30		
Flowchart for Selecting a Linear Bushing ..	B 4-30		
• Steps for Selecting a Linear Bushing	B 4-30		
Rated Load and Nominal Life	B 4-31		
Precautions To Be Taken if an Eccentric Load Is Applied ..	B 4-34		
Mounting Procedure and Maintenance ..	B 4-35		
Assembling the Linear Bushing	B 4-35		
Lubrication	B 4-41		
Options	B 4-42		
Material and Surface Treatment	B 4-42		
Dust prevention	B 4-43		
Felt Seal Model FLM	B 4-43		
Model No.	B 4-44		
• Model Number Coding	B 4-44		
• Notes on Ordering	B 4-45		

A Product Descriptions (Separate)

Features and Types	A4-4
Features of the Guide Ball Bushing	A4-4
• Structure and Features	A4-4
• Examples of Changing the Linear Bushing to the Guide Ball Bushing ..	A4-6
Types of the Guide Ball Bushing	A4-7
• Types and Features	A4-7
Point of Selection	A4-8
Flowchart for Selecting a Guide Ball Bushing ..	A4-8
• Steps for Selecting a Guide Ball Bushing ..	A4-8
Rated Load and Nominal Life	A4-9
Table of Equivalent Factors	A4-12
Precautions To Be Taken if an Eccentric Load Is Applied ..	A4-12
Accuracy Standards	A4-13
Dimensional Drawing, Dimensional Table	
Model LG	A4-14
Point of Design	A4-16
Assembling the Guide Ball Bushing	A4-16
Options	A4-19
Lubrication	A4-19
Dust prevention	A4-19
Model No.	A4-20
• Model Number Coding	A4-20
Precautions on Use	A4-21
Features and Types	A4-23
Features of the Linear Bushing	A4-23
• Structure and Features	A4-23
Types of the Linear Ball Bushing	A4-25
• Types and Features	A4-25
Classification Table	A4-32
Point of Selection	A4-34
Flowchart for Selecting a Linear Bushing ..	A4-34
• Steps for Selecting a Linear Bushing	A4-34
Rated Load and Nominal Life	A4-35
Table of Equivalent Factors	A4-38
Precautions To Be Taken if an Eccentric Load Is Applied ..	A4-38
Accuracy Standards	A4-39
Dimensional Drawing, Dimensional Table	
Model LM	A4-40
Model LM-GA (Metal Retainer Type)	A4-42
Model LM-MG (Stainless Steel Type)	A4-44

Model LME	A4-46
Model LM-L	A4-48
Model LMF	A4-50
Model LMF-M (Stainless Steel Type)	A4-52
Model LMK	A4-54
Model LMK-M (Stainless Steel Type)	A4-56
Model LMF-L	A4-58
Model LMF-ML (Stainless Steel Type)	A4-60
Model LMK-L	A4-62
Model LMK-ML (Stainless Steel Type) ..	A4-64
Model LMH	A4-66
Model LMH-L	A4-68
Models SC6 to 30	A4-70
Models SC35 to 50	A4-72
Model SL	A4-74
Model SH	A4-76
Model SH-L	A4-78
Model SK	A4-80
• Dedicated Shafts for Model LM	A4-81
• Standard LM Shafts	A4-82
• Specially Machined Types	A4-83
• Table of Rows of Balls and Masses for Clearance-adjustable Types and Open Types of the Linear Bushing	A4-83
Point of Design	A4-84
Assembling the Linear Bushing	A4-84
Options	A4-91
Lubrication	A4-91
Material and Surface Treatment	A4-91
Dust prevention	A4-92
Felt Seal Model FLM	A4-92
Model No.	A4-93
• Model Number Coding	A4-93
• Notes on Ordering	A4-94
Precautions on Use	A4-95

Features of the Guide Ball Bushing

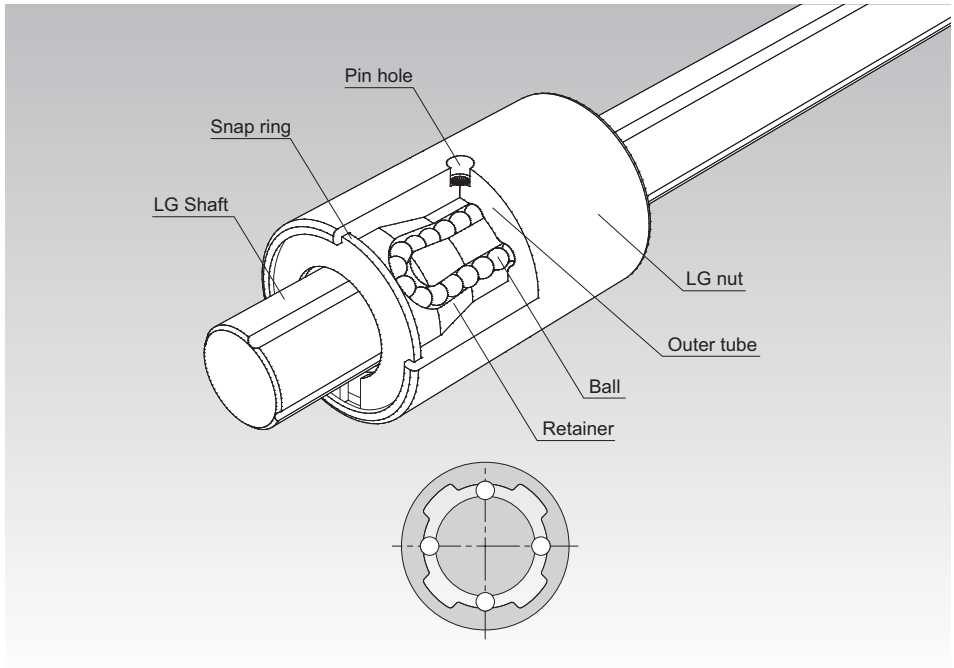

Fig.1 Structure of the Guide Ball Bushing model LG

Structure and Features

Since model LG has 4 rows of circular arc grooves (raceways), it does not need a mechanism to prevent the outer tube from rotating. In addition, its load rating is much larger than Linear Bushing model LM with the same dimensions. Therefore, replacing the Linear Bushing with the Guide Ball Bushing will reduce the size and cost of the guide unit and extend the service life.

[Higher Load Rating than the Linear Bushing]

Since model LG ensures an R contact through the use of circular arc grooves for ball contact, it achieves a load rating more than twice that of point-contact Linear Bushing model LM with the same size.

[A Rotation Stopper is Unnecessary Because of Raceways]

Since model LG has circular arc grooves, it does not need a rotation stopper required for Linear Bushing model LM, and allows the machine design to be compact.

[Interchangeable in Dimensions with Linear Bushing Model LM]

Since the outer tube of model LG has the same outer diameter and length as that of Linear Bushing model, LM, it is possible to replace Linear Bushing model LM with Guide Ball Bushing model LG as assemblies.

[Various Combinations of Nut and Shaft are Available (Any Combination is Allowed)]

As with the Linear Bushing, any combination of the LG nut and the LG shaft of model LG is allowed.

Examples of Changing the Linear Bushing to the Guide Ball Bushing

[Advantage of using the Guide Ball Bushing 1: Longer service life]

Since model LG has a rated load more than 2.4 times the Linear Bushing with the same dimensions, replacing the Linear Bushing with model LG will increase the service life by more than 13.8 times.

Table1 Comparison of the service life between Guide Ball Bushing mode LG and Linear Bushing model LM

Model No.	Basic dynamic load rating: C [N]	Load rating ratio	Service life ratio
LG4S	335	3.8 times	54.8 times
LM4	88.2		
LG6S	494	2.4 times	13.8 times
LM6	206		
LG8S	796	3.0 times	27.0 times
LM8	265		

[Advantage of using the Guide Ball Bushing 2: Smaller machine size]

Since the Linear Bushing is not suitable for applications where a load in the rotational direction is applied, it is necessary to use two or more Linear Bushing units in parallel or have a rotation stopper mechanism even under conditions where a torque is not applied. In contrast, the Guide Ball Bushing, which has a structure containing four rows of circular arc grooves, is operable with a single shaft and therefore contributes to downsizing the machine, unless an excessive load is applied.

Achieves a load carrying capacity approximately three times the Linear Bushing in a half space

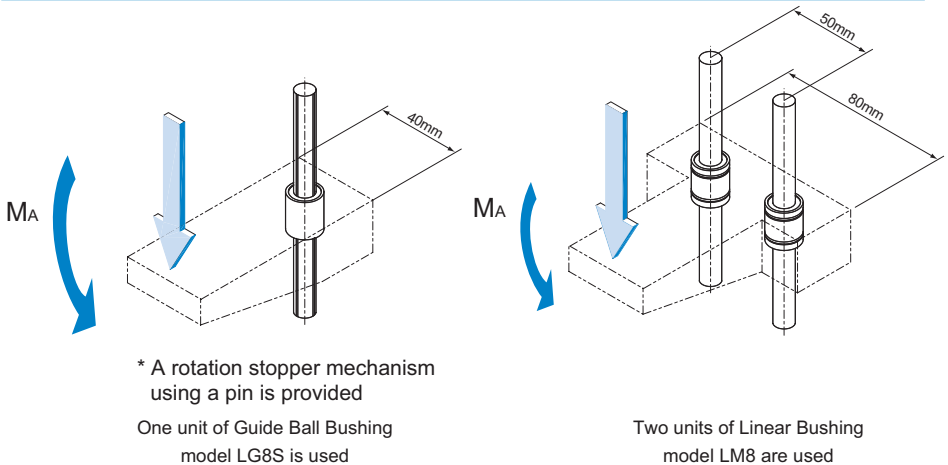

Table2 Comparison of the permissible moment between Guide Ball Bushing mode LG and Linear Bushing model LM

Model No.	Permissible moment: M_A [N·m]
One unit of LG8S is used	1.46
Two units of LM8 are used	0.45

Types of the Guide Ball Bushing

Types and Features

Model LG-S

Specification Table⇒ [A4-14](#)

In this type, the diameter and the length of the LG nut are the same as that of Linear Bushing model LM. This type is dimensionally interchangeable with model LM.

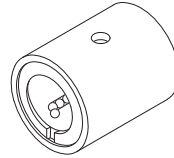

Model LG-L

Specification Table⇒ [A4-14](#)

Model LG-L is a long type in which the overall length of the LG nut is longer than that of model LG-S to increase the load carrying capacity.

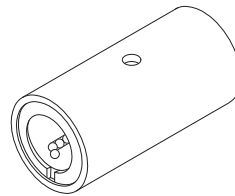

Flowchart for Selecting a Guide Ball Bushing

Steps for Selecting a Guide Ball Bushing

The following flowchart should be used as a guide for selecting a Guide Ball Bushing.

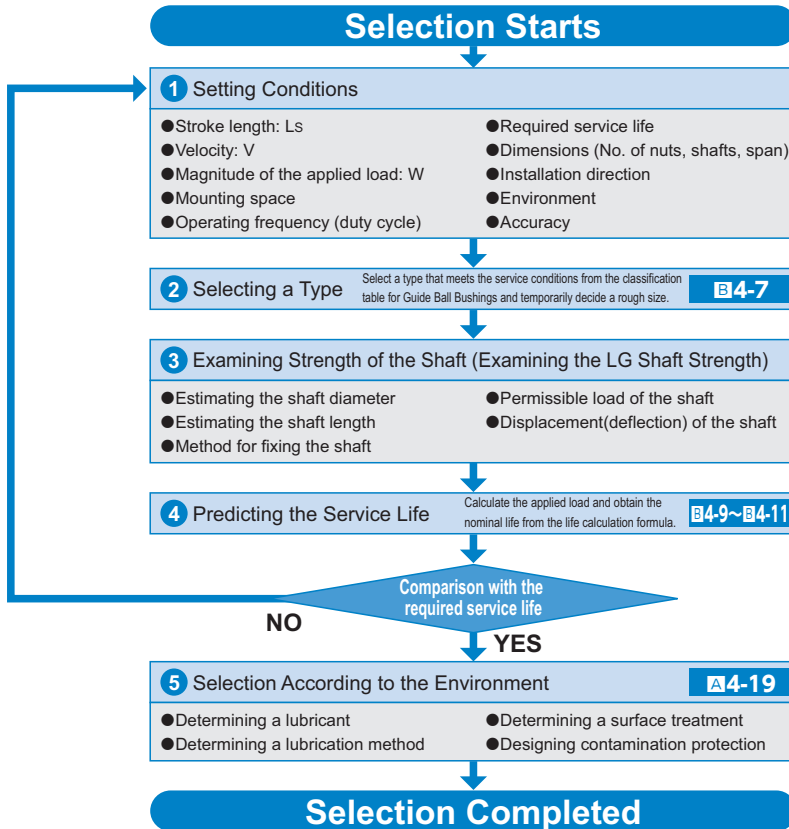

Rated Load and Nominal Life

[Load Rating]

The rated load of the Guide Ball Bushing varies according to the position of balls in relation to the load direction. The basic load ratings indicated in the specification tables each indicate the value when one row of balls receiving a load are directly under the load.

If the Guide Ball Bushing is mounted so that two rows of balls evenly receive the load in the load direction, the rated load changes as shown in Table1.

Table1 Rated load of the Guide Ball Bushing

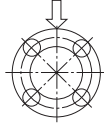
Rows of balls	Ball position	Load Rating
4 rows		$1.41 \times C$

Note: For specific values for "C" above, see the respective specification table.

[Calculating the Nominal Life]

The nominal life of the Guide Ball Bushing is obtained using the following equation.

$$L = \left(\frac{f_H \cdot f_T \cdot f_c}{f_w} \cdot \frac{C}{P_c} \right)^3 \times 50$$

L	: Nominal life	(km)
C	: Basic dynamic load rating	(N)
P_c	: Calculated load	(N)
f_T	: Temperature factor	
f_c	: Contact factor	(see Table2 on B4-11)
f_w	: Load factor	(see Table3 on B4-11)
f_H	: Hardness factor	(see Fig.1)

● When a Moment Load is Applied to a Single Nut or Two Nuts in Close Contact with Each Other

When a moment load is applied to a single nut or two nuts in close contact with each other, calculate the equivalent radial load at the time the moment is applied.

$$P_u = K \cdot M$$

P_u	: Equivalent radial load	(N)
	(with a moment applied)	
K	: Equivalent factors	
	(see Table4 to Table5 on A4-12)	
M	: Applied moment	(N-mm)

However, “ P_u ” is assumed to be within the basic static load rating (C_0).

● When a Moment Load and a Radial Load are Simultaneously Applied

When a moment and a radial load are applied simultaneously, calculate the service life based on the sum of the radial load and the equivalent radial load.

■ f_H : Hardness Factor

To maximize the load capacity of the Guide Ball Bushing, the hardness of the raceways needs to be between 58 to 64 HRC.

If the hardness is lower than this range, the basic dynamic load rating and the basic static load rating decrease. Therefore, it is necessary to multiply each rating by the respective hardness factor (f_H).

Normally, $f_H = 1.0$ since the Guide Ball Bushing has sufficient hardness.

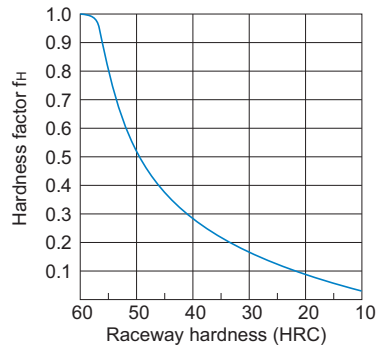

Fig.1 Hardness Factor (f_H)

f_r: Temperature Factor

The temperature of the environment where the Guide Ball Bushing is used must be 80°C or below. Therefore, adopt a temperature factor $f_r = 1.0$.

The Guide Ball Bushing does not support high temperature. Therefore, if the environment temperature exceeds 80°C, it is necessary to use another product.

f_c: Contact Factor

When multiple nuts are used in close contact with each other, their linear motion is affected by moments and mounting accuracy, making it difficult to achieve uniform load distribution. In such applications, multiply the basic load rating (C) and (C₀) by the corresponding contact factor in Table2.

Note) If uneven load distribution is expected in a large machine, take into account the respective contact factor indicated in Table2.

Table2 Contact Factor (f_c)

Number of nuts in close contact with each other	Contact factor f _c
2	0.81
3	0.72
4	0.66
5	0.61
Normal use	1

f_w: Load Factor

In general, reciprocating machines tend to involve vibrations or impact during operation. It is difficult to accurately determine vibrations generated during high-speed operation and impact during frequent start and stop motion. Therefore, when loads applied on a Guide Ball Bushing cannot be measured, or when speed and impact have a significant influence, divide the basic load rating (C) or (C₀) by the corresponding load factor in Table3.

Table3 Load Factor (f_w)

Vibrations/impact	Speed(V)	f _w
Faint	Very low $V \leq 0.25\text{m/s}$	1 to 1.2
Weak	Slow $0.25 < V \leq 1\text{m/s}$	1.2 to 1.5
Medium	Medium $1 < V \leq 2\text{m/s}$	1.5 to 2
Strong	High $V > 2\text{m/s}$	2 to 3.5

[Calculating the Service Life Time]

When the nominal life (L) has been obtained, if the stroke length and the number of reciprocations per minute are constant, the service life time is obtained using the following equation.

$$L_h = \frac{L \times 10^3}{2 \times \ell_s \times n_1 \times 60}$$

L_h : Service life time (h)

ℓ_s : Stroke length (m)

n₁ : Number of reciprocations per minute (min⁻¹)

Precautions To Be Taken if an Eccentric Load Is Applied

Model LG achieves a much higher load-carrying capacity in receiving the eccentric load (moment and torque) than Linear Bushing model LM because of 4 rows of raceways. However, under conditions where the eccentric load is larger, the product may result in poor operation or early failure. In such cases, we recommend using Ball Spline model LBS or LT, both of which have larger load-carrying capacities (see **B3-4** onward).

Assembling the Guide Ball Bushing

[Inner Diameter of the Housing]

Table1 shows recommended housing inner-diameter tolerance for the Guide Ball Bushing. When fitting the Guide Ball Bushing with the housing, loose fit is normally recommended. If the clearance needs to be smaller, provide transition fit.

Table1 Housing Inner-diameter Tolerance

General conditions	H6
If the accuracy does not need to be very high	H7

[Mounting the Nut]

Although the Guide Ball Bushing does not require a large amount of strength for securing it in the LG shaft direction, do not support the nut only with driving fitting. For the housing inner-diameter tolerance, see Table1.

- Mounting model LG using a pin

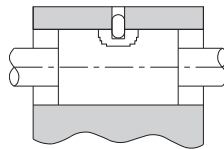

- Mounting model LG as with the conventional Linear Bushing

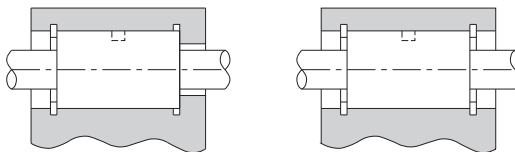

Snap Ring

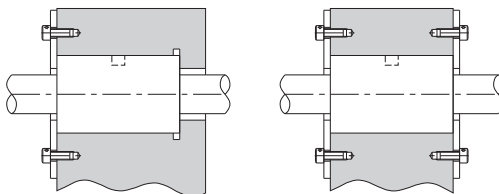

Stopper Plate

■Snap Ring for Installation

To secure the Guide Ball Bushing model LG, snap rings indicated in Table2 are available.

Table2 Types of Snap Rings

Model No.	Snap ring	
	For inner surface	
	Needle snap ring	C-shape snap ring
LG 4	8	—
LG 6	12	12
LG 8	15	15

■Set Screws Not Allowed

Securing the nut by pressing the outer surface with one set screw as shown in Fig.1 will cause the nut to be deformed.

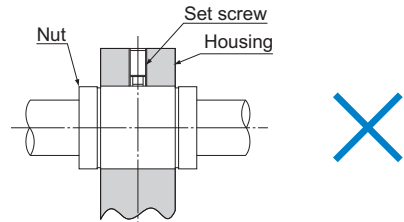

Fig.1

[Incorporating the Nut]

When incorporating the Guide Ball Bushing into a housing, use a jig and drive in the nut, or use a flatter plate and gently hit the nut, instead of directly hitting the side plate or the seal. (see Fig.2).

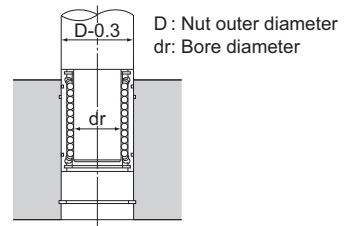

Fig.2

Unit: mm

Model No.	dr	Tolerance
LG 4S/LG 4L	3.6	-0.1 -0.3
LG 6S/LG 6L	5.6	
LG 8S/LG 8L	7.5	

[Inserting the LG Shaft]

When inserting the LG shaft into the Guide Ball Bushing, align the center of the shaft with that of the nut and gently insert the shaft straightforward into the nut. If the shaft is slanted while it is inserted, balls may fall off or the retainer may be deformed (see Fig.3).

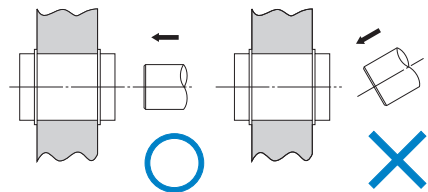

Fig.3

[When Under a Moment Load]

When using the Guide Ball Bushing, make sure that the load is evenly distributed on the whole ball raceway. In particular, if a moment load is applied, use two or more Guide Ball Bushing units on the same LG shaft and secure an adequately large distance between the units.

If using the Guide Ball Bushing under a moment load, also calculate the equivalent radial load and identify the correct model number. (See **B4-10**.)

Dust prevention

Entrance of dust or other foreign material into the Guide Ball Bushing will cause abnormal wear or shorten the service life. When entrance of dust or other foreign material is a possibility, it is important to select effective seals and/or dust-control device that meets the service environment conditions. In addition, THK produces round bellows. Contact us for details.

Model Number Coding

Model number configurations differ depending on the model features. Refer to the corresponding sample model number configuration.

[Guide Ball Bushing]

Estimates and orders should be made for LG shafts alone or LG nuts alone in principle.

A set consisting of an LG shaft and an LH nut is also available if desired by the customer. Contact THK for details.

● Models LG-S and LG-L

- LG shaft only

LG4 -100L

Model No.
of LG shaft

Overall LG shaft length (in mm)

- LG nut only

LG4S

Model No. of LG nut

- Combination of
LG shaft and LG nut

2 LG4S +100L

Model No.
of LG nut

Overall LG shaft length (in mm)

Number of LG nuts on one shaft
(no symbol for one nut)

A special radial clearance, designated grease application (standard product is applied with antirust oil only), and surface treatment (THK AP-C treatment, THK AP-CF treatment, THK AP-HC treatment) are also available. Contact THK for details.

[Handling]

- (1) Disassembling components may cause dust to enter the system or degrade mounting accuracy of parts. Do not disassemble the product.
- (2) Dropping or hitting the Guide Ball Bushing may damage it. Giving an impact force to the product could also cause damage even if the product looks intact.

[Lubrication]

- (1) Thoroughly remove anti-rust oil and feed lubricant before using the product.
- (2) Do not mix lubricants of different physical properties.
- (3) In locations exposed to constant vibrations or in special environments such as clean rooms, vacuum and low/high temperature, normal lubricants may not be used. Contact THK for details.
- (4) When planning to use a special lubricant, contact THK before using it.

[Precautions on Use]

- (1) Entrance of foreign material may cause damage to the ball circulating component or functional loss. Prevent foreign material, such as dust or cutting chips, from entering the system.
- (2) Do not use the product at temperature of 80°C or higher. Contact THK if you desire to use the product at a temperature of 80°C or higher.
- (3) Please be careful when using the product in an environment with excessive coolant. The coolant may cause premature failure if it penetrates the Guide Ball Bushing. Contact THK for further details.
- (4) If foreign material adheres to the product, replenish the lubricant after cleaning the product.
- (5) When using the product in locations exposed to constant vibrations or in special environments such as clean rooms, vacuum and low/high temperature, contact THK in advance.

[Storage]

When storing the Guide Ball Bushing, enclose it in a package designated by THK and store it while avoiding high temperature, low temperature and high humidity.

[Assembling the LG Nut with the LG Shaft of the Guide Ball Bushing]

- (1) When assembling the LG nut with the LG shaft, align the position of the balls inside the nut with the position of the groove of the LG shaft, then insert the LG shaft into the LG nut straightforward and gradually. If the LG shaft is tilted when it is inserted, balls may bounce out or break the circulation part.
- (2) If the LG shaft is stuck in the middle of insertion, do not force it into the nut. Instead, pull it out first, re-check the ball position and the LG shaft groove position, and then insert it straightforward and gradually.

- (3) After assembling the LG nut with the LG shaft, check that the LG nut or the LG shaft smoothly moves. If the shaft was forced into the nut, function could be lost even if the product looks intact.

Features of the Linear Bushing

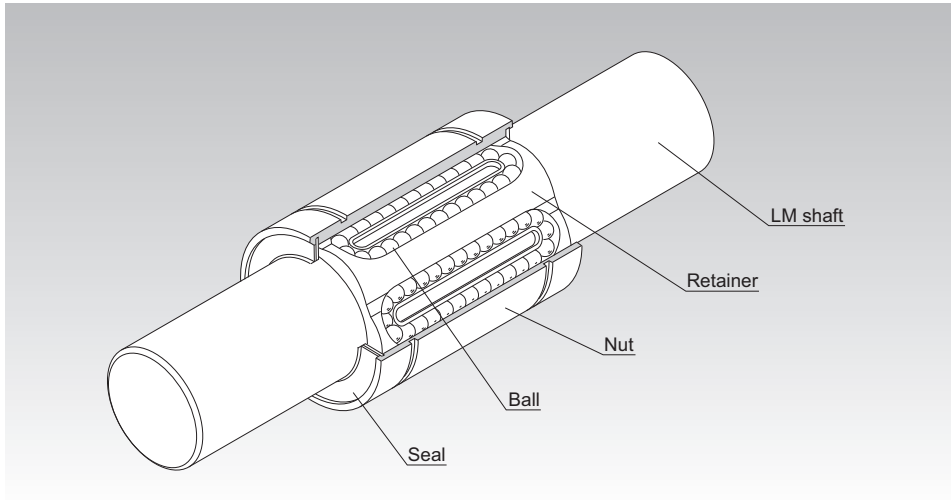

Fig.1 Structure of Linear Bushing Model LM···UU

Structure and Features

Linear Bushing model LM is a linear motion system used in combination with a cylindrical LM shaft to perform infinite straight motion. The balls in the loaded area of the nut are in point contact with the LM shaft. This allows straight motion with minimal friction resistance and achieves highly accurate and smooth motion despite the small permissible load.

The nut uses high-carbon chromium bearing steel and its outer and inner surfaces are ground after being heat-treated.

The Linear Bushing is used in a broad array of applications, such as slide units of precision equipment including OA equipment and peripherals, measuring instruments, automatic recorders and digital 3D measuring instruments, industrial machines including multi-spindle drilling machine, punching press, tool grinder, automatic gas cutting apparatus, printing machine, card selector and food packing machine.

[Interchangeability]

Since the dimensional tolerances of the Linear Bush's components are standardized, they are interchangeable. The LM shaft is machined through cylindrical grinding, which can easily be performed, and it allows highly accurate fitting clearance to be achieved.

[Highly Accurate Retainer Plate]

Since the retainer, which guides three to eight rows of balls, is integrally molded, it is capable of accurately guiding the balls in the traveling direction and achieving stable running accuracy. Small-diameter types use integrally molded retainers made of synthetic resin. It reduces noise generated during operation and allows for superb lubrication.

[Wide Array of Types]

A wide array of types are available, such as standard type, clearance-adjustable type, open type, long type and flanged linear bushing, allowing the user to select a type that meets the intended use.

Types of the Linear Ball Bushing

Types and Features

Standard Type

With the Linear Bushing nut having the most accurate cylindrical shape, this type is widely used.

There are two series of the Linear Bushing in dimensional group.

- Model LM
Metric units series used most widely in Japan
- Model LM-MG
Stainless steel version of type LM
- Model LME
Metric units series commonly used in Europe

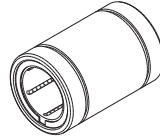

Standard Type

Open Type

The nut is partially cut open by one row of balls (50° to 80°). This enables the Linear Bushing to be used even in locations where the LM shaft is supported by a column or fulcrum. In addition, a clearance can easily be adjusted.

Models LM-OP/LME-OP

Model LM-MGA-OP

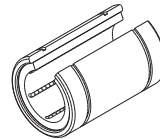

Open Type

Clearance-adjustable Type

This type has the same dimensions as the standard type, but the nut has a slit in the direction of the LM shaft. This allows the linear bushing to be installed in a housing whose inner diameter is adjustable, and enables the clearance between the LM shaft and the housing to easily be adjusted.

Models LM-AJ/LME-AJ
Model LM-MG-AJ

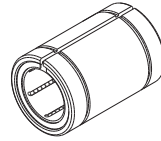

Clearance-adjustable Type

Long Type

Containing two units of the standard retainer plate, this type is optimal for locations where a moment load is present and reduces man-hours in installation.

Model LM-L·····Standard type

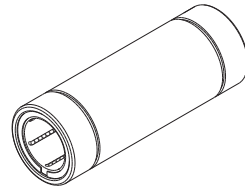

Long Type

Flanged Type (Round)

The nut of the standard type Linear Bushing is integrated with a flange. This enables the Linear Bushing to be directly mounted onto the housing with bolts, thus achieving easy installation.

Model LMF·····Standard type
Model LMF-M·····Made of stainless steel

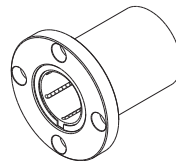

Flanged Type (Round)

Flanged Type (Square)

Like model LMF, this type also has a flange, but the flange is cut to a square shape. Since the height is lower than the circular flange type, compact design is allowed.

Model LMK··········Standard type

Model LMK-M··········Made of stainless steel

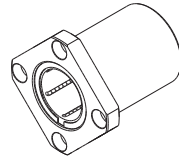

Flanged Type (Square)

Flanged Type (Round) - Long

The nut of the long type Linear Bushing is integrated with a flange. This enables the Linear Bushing to be directly mounted onto the housing with bolts, thus achieving easy installation. Containing two units of the standard retainer plate, this type is optimal for locations where a moment load is present.

Model LMF-L··········Standard type

Model LMF-ML··········Made of stainless steel

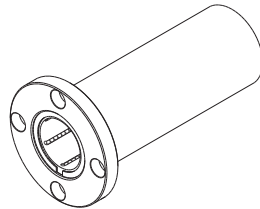

Flanged Type (Round) - Long

Flanged Type (Square) - Long

Like model LMF-L, this type also has a flange, but the flange is cut to a square shape. Since the height is lower than the circular flange type, compact design is allowed.

Model LMK-L··········Standard type

Model LMK-ML··········Made of stainless steel

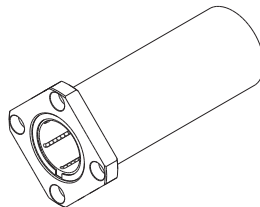

Flanged Type (Square) - Long

Flanged Type (Cut Flange)

The nut is integrated with a cut flange. Since the height is lower than model LMK, compact design is allowed. Since the rows of balls in the Linear Bushing are arranged so that two rows receive the load from the flat side, a long service life can be achieved.

Model LMH.....Standard type

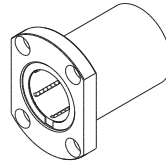

Flanged Type (Cut Flange)

Flanged Type (Cut Flange) - Long

The flange is a cut flange and lower than model LMK-L, allowing compact design. Containing two units of the standard retainer plate, this type is optimal for locations where a moment load is present. Since the rows of balls in the Linear Bushing are arranged so that two rows receive the load from the flat side, a long service life can be achieved.

Model LMH-L.....Standard type

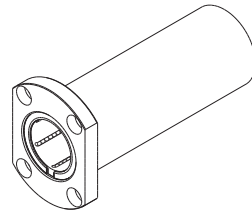

Flanged Type (Cut Flange) - Long

Linear Bushing Model SC

It is a case unit where the standard type of Linear Bushing is incorporated into a small, light-weight aluminum casing. This model can easily be mounted simply by securing it to the table with bolts.

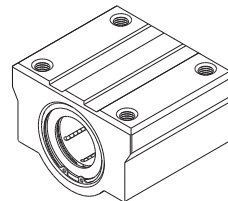

Linear Bushing Model SC

Linear Bushing (Long) Model SL

A long version of model SC, this model contains two units of the standard type Linear Bushing in an aluminum casing.

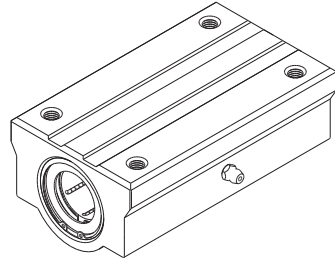

Linear Bushing (Long) Model SL

Linear Bushing Model SH

It is a case unit where the standard type of Linear Bushing is incorporated into a smaller and lighter aluminum casing than model SC. This model allows even more compact design than model SC. It also has flexibility in mounting orientation. Additionally, it is structured so that two rows of balls receive the load from the top of the casing, allowing a long service life to be achieved.

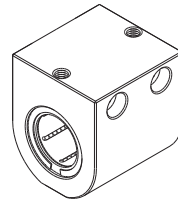

Linear Bushing Model SH

Linear Bushing (Long) Model SH-L

A long version of model SH, this model is a case unit that contains two units of the standard type Linear Bushing in an aluminum casing.

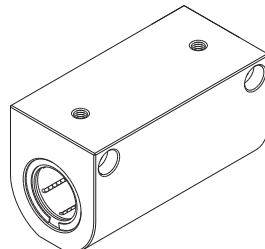

Linear Bushing (Long) Model SH-L

LM Shaft End Support Model SK

An aluminum-made light fulcrum for securing an LM shaft. The LM shaft mounting section has a slit, enabling the linear bushing to firmly secure an LM shaft using bolts.

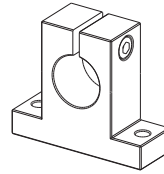

LM Shaft End Support Model SK

Standard LM Shafts

THK manufactures high quality, dedicated LM shafts for Linear Bushing model LM series.



Standard LM Shafts

Build-to-order LM Shafts

THK also manufactures hollow LM shafts and specially machined shafts at your request.



Build-to-order LM Shafts

Classification Table

Linear Bushing

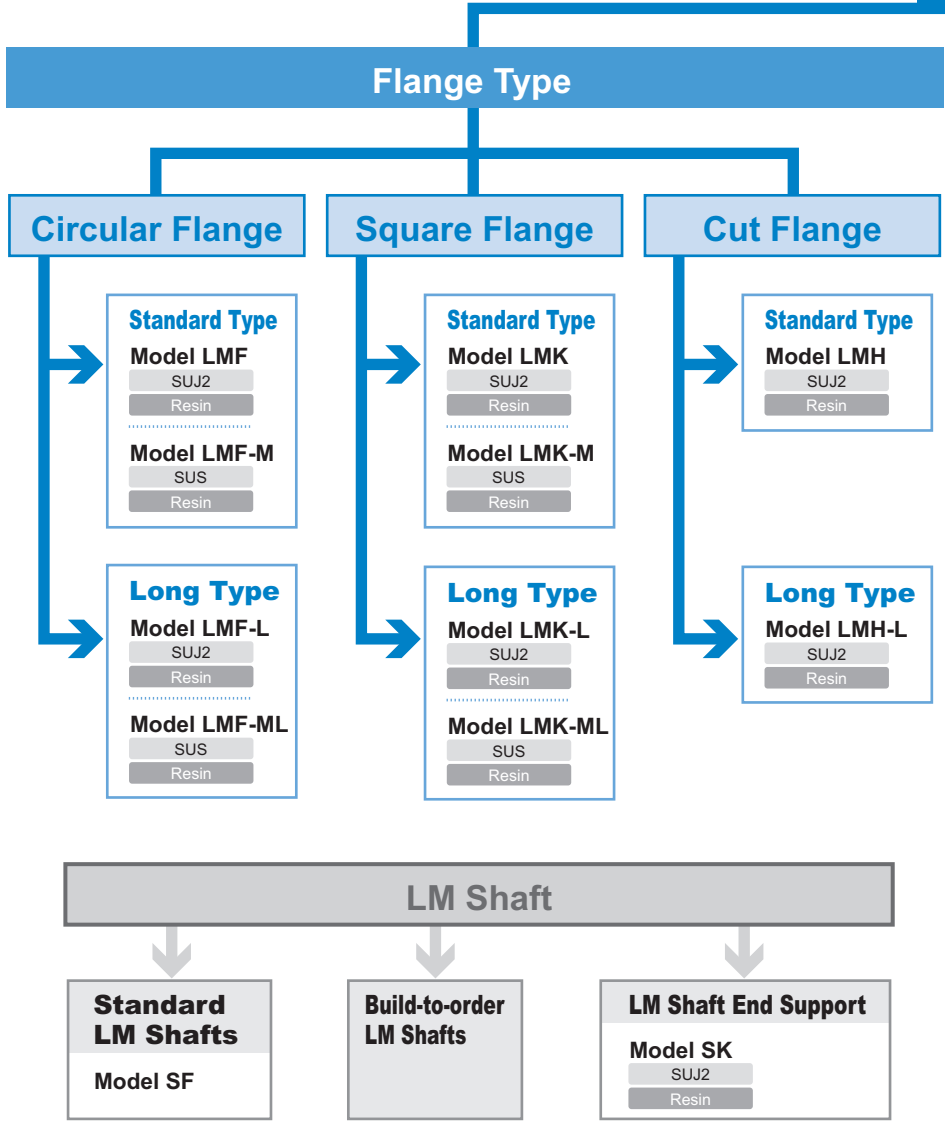

Flowchart for Selecting a Linear Bushing

Steps for Selecting a Linear Bushing

The following flowchart should be used as a guide for selecting a Linear Bushing.

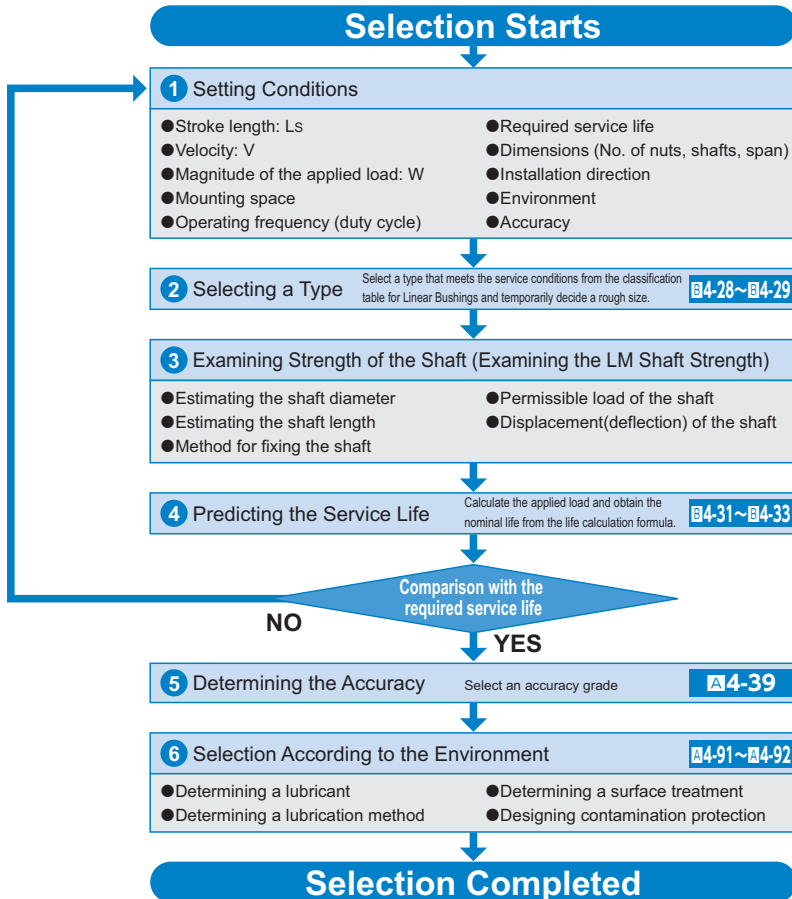

Rated Load and Nominal Life

[Load Rating]

The rated load of the Linear Bushing varies according to the position of balls in relation to the load direction. The basic load ratings indicated in the specification tables each indicate the value when one row of balls receiving a load are directly under the load.

If the Linear Bushing is mounted so that two rows of balls evenly receive the load in the load direction, the rated load changes as shown in Table1.

Table1 Rated load of the Linear Bushing

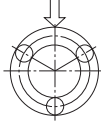
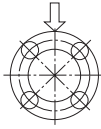
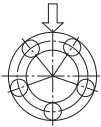
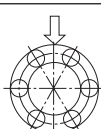
Rows of balls	Ball position	Load Rating
3 rows		$1 \times C$
4 rows		$1.41 \times C$
5 rows		$1.46 \times C$
6 rows		$1.28 \times C$

For specific values for "C" above, see the respective specification table.

[Calculating the Nominal Life]

The nominal life of the Linear Bushing is obtained using the following equation.

$$L = \left(\frac{f_H \cdot f_T \cdot f_C}{f_W} \cdot \frac{C}{P_C} \right)^3 \times 50$$

- L : Nominal life (km)
- C : Basic dynamic load rating (N)
- P_C : Calculated load (N)
- f_T : Temperature factor (see Fig.2 on **B4-33**)
- f_C : Contact factor (see Table2 on **B4-33**)
- f_W : Load factor (see Table3 on **B4-33**)
- f_H : Hardness factor (see Fig.1)

● When a Moment Load is Applied to a Single Nut or Two Nuts in Close Contact with Each Other

When a moment load is applied to a single nut or two nuts in close contact with each other, calculate the equivalent radial load at the time the moment is applied.

$$P_u = K \cdot M$$

- P_u : Equivalent radial load (N)
(with a moment applied)
- K : Equivalent factors
(see Table4 to Table6 on **A4-38**)
- M : Applied moment (N-mm)

However, “ P_u ” is assumed to be within the basic static load rating (C_0).

● When a Moment Load and a Radial Load are Simultaneously Applied

When a moment and a radial load are applied simultaneously, calculate the service life based on the sum of the radial load and the equivalent radial load.

■ f_H : Hardness Factor

To maximize the load capacity of the Linear Bushing, the hardness of the raceways needs to be between 58 to 64 HRC.

If the hardness is lower than this range, the basic dynamic load rating and the basic static load rating decrease. Therefore, it is necessary to multiply each rating by the respective hardness factor (f_H).

Normally, $f_H = 1.0$ since the Linear Bushing has sufficient hardness.

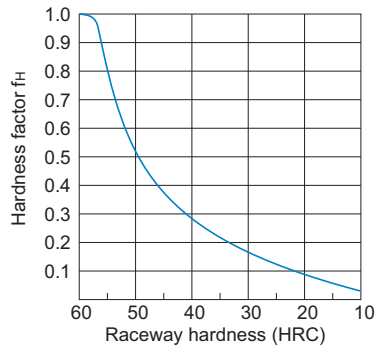

Fig.1 Hardness Factor (f_H)

■f_t: Temperature Factor

If the temperature of the environment surrounding the operating Linear Bushing exceeds 100°C, take into account the adverse effect of the high temperature and multiply the basic load ratings by the temperature factor indicated in Fig.2.

Also note that the Linear Bushing itself must be of high temperature type.

Note) If the environment temperature exceeds 80°C, use a Linear Bushing type equipped with metal retainer plates.

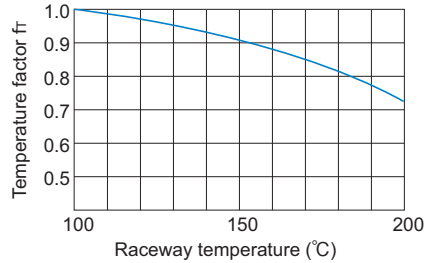

Fig.2 Temperature Factor (f_t)

■f_c: Contact Factor

When multiple nuts are used in close contact with each other, their linear motion is affected by moments and mounting accuracy, making it difficult to achieve uniform load distribution. In such applications, multiply the basic load rating (C) and (C₀) by the corresponding contact factor in Table2.

Note) If uneven load distribution is expected in a large machine, take into account the respective contact factor indicated in Table2.

Table2 Contact Factor (f_c)

Number of nuts in close contact with each other	Contact factor f _c
2	0.81
3	0.72
4	0.66
5	0.61
Normal use	1

■f_w: Load Factor

In general, reciprocating machines tend to involve vibrations or impact during operation. It is difficult to accurately determine vibrations generated during high-speed operation and impact during frequent start and stop motion. Therefore, when loads applied on a Linear Bushing cannot be measured, or when speed and impact have a significant influence, divide the basic load rating (C) or (C₀) by the corresponding load factor in Table3.

Table3 Load Factor (f_w)

Vibrations/ impact	Speed(V)	f _w
Faint	Very low V ≤ 0.25m/s	1 to 1.2
Weak	Slow 0.25 < V ≤ 1m/s	1.2 to 1.5
Medium	Medium 1 < V ≤ 2m/s	1.5 to 2
Strong	High V > 2m/s	2 to 3.5

[Calculating the Service Life Time]

When the nominal life (L) has been obtained, if the stroke length and the number of reciprocations per minute are constant, the service life time is obtained using the following equation.

$$L_h = \frac{L \times 10^3}{2 \times l_s \times n_1 \times 60}$$

- L_h : Service life time (h)
- l_s : Stroke length (m)
- n₁ : Number of reciprocations per minute (min⁻¹)

Precautions To Be Taken if an Eccentric Load Is Applied

Since Linear Bushing is not suitable for application of an eccentric load, we recommend using Guide Ball Bushing or Ball Spline.

Assembling the Linear Bushing

[Inner Diameter of the Housing]

Table1 shows recommended housing inner-diameter tolerance for the Linear Bushing. When fitting the Linear Bushing with the housing, loose fit is normally recommended. If the clearance needs to be smaller, provide transition fit.

Table1 Housing Inner-diameter Tolerance

Type		Housing	
Model No.	Accuracy	Loose fit	Transition fit
LM	High accuracy grade (no symbol)	H7	J7
	Precision Grade (P)	H6	J6
LME	—	H7	K6, J6
LMF	High accuracy grade (no symbol)	H7	J7
LMK			
LMH			
LM-L			
LMF-L			
LMK-L			
LMH-L			

[Clearance between the Nut and the LM Shaft]

When using the Linear Bushing in combination with an LM shaft, use normal clearance in ordinary use and small gap if the clearance is to be minimized.

Note1) If the clearance after installation is to be negative, it is preferable not to exceed the radial clearance tolerance indicated in the specification table.

Note2) The shaft tolerance for Linear Bushing models SC, SL SH and SH-L falls under high accuracy grade (no symbol).

Table2 Shaft Outer-diameter Tolerance

Type		LM Shaft	
Model No.	Accuracy	Normal clearance	Small gap
LM	High accuracy grade (no symbol)	f6, g6	h6
	Precision Grade (P)	f5, g5	h5
LME	—	h7	k6
LMF	High accuracy grade (no symbol)	f6, g6	h6
LMK			
LMH			
LM-L			
LMF-L			
LMK-L			
LMH-L			

[Mounting the Nut]

Although the Linear Bushing does not require a large amount of strength for securing it in the axial direction, do not rely only on a press fit to support the nut. For the housing inner-diameter tolerance, see Table1 on **B4-35**.

● Installing the Standard Type

Fig.1 and Fig.2 show examples of installing the standard type Linear Bushing.

When securing the Linear Bushing, use snap rings or stopper plates.

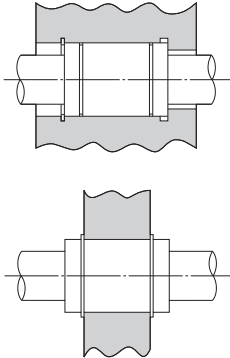

Fig.1 Snap Ring

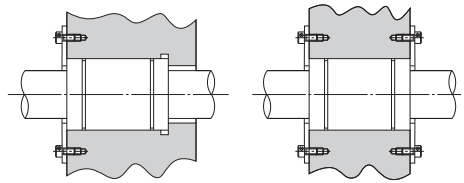

Fig.2 Stopper Plate

Mounting Procedure and Maintenance

Assembling the Linear Bushing

■Snap Ring for Installation

To secure Linear Bushing model LM, snap rings indicated in Table3 are available.

Note1) For models indicated with parentheses, use C-shape concentric snap rings.

Note2) The Table3 commonly applies to models LM, LM-GA, LM-MG and LM-L.

Table3 Types of Snap Rings

Model No.	Snap ring			
	For outer surface		For inner surface	
	Needle snap ring	C-shape snap ring	Needle snap ring	C-shape snap ring
LM 3	—	—	AR 7	—
LM 4	—	—	8	—
LM 5	WR 10	10	10	10
LM 6	12	12	12	12
LM 8	—	15	15	15
LM 8S	—	15	15	15
LM 10	19	19	19	19
LM 12	21	21	21	21
LM 13	23	22	23	—
LM 16	28	—	28	28
LM 20	32	—	32	32
LM 25	40	40	40	40
LM 30	45	45	45	45
LM 35	52	52	52	52
LM 38	—	56-58	57	—
LM 40	—	60	60	60
LM 50	—	80	80	80
LM 60	—	90	90	90
LM 80A	—	120	120	120
LM 100A	—	(150)	150	—
LM 120A	—	(180)	180	—

■Set Screws Not Allowed

Securing the nut by pressing the outer surface with one set screw as shown in Fig.3 will cause the nut to be deformed.

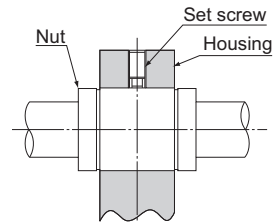
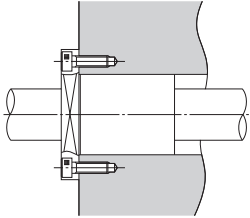

Fig.3

● **Installing a Flanged Type**

With models LMF, LMK and LMH, the nut is integrated with a flange. Therefore, the Linear Bushing can be mounted only via the flange.



Nut mounted via socket and spigot joint

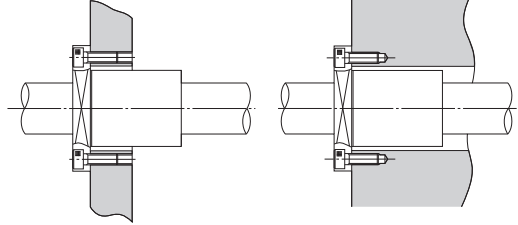

Mounted via a flange only

● **Installing a Clearance-adjustable Type**

To adjust the clearance of a clearance-adjustable type (-AJ), use a housing that allows adjustment of the nut outer diameter so as to facilitate the adjustment of the clearance between the Linear Bushing and the LM shaft. Positioning the slit of the Linear Bushing at an angle of 90° with the housing's slit will provide uniform deformation in the circumferential direction. (See Fig.4.)

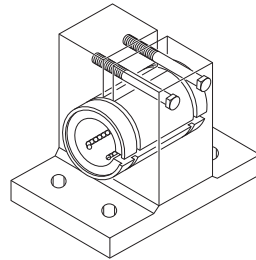

Fig.4

● **Mounting an Open Type**

For an open type (-OP), also use a housing that allows adjustment of the nut outer diameter as shown in Fig.5.

Open types are normally used with a light preload. Be sure not to give an excessive preload.

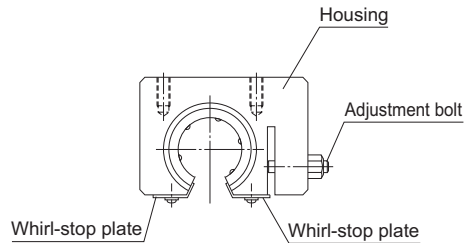
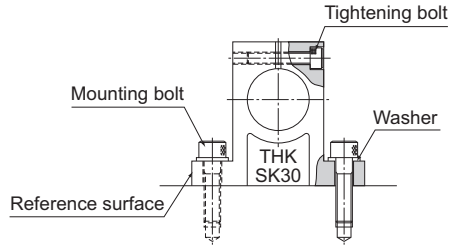

Fig.5

[Mounting the Shaft End Support]

Shaft end support model SK can easily be secured to the table using mounting bolts. Model SK enables the LM shaft to firmly be secured using tightening bolts.



[Installing an LM Case Unit]

● Attaching Model SC (SL)

Since models SC and SL can be attached from the top or bottom by simply tightening it using bolts, the installation time can be shortened. (See Fig.6.)

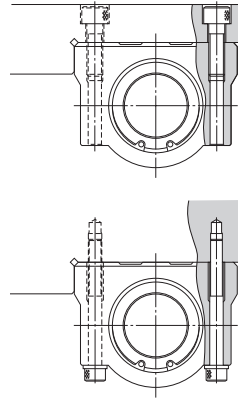

Fig.6

● Attaching Model SH (SH-L)

Since models SH and SH-L can be attached from the top or bottom by simply tightening it using bolts, the installation time can be shortened. (See Fig.7.)

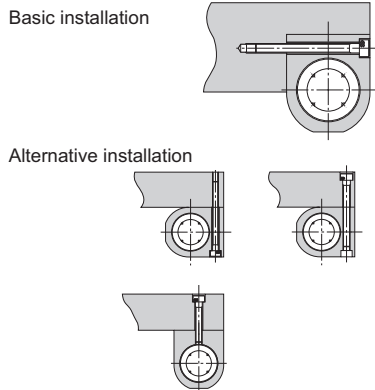

Fig.7

[Incorporating the Nut]

When incorporating the standard Linear Bushing into a housing, use a jig and drive in the nut, or use a flatter plate and gently hit the nut, instead of directly hitting the side plate or the seal. (See Fig.8.)

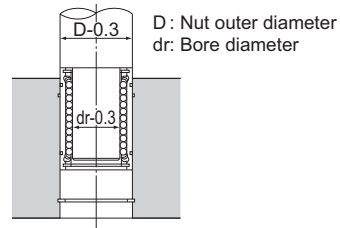

Fig.8

[Inserting the LM Shaft]

When inserting the LM shaft into the Linear Bushing, align the center of the shaft with that of the nut and gently insert the shaft straightforward into the nut. If the shaft is slanted while it is inserted, balls may fall off or the retainer may be deformed. (See Fig.9.)

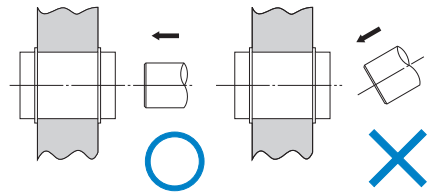

Fig.9

[When Under a Moment Load]

When using the Linear Bushing, make sure the load is evenly distributed on the whole ball raceway. In particular, if a moment load is applied, use two or more Linear Bushing units on the same LM shaft and secure an adequately large distance between the units.

If using the Linear Bushing under a moment load, also calculate the equivalent radial load and identify the correct model number. (See [B4-32](#).)

[Rotational Use Not Allowed]

The Linear Bushing is not suitable for rotational use for a structural reason. (See Fig.10.)

Forcibly rotating it may cause an unexpected accident.

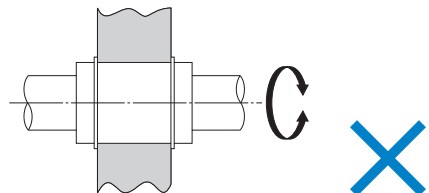

Fig.10

[Precautions on Installing an Open Three-ball-row Type Linear Bushing]

When installing an open three-ball-row type Linear Bushing, mount it while taking into account the load distribution as indicated in Fig.11.

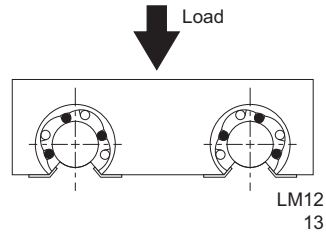

Fig.11

[Attaching Felt Seal Model FLM]

The felt seal can be press-fit into a housing finished to H7, but cannot be used as a stopper for preventing the Linear Bushing from coming off. Be sure to use the felt seal by attaching it as indicated in the Fig.12.

Also make sure to impregnate the felt with sufficient lubricant before attaching it.

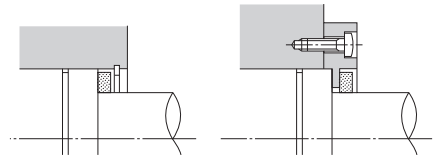

Fig.12

Lubrication

The Linear Bushing requires grease or oil as a lubricant for its operation.

[Grease Lubrication]

When installing a type attached with seals on both sides (···UU) to the LM shaft, apply grease to rows of balls in the Linear Bushing.

When installing standard types (without seal), perform the same as above or apply grease to the LM shaft.

Afterward, replenish grease of the same type as necessary according to the service conditions.

We recommend using high-quality lithium-soap group grease No. 2.

[Oil Lubrication]

Turbine oil, machine oil and spindle oil are commonly used as a lubricant.

When oiling the Linear Bushing, drop oil on the LM shaft, or infuse it from the greasing hole on the housing as shown in Fig.13.

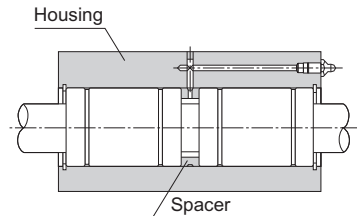

Fig.13

Material and Surface Treatment

For the Linear Bushing and the LM shaft, highly corrosion-resistant stainless steel types are available for some models.

Although the LM shaft can be surface treated, some types may not be suitable for the treatment. Contact THK for details.

Dust prevention

Entrance of dust or other foreign material into the Linear Bushing will cause abnormal wear or shorten the service life. When entrance of dust or other foreign material is a possibility, it is important to select effective seals and/or a dust-control device that meets the service environment conditions.

For the Linear Bushing, a special synthetic rubber seal that is highly resistant to wear and a felt seal (highly dust preventive with low seal resistance) are available as contamination protection accessories.

In addition, THK produces round bellows. Contact us for details.

Felt Seal Model FLM

● For detailed dimensions, see [B4-92](#).

Linear Bushing model LM series include types equipped with a special synthetic rubber seal (LM···UU, U). If desiring to have an additional contamination protection measure, or desiring to lower the seal resistance, use the felt seal model FLM.

Model Number Coding

Model number configurations differ depending on the model features. Refer to the corresponding sample model number configuration.

[Linear Bushing]

- **Plastic resin cages Standard type**
models LM, LM-L, LME, LMF, LMF-L, LMK, LMK-L, LMH, LMH-L, SC, SL, SH, SH-L

LM20 **L** **UU**
 Model No. | With nut seal
 Long type

- **Plastic resin cages Stainless steel type**
models LM-M, LM-MG, LMF-M, LMF-ML, LMK-M, LMK-ML

LM20 **M** **L** **UU**
 Model No. | | With nut seal
 Made of stainless steel Long type

- **Metal cage type**
models LM-GA, LM-MGA, LME-GA

LM20 **M** **GA** **UU**
 Model No. | | With nut seal
 Made of stainless steel

[LM Shaft End Support]

● Model SK

SK20

Model No.

[LM Shaft]

● Model SF

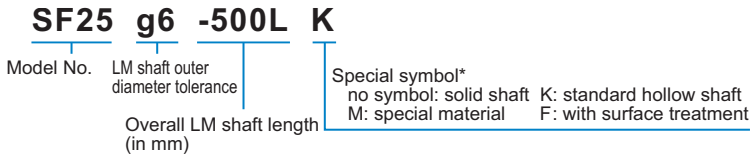

*If two or more symbols are given, they are shown in an alphabetical order.

*For information shaft diameters, permissible shaft diameter error and standard stock lengths, see **A4-82**.

[Felt Seal]

● Model FLM

FLM 20

Model No.

Notes on Ordering

For high temperature applications, a double-ended nut seal (symbol: UU) can be fitted to linear bushes for metal cages (symbol: A). However, cages without seals are recommended since the seal is only heat resistant to a temperature of 80°C.

[Handling]

- (1) Disassembling components may cause dust to enter the system or degrade mounting accuracy of parts. Do not disassemble the product.
- (2) Dropping or hitting the Linear Bushing may damage it. Giving an impact force to the product could also cause damage even if the product looks intact.

[Lubrication]

- (1) Thoroughly remove anti-rust oil and feed lubricant before using the product.
- (2) Do not mix lubricants of different physical properties.
- (3) In locations exposed to constant vibrations or in special environments such as clean rooms, vacuum and low/high temperature, normal lubricants may not be used. Contact THK for details.
- (4) When planning to use a special lubricant, contact THK before using it.

[Precautions on Use]

- (1) Entrance of foreign material may cause damage to the ball circulating component or functional loss. Prevent foreign material, such as dust or cutting chips, from entering the system.
- (2) Do not use the product at temperature of 80°C or higher. Contact THK if you desire to use the product at a temperature of 80°C or higher.
- (3) Please be careful when using the product in an environment with excessive coolant. The coolant may cause premature failure if it penetrates the Linear Bushing. Contact THK for further details.
- (4) If foreign material adheres to the product, replenish the lubricant after cleaning the product.
- (5) When using the product in locations exposed to constant vibrations or in special environments such as clean rooms, vacuum and low/high temperature, contact THK in advance.

[Storage]

When storing the Linear Bushing, enclose it in a package designated by THK and store it while avoiding high temperature, low temperature and high humidity.